

## MULTI-PURPOSE LID (SOFT CLOSE)

STAINLESS  
304  
STEEL

## AD-KH017-HL

- Self-leveling lid
- Soft and slow closing movement.
- For horizontal use.

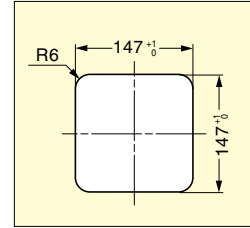
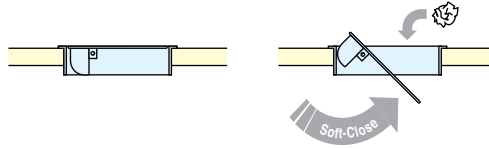

Cut Out Dimensions

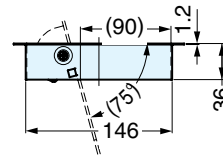
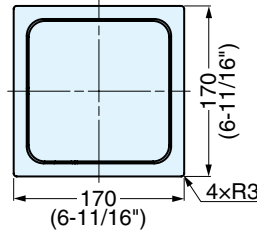

Material	Finish
304 Stainless Steel	Satin
303 Stainless Steel	
Polyacetal	
Steel	
CRC	
NBR (Rubber)	

Item No.	Weight (g)	Box (pcs)	Carton (pcs)
AD-KH017-HL	967	1	10

## MULTI-PURPOSE GROMMET

STAINLESS  
304  
STEEL

## AN-KH

- Corrosion resistant.
- Ideal for small dustbin applications.

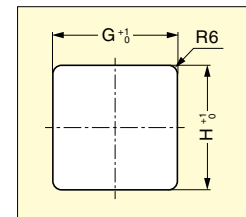
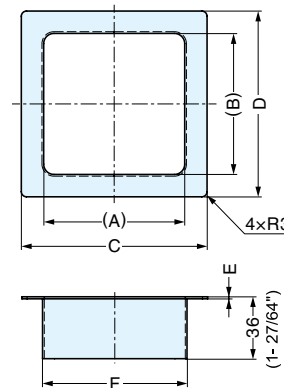

Cut Out Dimensions

Material	Finish
304 Stainless Steel	Satin

Item No.	A	B	C	D	E	F	G	H	Weight (g)	Box (pcs)	Carton (pcs)
AN-KH005-HL	56 (2-13/64")	56 (2-13/64")	82 (3-15/64")	82 (3-15/64")	1.2	58	59	59	87	1	10
AN-KH008-HL	82 (3-15/64")	82 (3-15/64")	108 (4-1/4")	108 (4-1/4")		84	85	85	126		
AN-KH015-HL	144 (5-43/64")	144 (5-43/64")	170 (6-11/16")	170 (6-11/16")		146	147	147	217		
AN-KH017											