

## RECESSED PULL

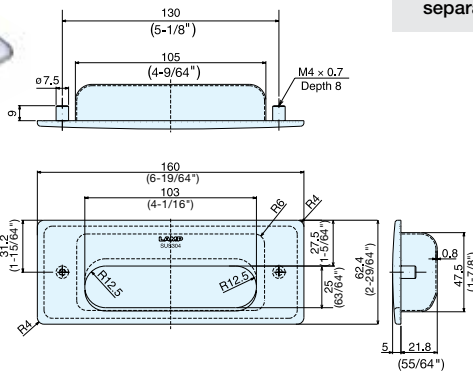

## HH-KL160



- Compliant with SEMI S8-0600 guideline.
- Spacer for sheet metal application sold separately.

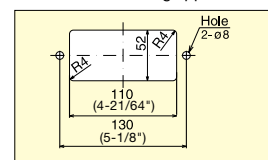
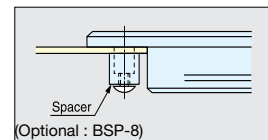

Item No.	Weight (g)	Box (pcs)	Carton (pcs)	Material	Finish
HH-KL160	260	8	48	304 Stainless Steel	Satin

## RECESSED PULL



## HH-KP150

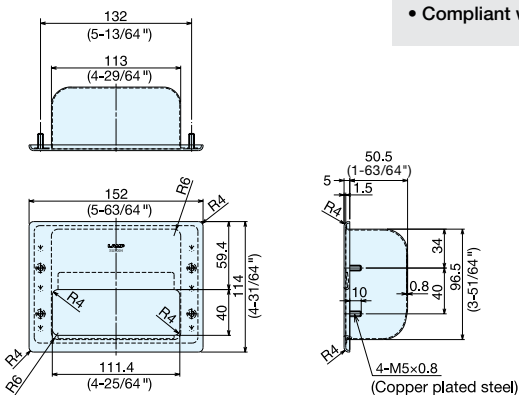

- Compliant with SEMI S8-0600 guideline.

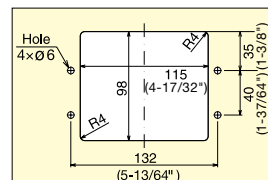

Item No.	Weight (g)	Box (pcs)	Carton (pcs)	Material	Finish
HH-KP150	390	5	50	304 Stainless Steel	Satin

## RECESSED PULL



## HH-FB, HH-FC

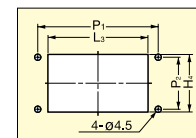
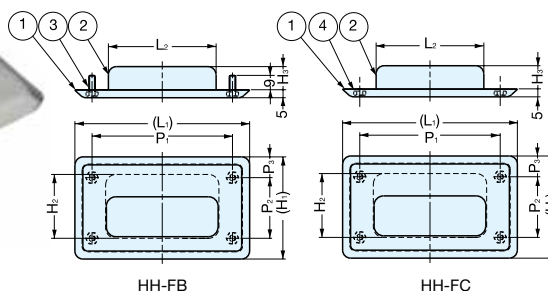

No.	Part Name	Material	Finish
①	Front Plate	304 Stainless Steel	Mirror (M)/ Satin (S)
②	Back Cover		
③	M4 Stud		
④	M4 Nut		

Item No.	Stud/Nut	(L1)	L2	L3	(H1)	H2	H3	H4	P1	P2	(P3)	Weight (g)	
HH-FB-1/M	HH-FB-1/S	M4 Stud	138.0	96	95	88	62	21.0	64	110	65	11.5	170
HH-FC-1/M	HH-FC-1/S	M4 Nut	(5-7/16")	(3-25/32")	(3-47/64")	(3-15/32")	(2-7/16")	(53/64")	(2-33/64")	(4-21/64")	(2-9/16")		
HH-FB-2/M	HH-FB-2/S	M4 Stud	109.5	71	70	64	40	14.5	42	88	38	13.0	100
HH-FC-2/M	HH-FC-2/S	M4 Nut	(4-5/16")	(2-51/64")	(2-3/4")	(2-33/64")	(1-32/64")	(37/64")	(1-21/32")	(3-15/32")	(1-1/2")		
HH-FB-3/M	HH-FB-3/S	M4 Stud	94.0	61	63	60	43	12.0	45	76	32	14.0	80
HH-FC-3/M	HH-FC-3/S	M4 Nut	(3-45/64")	(2-13/32")	(2-31/64")	(2-23/64")	(1-11/16")	(15/32")	(1-49/64")	(2-63/64")	(1-17/64")		