

RECESSED PULL (BACK MOUNT)

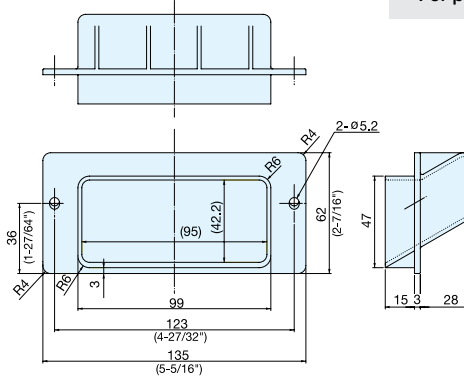

HH-PS99



- Designed for back mounting.
- For panel thickness of 15mm(19/32").

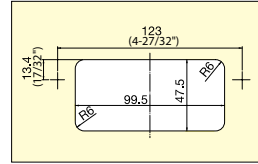

Panel Cut Out Dimensions

Item No.	Weight (g)	Carton (pcs)	Material	Color
HH-PS99	42	200	Polypropylene with Glass Fiber	Black

RECESSED PULL



HH-P



- Made with PVC material:
 - Ideal for semiconductor, manufacturing machinery and transparent applications.
 - Weather proof, chemical resistant.
- Large opening allows for easy accessibility with gloved hands.
- Environmentally friendly PVC, Lead-free.
- Compliant with SEMI S8-0308 guideline.
- Door thickness: 1 to 11mm

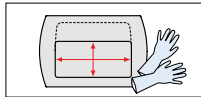

Large opening makes it easier to use with gloves

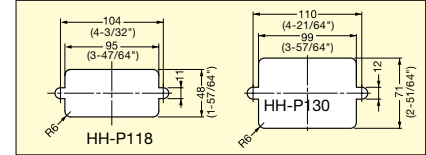
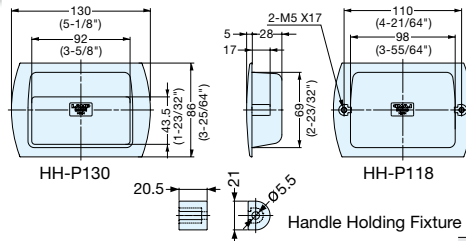

Panel Cut Out Dimensions

Material	Color	Item No.	Weight (g)	Box (pcs)	Carton (pcs)
Polyvinyl Chloride (PVC)	Clear	HH-P118	43	45	450
		HH-P130	100	30	300

RECESSED PULL



UP-600

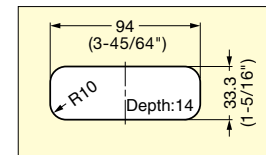
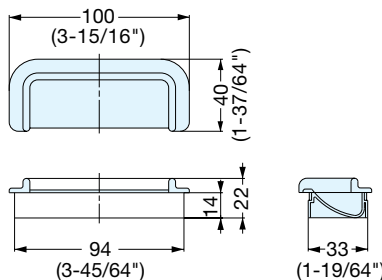

Panel Cut Out Dimensions

Item No.	Weight (g)	Box	Carton (pcs)	Material	Color
UP-600	25	50	300	ABS	Black/Chrome