

# RECESSED PULL



## XLA-HHA



- Light weight design.
- Bracket for sheet metal available.  
Item No.: XLA-HHA40B

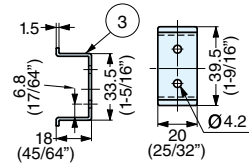
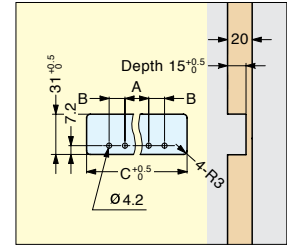
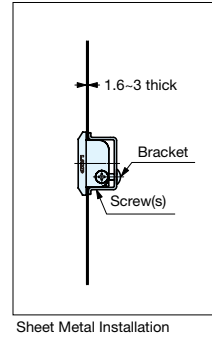
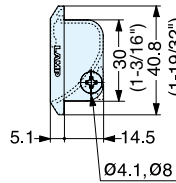
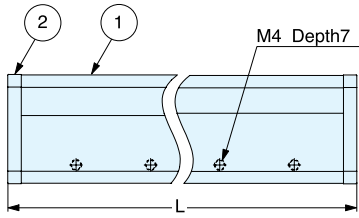

Item No.	L	Weight (g)	Box (pcs)	Carton (pcs)
XLA-HHA300	300 (11-13/16")	140	10	100
XLA-HHA600	600 ( 23-5/8" )	247	5	50
XLA-HHA40B	-	-	-	-

No.	Material	Finish
①	Aluminum	Anodized
②	Zinc Alloy	Chrome
③	430 Stainless Steel	Polished

# MEGA-RECESSED PULL (W/BAR HANDLE)



## HH-M



- Designed for industrial applications where use of thick gloves is required.
- Handlebar is recessed into cup keeping it flush and out of the way when not in use.

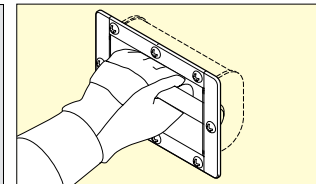
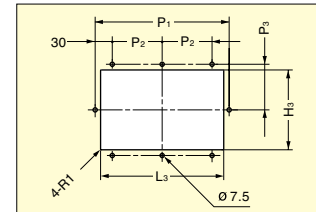
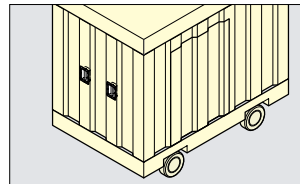
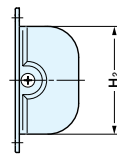
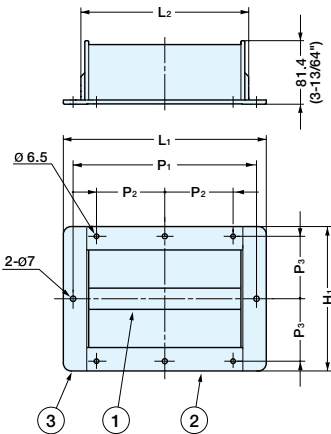

Item No.	Box(pcs)	Carton(pcs)
HH-M200	1	4
HH-M400		2

No.	Part Name	Material
①	Bar	304 Stainless Steel
②	Cup	
③	End Cover	

Item No.	L <sub>1</sub>	H <sub>1</sub>	H <sub>2</sub>	L <sub>2</sub>	P <sub>1</sub>	P <sub>2</sub>	P <sub>3</sub>	L <sub>3</sub>	H <sub>3</sub>
HH-M200	260 (10-15/64")	186.3 (7-21/64")	138.3 (5-29/64")	218 (8-37/64")	235 (9-1/4")	87.5 ( 3-7/16")	80	216 (8-1/2")	140 (5-33/64")
HH-M400	460 ( 18-7/64")			418 (16-29/64")	435 (17-1/8")	125.0 (4-59/64")		416 (16-3/8")	