

HANDLE

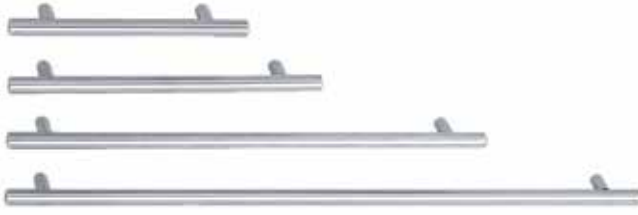

26 SERIES



• Handles 2647 through 2659 are NSF approved handles.

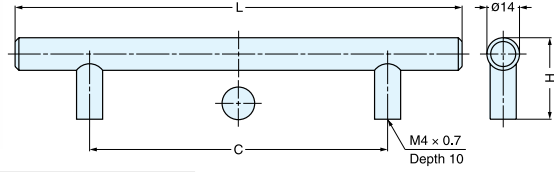

*2658 and 2659 has center post in the middle.

Item No.	L	C	H	Weight (g)	Box (pcs)	Carton (pcs)
2646	160 (6-19/64")	96 (3-25/32")	35 (1-3/8")	107	25	250
2647	192 (7-9/16")	128 (5-1/32")		113		
2650	256 (10-5/64")	192 (7-9/16")		136		
2653	406 (15-63/64")	342 (13-15/32")		187		
2655	556 (21-57/64")	492 (19-3/8")		216		
2656	656 (25-53/64")	592 (23-5/16")		324		
2658	1220 (48-1/32")	1156 (45-33/64")		547		
2659	1456 (57-21/64")	1392 (54-13/16")		570		

Material	Finish
304 Stainless Steel	Satin

HANDLE



28 SERIES

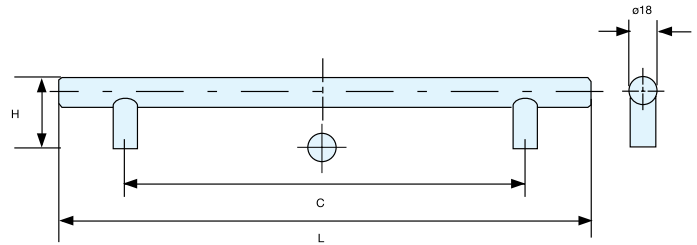

Item No.	L	C	H	Weight (g)	Box (pcs)	Carton (pcs)
28096	160 (6-19/64")	96 (3-25/32")	47 (1-27/32")	155	15	150
28128	192 (7-9/16")	128 (5-1/32")		166		
28192	256 (10-5/64")	192 (7-9/16")		190		
28342	406 (15-63/64")	342 (13-15/32")		350		
28492	556 (21-57/64")	492 (19-3/8")		322		
28592	656 (25-53/64")	592 (23-5/16")		381		
281192	1220 (48-1/32")	1192 (46-59/64")		627		
281392	1456 (57-21/64")	1392 (54-51/64")		714		

Material	Finish
304 Stainless Steel	Satin

HANDLE



70 SERIES

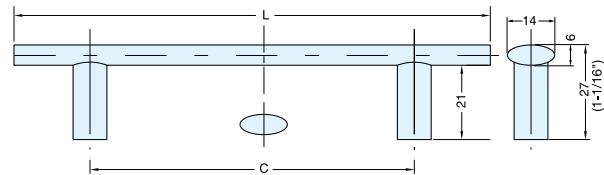

Item No.	L	C	Weight (g)	Box (pcs)	Carton (pcs)
7013	160 (6-19/64")	96 (3-25/32")	121	25	250
7014	192 (7-9/16")	128 (5-1/32")	139		
7015	224 (8-13/16")	160 (6-19/64")	157		
7016	256 (10-5/64")	192 (7-9/16")	174		
7017	288 (11-11/32")	224 (8-13/16")	192		
7018	320 (12-19/32")	256 (10-5/64")	210		
7020	384 (15-1/8")	320 (12-19/32")	246		

Material	Finish
304 Stainless Steel	Satin