

HANDLE

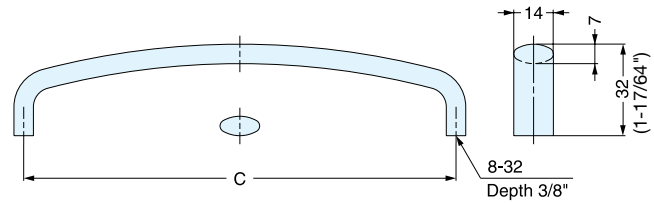

EK-R

• Ideal for harsh and highly corrosive environments.



Item No.	C	Weight (g)	Box (pcs)	Carton (pcs)	Material	Finish
EK-R635/M EK-R635/S	88.9 (3-1/2")	95	20	200	316 Stainless Steel	Mirror (M)/Satin (S)
EK-R640/M EK-R640/S	101.6 (4")	106				
EK-R650/M EK-R650/S	127.0 (5")	123				
EK-R660/M EK-R660/S	152.4 (6")	141				

HANDLE



EC-Y

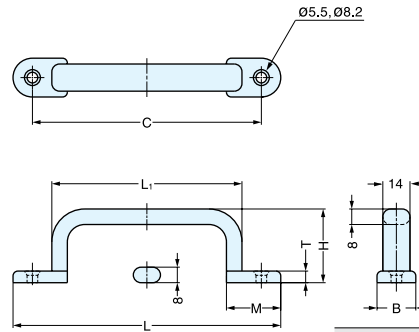

Material	Finish
303 Stainless Steel	Mirror

Item No.	L	L1	C	B	H	T	M	Weight (g)	Box (pcs)	Carton (pcs)
EC-Y-140	138	100 (3-15/16")	120 (4-23/32")	20 (51/64")	38 (1-1/2")	6	28	142	5	50
EC-Y-160	158	120 (4-23/32")	140 (5-33/64")		40 (1-37/64")			160	3	30
EC-Y-190	188	150 (5-29/32")	170 (6-11/16")		42 (1-42/64")			185	2	20

HANDLE



MG

• Ideal for harsh and high corrosive environments.
• Compliant with SEMI S8-0701 guideline.

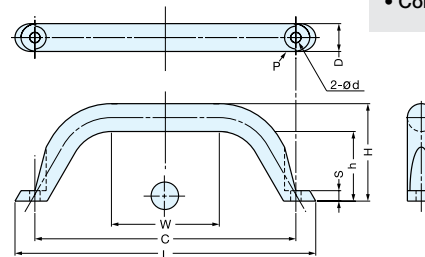

Material	Finish
316 Stainless Steel	Mirror

Item No.	D	C	L	P	W	H	h	S	ød	Weight (g)	Box (pcs)	Carton (pcs)	Recommended Screw
MG-150	16	150 (5-29/32")	172.8 (6-51/64")	R6.5	62	56 (2-13/64")	40	6	6	295	10	40	M5
MG-190	18	190 (7-31/64")	216.7 (8-17/32")	R7.5	92	63 (2-31/64")	45	8	7	460	5	25	M6
MG-250		250 (9-27/32")	275.5 (10-27/32")		145	68 (2-43/64")	595			20			
MG-230T	20	230 (9-1/16")	260.0 (10-15/64")	R9.0	129	70 (2-3/4")	50	10	9	666	5	20	M8
MG-300T		300 (11-13/16")	330.0 (12-63/64")		199					838			