

## HANDLE



SGH-200



- SGH-200 is a specially insulated handle designed to reduce shock from static electricity build-up as well as inhibit bacterial transfer.
- Textured, soft handle improves grip in manufacturing environments where lubricants are used, improving conditions when slippage is a safety concern.
- Un-obtrusive light blue color.
- Suitable for use in environments -22°F to 176°F (-30°C to 80°C).
- For use on medical, pharmaceutical, and electronic equipment; in educational, institutional, and industrial facilities where limiting transfer of static electricity or bacteria is important to operations.

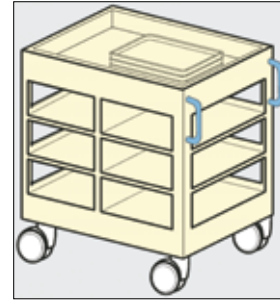
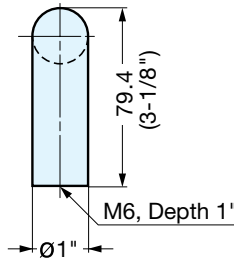
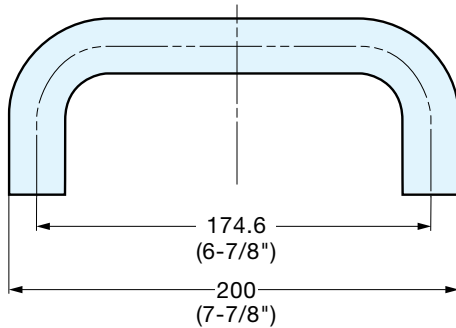

Note: Details provided for this hardware's properties/specifications are for general information only. Grounding is required to discharge electricity, and shock reduction is effective only when installed on electrically conductive surfaces. Safety of a final product or equipment is not guaranteed when used as a component. This hardware is designed to reduce – not completely eliminate – shock from static electricity. Sensitivity to shock may vary.

## Properties of Special Elastomer Coating

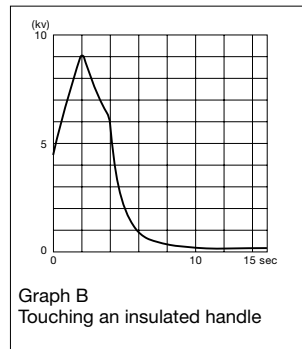
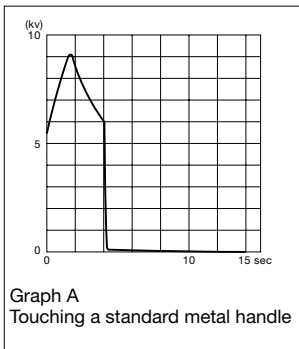

The y-axis represents the natural voltage of the human body (in kiloVolts), and the x-axis represents elapsed time (in seconds). Contact with the hardware occurs at the 4 second mark.

There is an instantaneous discharge to 0kV in Graph A, compared to a delayed discharge to 1kV over 2 seconds in Graph B. This would result in a stronger electric discharge and shock for a metal handle (Graph A) compared to the SGH-200 (Graph B).

## Pathway of Releasing Electrical Discharge

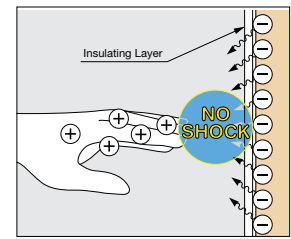
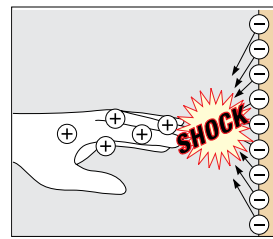

In the figures above, a human hand with a positive charge is approaching a conductive surface with a negative charge (e.g., metal). The figure on the right incorporates a layer to insulate the discharge.

Direct physical contact with a conductive surface (metal, etc.) may result in a discharge of static electricity, causing discomfort. The insulating coating of the SGH-200 acts as a buffer to reduce the rate of discharge and lessen the resulting shock (depicted above). The elastomer used for insulation incorporates a resin specially formulated for a specific conductivity.

| Item No. | Color      | Material   | Weight (g) | Box (pcs) | Carton (pcs) |
|----------|------------|--|------------|-----------|--------------|
| SGH-200  | Light Blue | Base Material: Polyamide; Coating: Special Elastomer | 250        | 20        | -            |