

## SHELF SUPPORT

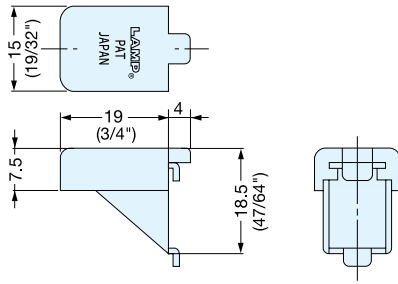

## SPB-15R



- Shelf support for SP-1820.
- Rubber pad provides a gripped surface to reduce slippage.



Item No.	Load Capacity (kg)	Weight (g)	Box (pcs)	Carton (pcs)
SPB-15R	100 (220 lbs)/4pcs	6	300	3000

Material	Finish/Color
304 Stainless Steel	Satin
Elastomer	Black

## SHELF SUPPORT



## SPB-20

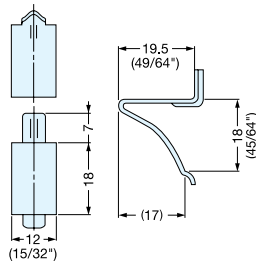

- Shelf support for SP-1820.

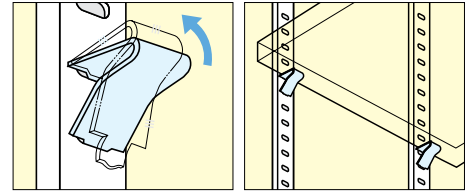

Item No.	Load Capacity (kg)	Weight (g)	Box (pcs)	Carton (pcs)
SPB-20	45 (99 lbs)/4pcs	3.6	300	3000

Material	Finish
304 Stainless Steel	Satin

## SHELF BRACKET



## SPB-200



- Telescoping shelf supports.
- Use with SP-1820 shelf standards (sold separately).
- Sold as each: use 2 supports per shelf.
- If using glass, max. Shelf width should not exceed 900 mm (35-7/16").

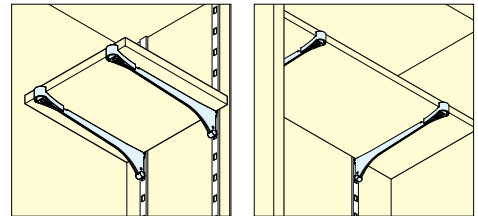
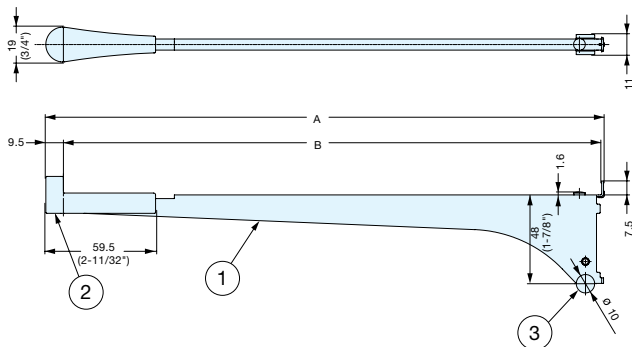

No.	Part Name	Material	Finish/Color
①	Main Body	Stainless Steel	Satin
②	Shelf Retainer Clip	Polypropylene	White
③	Base Hook		

Item No.	A (Projection)			B (Shelf Depth)			Load Capacity (kg)	Weight (g)	Box
SPB-200	193 (7-19/32")	203 (7-63/64")	213 (8-25/64")	180 (7-3/32")	190 (7-31/64")	200 (7-7/8")	10kg (22 lbs)/per pair	65	50