

# TENSION CATCH

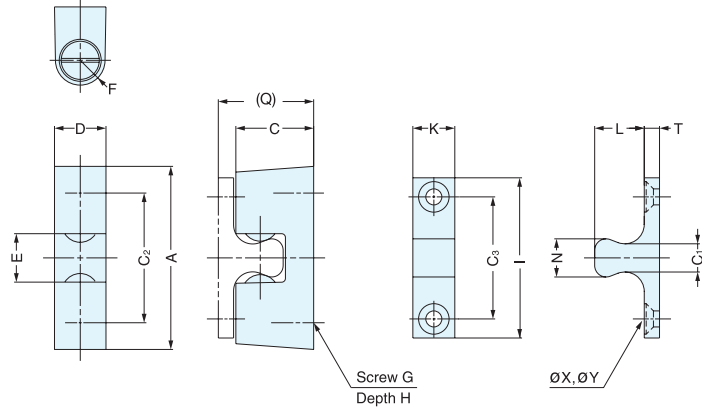

**BCU**

- Tension force is not adjustable.



Item No.	A	C	C <sub>1</sub>	C <sub>2</sub>	C <sub>3</sub>	D	E	F	G	H	I	K	L	N	(Q)	T	X	Y
BCU-40	28.5 ( 1-1/8" )	12.5	3.7	20	16	8.3 (21/64")	6.5	R4.0	M3	5	25 ( 63/64" )	7.5	8.8	5.5	15.7	3	3.2	6.4
BCU-70	48.0 (1-57/64")	20.5	7.3	34	32	13.5 (17/32")	12.7	R6.5	M5	6	42 (1-42/64")	11.0	13.0	10.0	24.9	4	4.2	8.4

Item No.	Push in Force (kg)	Pulling Force (kg)	Weight (g)	Box (pcs)	Carton (pcs)	Material	Finish
BCU-40	3.6 (7.9 lbs)	2.4 (5.3 lbs)	18	100	400	Zinc Alloy	Chrome
BCU-70	4.1 (9.0 lbs)	3.9 (8.6 lbs)	75	50	200		

# TENSION CATCH



**BCT-60W**

- Double catch for dual doors that meet in the center.
- Tension force is not adjustable.

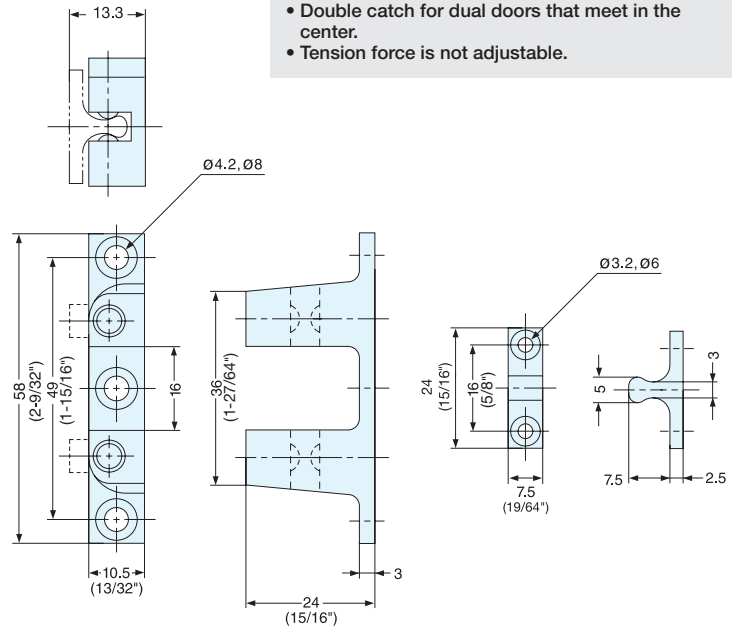

Item No.	Push in Force (kg)	Pulling Force (kg)	Weight (g)	Box (pcs)	Carton (pcs)	Material	Finish
<del>BGT-60W</del>	<del>3.2 (7 lbs)</del>	<del>2.7 (5.9 lbs)</del>	<del>39.5</del>	<del>80</del>	<del>320</del>	<del>Zinc Alloy</del>	<del>Chrome</del>

~~DISCONTINUED~~