

ULTRA THIN & STRONG MAGNETIC CATCH

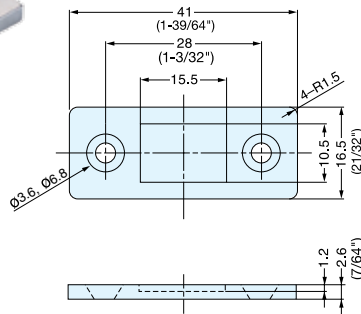

MC-158, MC-159



- Unique ultra thin magnetic catch design with extra strong magnetic force.
- Note: 1) Max. temperature: 80°C (176°F)
- 2) To avoid breakage, counterplate should not hit magnet.
- 3) Screw heads should not protrude above the base plate.
- 4) Screws not included, use M3 flat head or equivalent.
- 5) Counterplate MC-159-Plate sold separately.

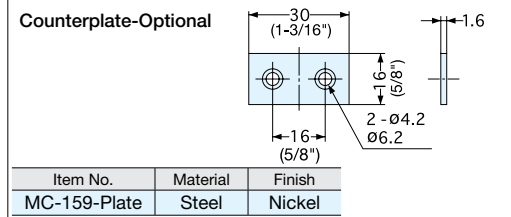

Item No.	Magnetic Force (kg)	Weight (g)	Box (pcs)	Carton (pcs)	Part Name	Material	Finish
MC-158	1.5 (3.3 lbs)	12	200	1000	Magnet	Neodymium	Nickel
MC-159	4.0 (8.8 lbs)	12	200	1000	Base/Yoke	Steel	

ULTRA THIN & STRONG MAGNETIC CATCH



MC-159-8

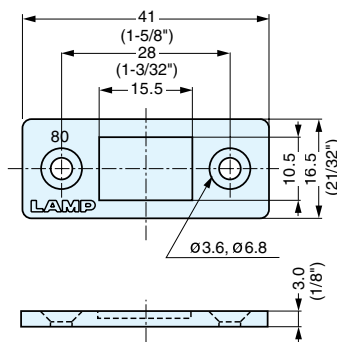

- Ultra thin magnetic catch with extra strong magnetic force.
- Note: 1) Max. temperature: 80°C (176°F).
- 2) To avoid damage, counterplate should not hit magnet.
- 3) Counterplate MC-YN001U or MC-JM49 sold separately.
- 4) Screws not included; use M3 flat head or equivalent.

Item No.	Magnetic Force (kg)	Weight (g)	Box (pcs)	Carton (pcs)	Part Name	Material	Finish
MC-159-8	8 (17.6 lbs)	14	200	1000	Body	Steel	Nickel
					Magnet	Neodymium	

ULTRA THIN STAINLESS STEEL MAGNETIC CATCH



MC-159-SUS

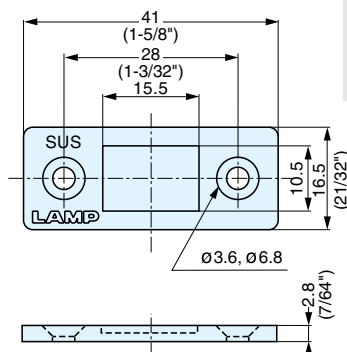

- Stainless Steel ultra thin magnetic catch with extra strong magnetic force.
- Note: 1) Max. temperature: 80°C (176°F).
- 2) To avoid damage, counterplate should not hit magnet.
- 3) Counterplate MC-YN001U or MC-JM49 sold separately.
- 4) Screws not included; use M3 flat head or equivalent.

Item No.	Magnetic Force (kg)	Weight (g)	Box (pcs)	Carton (pcs)	Part Name	Material	Finish
MC-159-SUS	5 (11.0 lbs)	13	200	1000	Body	430 Stainless Steel	Nickel
					Magnet	Neodymium	