

ADJUSTABLE SOFT-DOWN STAY



NSDX-20

LID SUPPORTS

ADJUSTABLE SOFT-DOWN STAYS



- For TOP-OPENING FLAP DOOR with piano, concealed, butt or drop hinges.
- Opening angle 70° or 105°.
- NSDX-20 is designed to hold door in fully opened position.
- Speed adjustment screw located on front for easy adjustment.
- Handed: Specific left and right hand mounting.
- Torque Calculation:
 - Torque = Door Height x 1/2 x Door Weight
 - Per Piece : 20~70 kg·cm (19~60 lbs·inch)
 - Per Pair : 40~140 kg·cm (38~120 lbs·inch)

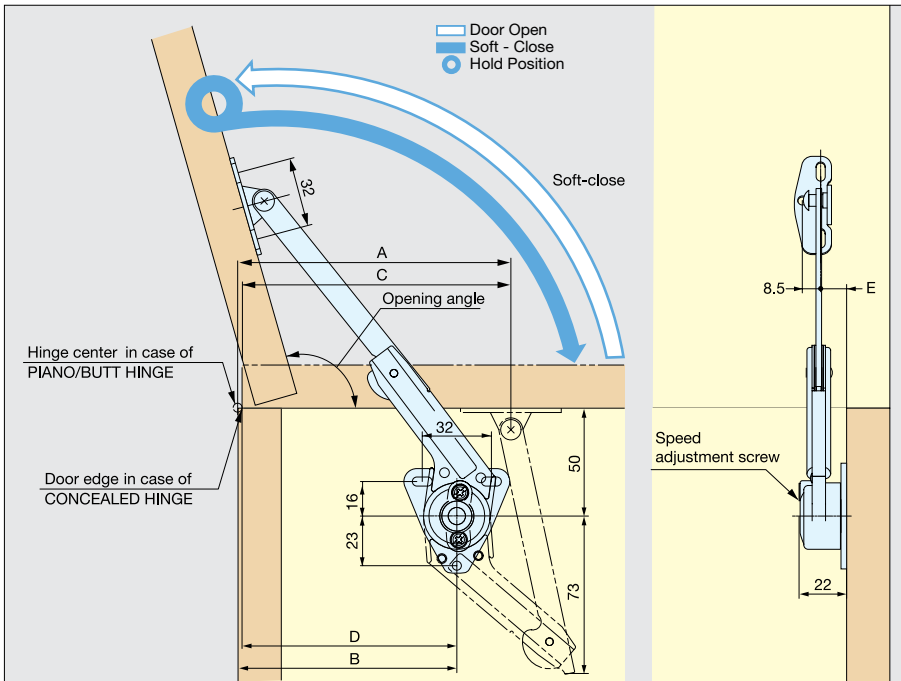

This drawing shows NSDX-20RK (Right-hand side mounting). NSDX-20LK (Left-hand) is symmetrical.

NSDX-SZ

<Standard>

Mounting Plate for wooden door, Screw type

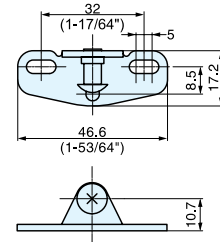

Arm Mounting Plate

70°~105° Opening

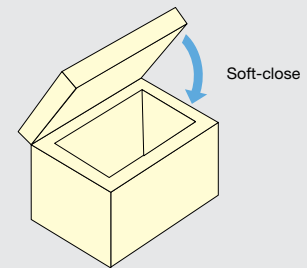

Opening Angle	Hinge Type	A	B	C	D	E
70°	Concealed Hinge	-	-	126 (4-61/64")	101 (3-31/32")	12 (15/32")
	Piano/Butt Hinge	125 (4-59/64")	100 (3-15/16")	-	-	
105°	Concealed Hinge	-	-	103 (4-1/16")	78 (3-5/64")	
	Piano/Butt Hinge	97 (3-13/16")	72 (2-53/64")	-	-	
Item No.	Weight (g)	Box (pcs)	Carton (pcs)	Material	Finish	
NSDX-20RK	Right	181	20	80	Zinc Alloy	Nickel
NSDX-20LK	Left				Steel	