

ADJUSTABLE SOFT-DOWN STAY



NSDX-10



- For DOWNWARD-OPENING FLAP DOOR with concealed, piano, butt or drop hinges.
- NSDX-10 is designed to hold door in closed position.
- Speed adjustment screw located on front for easy adjustment.
- Handed: Specific left and right hand mounting.
- Torque Calculation:
 - Torque = Door Height x 1/2 x Door Weight
 - Per Piece : 20~70 kg·cm (19~60 lbs·inch)
 - Per Pair : 40~140 kg·cm (38~120 lbs·inch)
- Short-arm version (NSDX-10(R/L)K/TV) for shorter door height available.

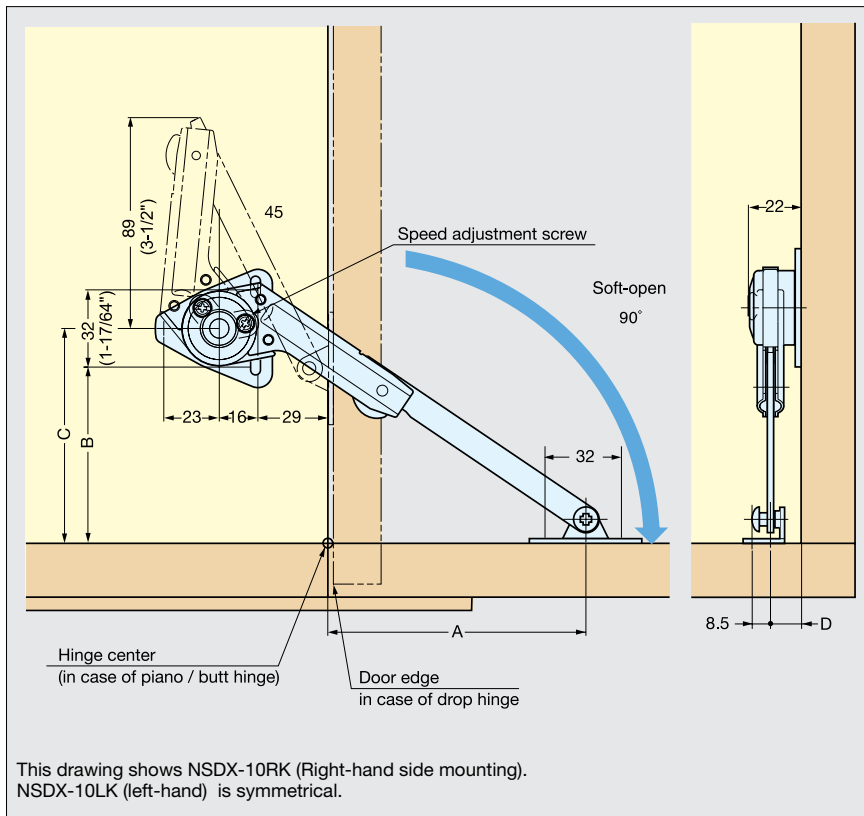

NSDX-SZ
<Standard>
Mounting Plate for wooden door, Screw type

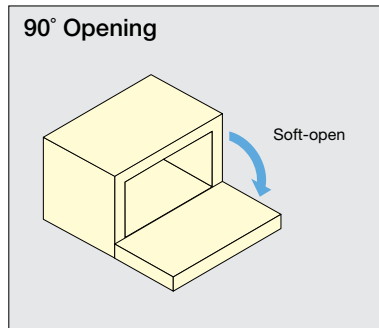
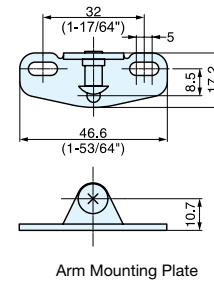

☆ In case overlay 16 mm

Hinge Type	A	B	C	D
☆ Drop Hinge (SDH-001)	97 (3-13/16")	91 (3-37/64")	107 (4-7/32")	12.8 (1/2")
Piano/Butt Hinge	90 (3-35/64")	99 (3-57/64")	115 (4-17/32")	

Item No.	Weight (g)	Box (pcs)	Carton (pcs)	Material	Finish
NSDX-10RK	181	20	80	Zinc Alloy	Nickel
NSDX-10LK				Steel	