

# EASY LIFT-UP STAY



# SLS-ELAN



- For UPWARD-OPENING FLAP DOOR with concealed, piano, butt, or drop hinges.
- Designed to provide effortless opening and hold door in closed and opened position.
- Damper equipped for soft & silent closing.
- Optional bracket for aluminum frame door available.
- Single or pair use allows wide range of door size/weights.
- Handed: Specific left and right hand mounting.

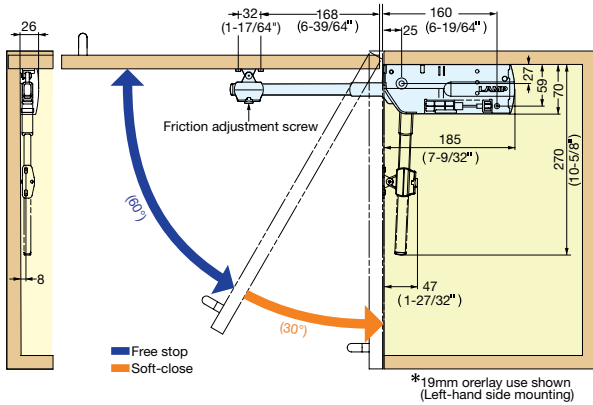
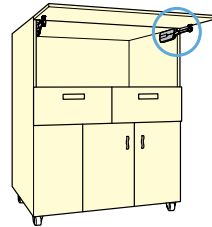

Door Weight Range Table (lbs.)

Door Height (inch)	Single use				Pair use			
	M-type		H-type		M-type		H-type	
	Min	Max	Min	Max	Min	Max	Min	Max
12"	8.0	10.8	10.8	14.5	16.0	21.7	21.7	29.0
13"	7.4	10.0	10.0	13.4	14.8	20.0	20.0	26.8
14"	6.9	9.3	9.3	12.4	13.7	18.6	18.6	24.9
15"	6.4	8.7	8.7	11.6	12.8	17.3	17.3	23.2
16"	6.0	8.1	8.1	10.9	12.0	16.3	16.3	21.8
17"	5.6	7.6	7.6	10.2	11.3	15.3	15.3	20.5
18"	5.3	7.2	7.2	9.7	10.7	14.4	14.4	19.3
19"	5.1	6.8	6.8	9.2	10.1	13.7	13.7	18.3
20"	4.8	6.5	6.5	8.7	9.6	13.0	13.0	17.4
21"	4.6	6.2	6.2	8.3	9.1	12.4	12.4	16.6
22"	4.4	5.9	5.9	7.9	8.7	11.8	11.8	15.8
23"	4.2	5.7	5.7	7.6	8.3	11.3	11.3	15.1
24"	4.0	5.4	5.4	7.3	8.0	10.8	10.8	14.5
25"	3.8	5.2	5.2	7.0	7.7	10.4	10.4	13.9
26"	3.7	5.0	5.0	6.7	7.4	10.0	10.0	13.4
27"	3.6	4.8	4.8	6.4	7.1	9.6	9.6	12.9
28"	3.4	4.6	4.6	6.2	6.9	9.3	9.3	12.4

### Easy Installation

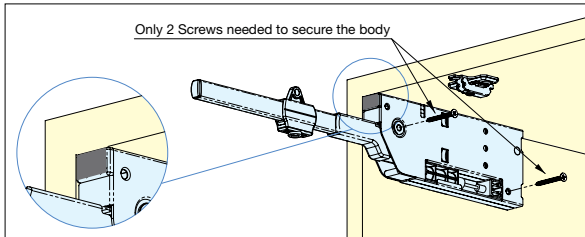

### Adjustment

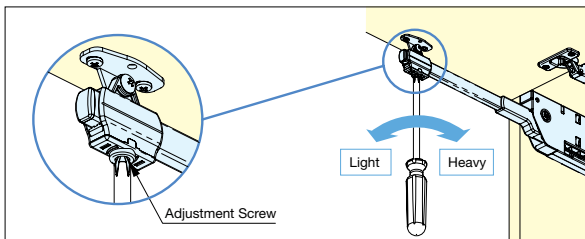

\*Single or pair use depending on door size and weight.

Item No.	Type	Torque per piece	Material	Finish/Color	Weight (g)	Box (pcs)	Carton (pcs)	
SLS-ELAN-MR	Right	55 ~ 75 kg-cm (48 ~ 65 lbs-in)	<ul style="list-style-type: none"> <li>• Aluminum</li> <li>• Steel</li> <li>• ABS</li> </ul>	<ul style="list-style-type: none"> <li>• Anodized</li> <li>• Galvanized</li> <li>• Light Grey</li> </ul>	600	20	100	
SLS-ELAN-ML	Left							M-type (Medium Duty)
SLS-ELAN-HR	Right	75 ~ 100 kg-cm (65~87 lbs-in)						H-type (Heavy Duty)
SLS-ELAN-HL	Left							