

RECESSED FINGER PULL



3511, 3512 SERIES

- Ideal for sliding doors.
- Affix with glue or tack.



3511038/SN



3511400/CR



3512038/SN



3512400/CR

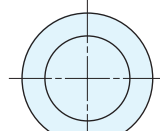

3511 SERIES

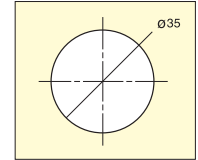
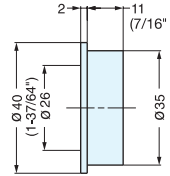

Bore Dimensions

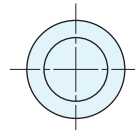

3512 SERIES

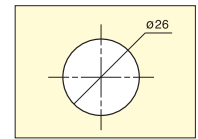
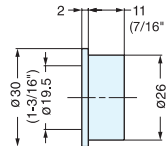

Bore Dimensions

Item No.	Weight (g)	Box (pcs)	Carton (pcs)
3511038/SN	27.1	25	250
3511400/CR			
3512038/SN	17.2		
3512400/CR			

Material	Finish
Zinc Alloy	Satin Nickel (SN)/Chrome (CR)

RECESSED PULL



3922 SERIES

- Ideal for sliding doors.
- Affix with glue or tack.



3922038/SN



3922400/CR

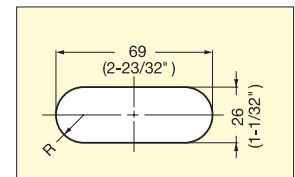
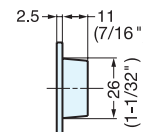
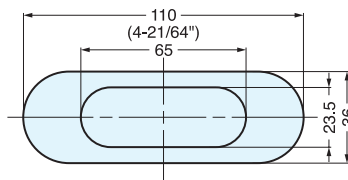
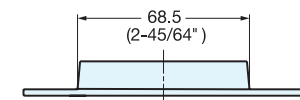

Bore Dimensions

Item No.	Weight (g)	Box (pcs)	Carton (pcs)
3922038/SN	70.9	25	250
3922400/CR			

Material	Finish
Zinc Alloy	Satin Nickel (SN)/Chrome (CR)