

MULTI-PURPOSE LID (SOFT CLOSE)

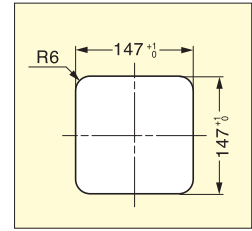

AD-KH015-HL

- Self-leveling lid
- Soft and slow closing movement.
- For horizontal use.

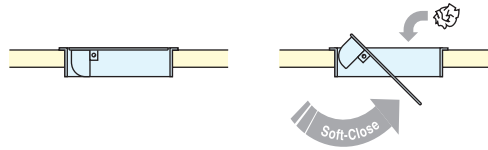

Cut Out Dimensions

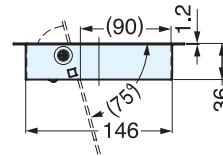
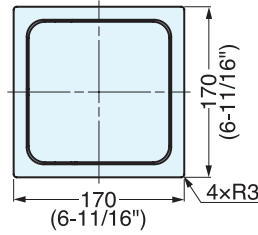

Material	Finish
304 Stainless Steel	Satin
303 Stainless Steel	
Polyacetal	
Steel	
CRC	
NBR (Rubber)	

Item No.	Old Item No.	Weight (g)	Box (pcs)	Carton (pcs)
AD-KH015-HL	AD-KH017-HL	967	1	10

MULTI-PURPOSE GROMMET



AN-KH

- Corrosion resistant.
- Ideal for small dustbin applications.

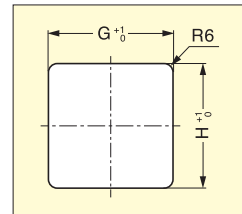
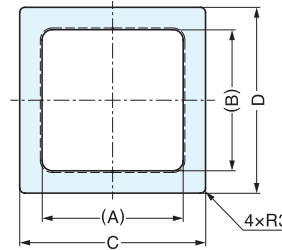

Cut Out Dimensions

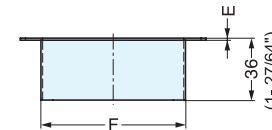

Material	Finish
304 Stainless Steel	Satin

Item No.	Old Item No.	A	B	C	D	E	F	G	H	Weight (g)	Box (pcs)	Carton (pcs)
AN-KH005-HL	-	56 (2-13/64")	56 (2-13/64")	82 (3-15/64")	82 (3-15/64")	1.2	58	59	59	87	1	150
AN-KH008-HL	AN-KH001	82 (3-15/64")	82 (3-15/64")	108 (4-1/4")	108 (4-1/4")		84	85	85	126		10
AN-KH015-HL	AN-KH017	144 (5-43/64")	144 (5-43/64")	170 (6-11/16")	170 (6-11/16")		146	147	147	217		