

MULTI-PURPOSE LID (W/DAMPER)



AD-KH

MISCELLANEOUS

MULTI-PURPOSE LID (SOFT CLOSE) / MULTI-PURPOSE GROMMET

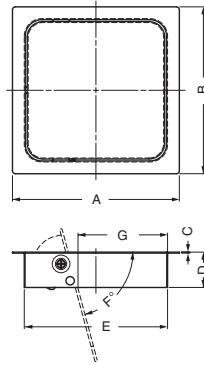

- Features damper to keep lid from slamming shut.
- Made of stainless steel for corrosion resistance.
- Wide opening.
- Balance weight restores lid to horizontal position.
- Operating temperature: 32°F~104°F.

6-11/16" (170 mm)



AD-KH015-HL

8-11/16" (220 mm)



AD-KH020-HL

11-13/16" (300 mm)

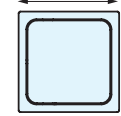

AD-KH028-HL

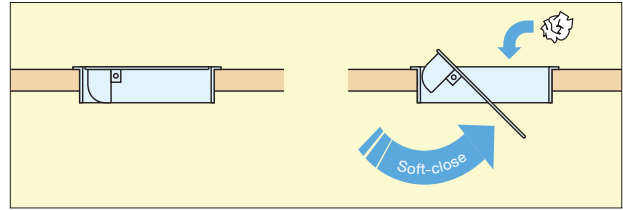
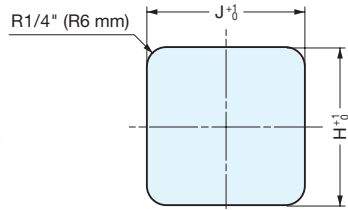

Item No.	Material	Finish	A	B	C	D	E	F	G	H	J	Weight (g)
AD-KH015-HL	304 Stainless Steel	Satin	6-11/16" (170 mm)	6-11/16" (170 mm)	1/16" (1.2 mm)	1-7/16" (36 mm)	5-3/4" (146 mm)	80°	3-11/16" (93 mm)	5-13/16" (147 mm)	5-13/16" (147 mm)	970
AD-KH020-HL			8-11/16" (220 mm)	8-11/16" (220 mm)	1/16" (1.2 mm)	2" (50 mm)	7-3/4" (196 mm)	77°	5" (127 mm)	7-3/4" (197 mm)	7-3/4" (197 mm)	1400
AD-KH028-HL			11-13/16" (300 mm)	11-13/16" (300 mm)	1/16" (1.2 mm)	2-13/16" (72 mm)	10-7/8" (276 mm)	80°	7-1/2" (191 mm)	10-15/16" (277 mm)	10-15/16" (277 mm)	2700