

# VENTILATOR

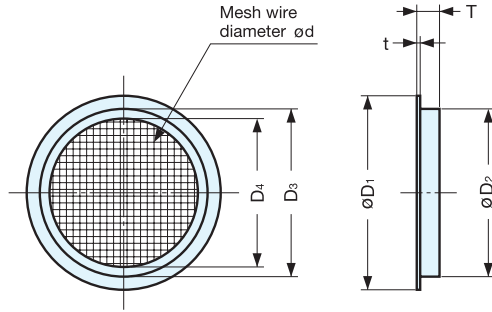

**SAM**



- 0.4 mm mesh wire diameter.
- Affix with glue.

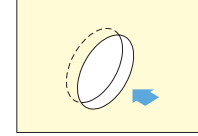

Installation

Material	Finish
304 Stainless Steel	Satin

Item No.	D <sub>1</sub>	D <sub>2</sub>	D <sub>3</sub>	D <sub>4</sub>	T	t	d	Weight (g)	Box (pcs)	Carton (pcs)
SAM- 37	36 ( 1-27/64" )	31.5 ( 1-1/4" )	30.0	25	5.2	0.3	0.4	4.5	70	1400
SAM- 45	46 ( 1-13/16" )	41.5 ( 1-41/64" )	40.0	35	5.2			6.0	60	1200
SAM- 60	60 ( 2-23/64" )	53.5 ( 2-7/64" )	52.0	46	6.5			9.5	50	1000
SAM- 85	85 ( 3-11/32" )	77.8 ( 3-1/16" )	76.5	68	7.0			16.5	30	600
SAM- 120	120 ( 4-23/32" )	110.5 ( 4-23/64" )	108.0	99	7.2	0.5		46.5	20	200

# VENTILATOR



**SAD**

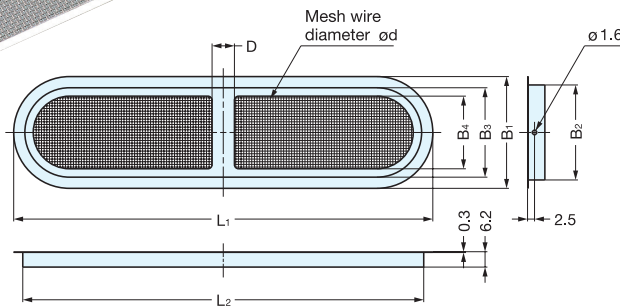
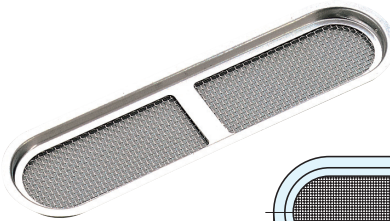

- 0.4 mm mesh wire diameter.
- Affix with glue or tack.

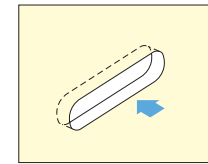

Installation

Material	Finish
304 Stainless Steel	Satin

Item No.	L <sub>1</sub>	B <sub>1</sub>	B <sub>3</sub>	B <sub>4</sub>	L <sub>2</sub>	B <sub>2</sub>	D	d	Weight (g)	Box (pcs)	Carton (pcs)
SAD-150	150.0 ( 5-29/32" )	40 ( 1-37/64" )	32	26	143.5	34	8	0.4	18.5	30	600
SAD-200	200.0 ( 7-7/8" )	50 ( 1-31/32" )	42	35	194.0	44	10		30.0		300

# VENTILATOR



**ASM**

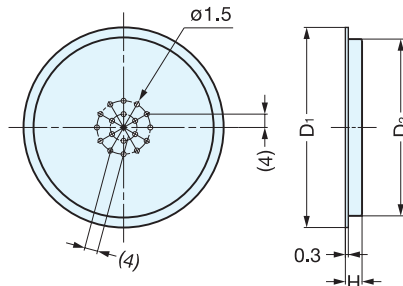

- 1.5 mm (1/16") diameter holes.
- Affix with glue.

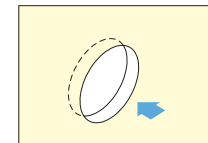

Installation

Material	Finish
304 Stainless Steel	Satin

Item No.	D <sub>1</sub>	D <sub>2</sub>	H	Holes	Weight (g)	Box (pcs)	Carton (pcs)
ASM-37	36 ( 1-27/64" )	31 ( 1-7/32" )	4.5	37	3.0	100	3600
ASM-45	46 ( 1-13/16" )	41 ( 1-39/64" )		59	5.0		
ASM-60	60 ( 2-23/64" )	53 ( 2-3/32" )	5	127	8.0		
ASM-85	85 ( 3-11/32" )	77 ( 3-1/32" )		271	13.5	50	1000