

INTERCHANGEABLE CYLINDER & KEY

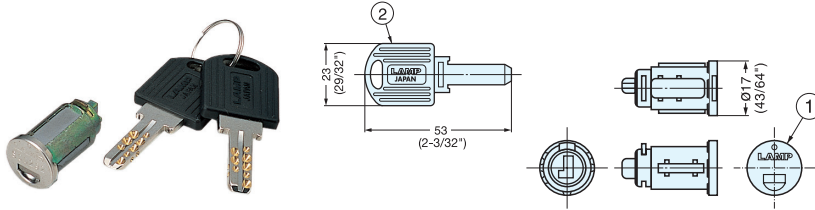

MD-N1



- Cylinder and key set for 1830, 6830 and 1330GL locks.
- Interchangeable feature allows easy cylinder replacement in case key is lost.
- Up to 7,800 key changes available. (750 key changes per master key.)
- Keyed Alike (KA) or Keyed Different (KD) available. Please specify when ordering.

Item No.	Component	Weight (g)	Box (pcs)	Carton (pcs)	Component	Material	Finish
MD-N1	Cylinder	21	12	60	Cylinder	304 Stainless Steel/Zinc Alloy	Polished/Yellow Zinc Chromate
	Key	12			Key	Brass/ABS	Nickel/Black

INTERCHANGEABLE CYLINDER KEY



MD-MK1, K1



- MD-MK1 - Master key for easy key management.
- MD-K1 - Key to remove existing cylinder only. Does NOT open lock.

Item No.	Key Type	Weight (g)	Box (pcs)	Carton (pcs)	Material	Finish/Color
MD-MK1	Master Key	12	1	10	Brass/ABS	Nickel/Black
MD-K1	Change Key					

CABINET LOCK (HOUSING)



6830-30MK

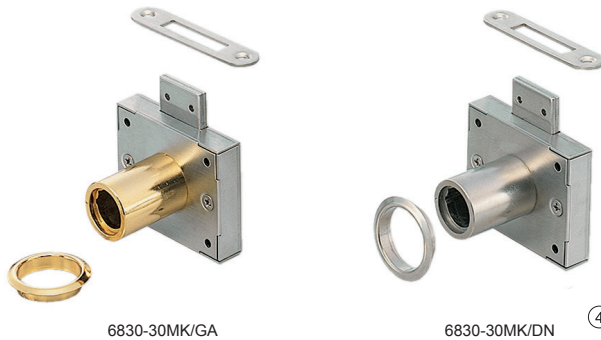

- Cylinder lock with stainless steel body.
- Interchangeable Cylinder Lock
- Cylinder can be changed by using change key MD-K1. Easy to replace cylinder in case key is lost.
- Up to 7,800 key changes available. (750 key changes per master key.)
- Cylinder housing Diameter: 22 mm (7/8")
- 2 mm (5/64") plastic distance plate 6810-SP available for various door thickness. See P.581
- * Cylinder housing only. Interchangeable Cylinder MD-N1 must be ordered for a complete assembly.

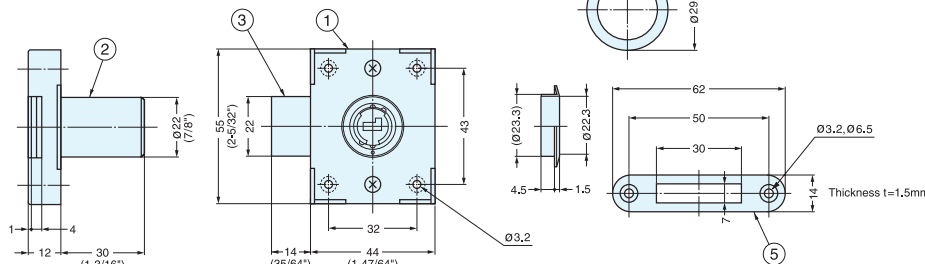

Master Key, Interchangeable Cylinder & Key are sold separately. See P.619

Item No.	Door Thickness	Finish	Weight (g)	Box (pcs)	Carton (pcs)
6830-30MK/GA	30 (1-3/16")	Gold/Clear	180	12	60
6830-30MK/DN	30 (1-3/16")	Nickel			

No.	Part Name	Material	Finish
①	Body	304 Stainless Steel	Satin
②	Cylinder Housing	Zinc Alloy	Satin Nickel (DN)/Gold (GA)
③	Dead Bolt	304 Stainless Steel	-
④	Ring	Brass	Satin Nickel (DN)/Gold (GA)
⑤	Counterplate	304 Stainless Steel	Satin