

# HIGH DURABILITY SPRING HINGE

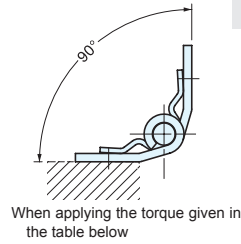

# HG-SHL

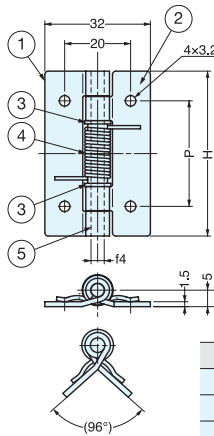

- Spring loaded to keep doors shut.
- Stainless steel suitable for corrosive environments.
- High durability; Passed 1,000,000 open/close private cycle tests.

No.	Part Name	Material	Finish/Color
①	Body	304 Stainless Steel	Polished
②	Body 2	304 Stainless Steel	Polished
③	Collar	303 Stainless Steel	-
④	Spring	304 Stainless Steel	-
⑤	Shaft	303 Stainless Steel	-

Item No.	H	P	Load Capacity (kg)	Torque (kgf/cm)	Weight	Box (pcs)	Carton (pcs)
HG-SHL32	32 (1-1/4")	18 (11/16")	4 (8.8 lbs)	0.48 (0.42 lbs/in)	20	50	500
HG-SHL50	50 ( 2" )	32 ( 1-1/4" )	6 (13 lbs)	0.91 (0.79 lbs/in)	30		
HG-SHL60	60 (2-3/8")	40 (1-9/16")		1.43 (1.24 lbs/in)	38		

# BUTT HINGE (W/SPRING)



# HG-SH

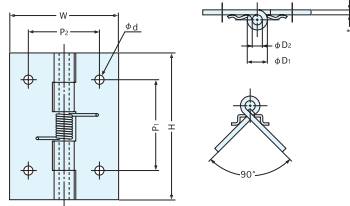
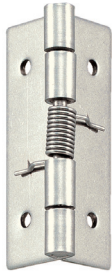

- Designed to close with spring tension when hinge is surface mounted.
- HG-SH20C has no screw holes.

Material	Finish
304 Stainless Steel	Plain

Item No.	H	W	P <sub>1</sub>	P <sub>2</sub>	D <sub>1</sub>	D <sub>2</sub>	d	t	Torsion Spring Force (kg·cm)	Weight (g)	Box (pcs)	Carton (pcs)
HG-SH20C	20 ( 25/32" )	14 ( 35/64" )	-	-	2.2	1	-	0.5	0.99 (0.86 lbs·in)	11.5	800	3200
HG-SH25C	25 ( 63/64" )	32 ( 1-17/64" )	14	20	5.8	3	3.2	1.2	0.66 (0.57 lbs·in)	10.0	300	1200
HG-SH38C	38 ( 1-1/2" )		26		6.5				1.50 ( 1.3 lbs·in )	20.0	200	800
HG-SH51C	51 ( 2-1/64" )	38 ( 1-1/2" )	32	25	6.5	-	-	1.38 (1.19 lbs·in)	35.0	130	520	

# BUTT HINGE (W/SPRING)



# SH

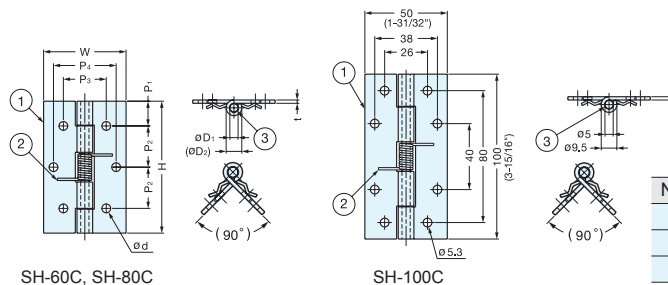
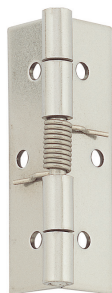

- Designed to close with spring tension when hinge is surface mounted.

No.	Part Name	Material	Finish
①	Body	304 Stainless Steel	Polished
②	Spring		-
③	Hinge Pin		-

Item No.	H	W	t	P <sub>1</sub>	P <sub>2</sub>	P <sub>3</sub>	P <sub>4</sub>	D <sub>1</sub>	(D <sub>2</sub> )	d	Weight (g)	Box (pcs)	Carton (pcs)
SH-60C	60 ( 2-23/64" )	40 ( 1-37/64" )	1.5	10	20	26	26	5	8.5	4.3	44	120	1200
SH-80C	80 ( 3-5/32" )	50 ( 1-31/32" )	2.0	15	25		86		80	800			
SH-100C	100 ( 3-15/16" )	50 ( 1-31/32" )	2.0	-	-	-	38	-	9.5	5.3	110	100	1000