

## LIFT-OFF HINGE (WELD-ON)

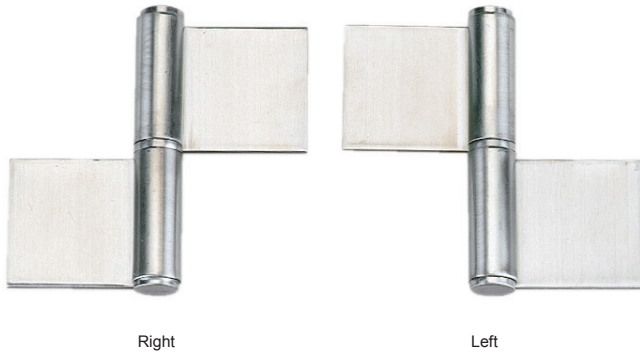

**S-6166-2**



- Weld-on type stainless steel lift-off hinge.
- Left and Right handed available.
- Door weight: Max. 40 kg/pair (88 lbs/pair)

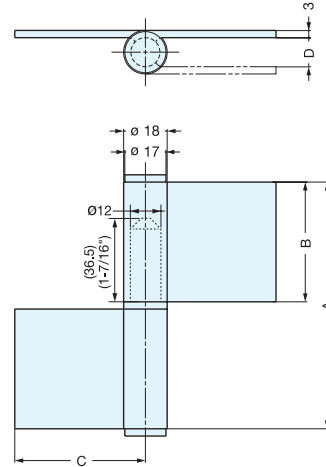

Material	Finish
304 Stainless Steel	Satin

Item No.		A	B	C	D	Weight (g)	Box (pcs)	Carton (pcs)
Left	Right							
S-6166-2-L	S-6166-2-R	102 (4-1/64")	49.5 (1-61/64")	55 (2-5/32")	12 (15/32")	300	12	60

## LIFT-OFF HINGE (WELD-ON)



**S-6166-6**

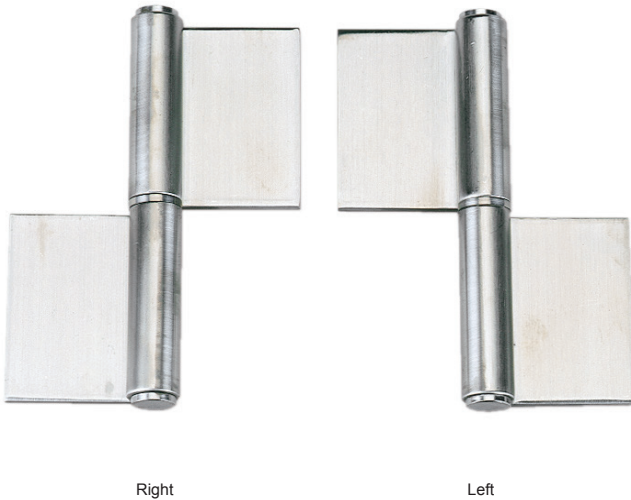

- Weld-on type stainless steel lift-off hinge.
- Left and Right handed available.
- Door weight: Max. 90 kg/pair (198 lbs/pair)

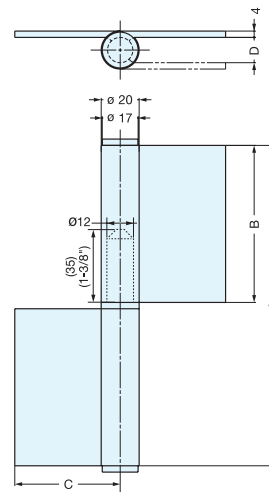

Material	Finish
304 Stainless Steel	Satin

Item No.		A	B	C	D	Weight (g)	Box (pcs)	Carton (pcs)
Left	Right							
S-6166-6-L	S-6166-6-R	152 (5-63/64")	74.5 (2-15/16")	55 (2-5/32")	12 (15/32")	570	8	40