

LAMP® XL-GC09-CR Magnetic Catch – Installation instructions

Thank you for purchasing the XL-GC09-CR Magnetic Catch. In order to insure the best possible installation, we recommend that you read the following instructions closely. Standard warranty is 1 year from shipment time. Sugatsune responsibility is limited to the replacement of a defective part and will in no way extend to the full assembly.

Specifications

- The XL-GC09 magnetic catch can be used with either a glass or wooden top cabinet:
 - Glass cabinet top: when using a hinge other than the XL-GC04, ensure that distance ※2 shown in the drawing below is respected.
 - Wooden cabinet top: use of the top cover is not necessary. It is also possible to use an inset hinge other than XL-GC04.
- Glass thickness: 5, 6 and 8 mm.
- Magnetic force of the catch is 14.7N (1.5kgf). There may be slight magnetic force difference between one magnet and another.
- Please use tempered glass and ask a professional for the glass cutout.

XL-GC09-CR Parts List

- Catch Body: 1
- Top cover: 1
- Strike Plate: 1
- Spacer: 2
- Strike plate packing : 2
- Installation screw : M4x12: 1

Installation drawing

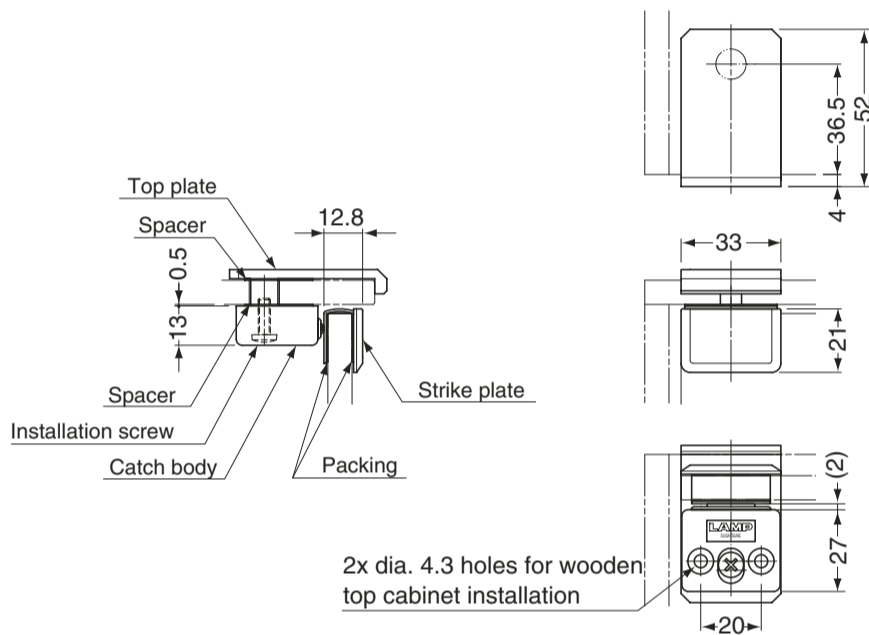

Strike plate installation

For 5 and 6mm glass

(use 2 strike plate packings)

- ① Cut the central, narrower part of only one of the strike plate packing

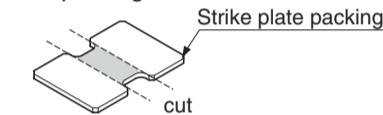

- ② Remove tape cover and affix each half the cut packing on either side of the glass as per below dimensions.

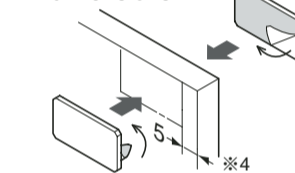

- ③ Remove tape cover and affix the remaining uncut packing on top of the first packing as shown below.

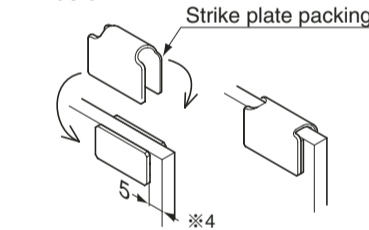

※4 Distance necessary in order for the side of the strike plate to line up properly with the side of the door.

For 8mm glass

(use 2 strike plate packing)

- ① Remove tape cover and affix the strike plate packing as per dimensions below.

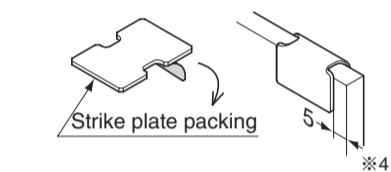

Strike plate

Line up the side of the strike plate with the edge of the door and push into place.

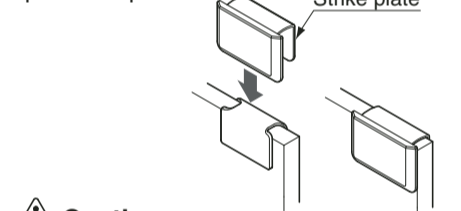

Caution

Ensure that the top of the strike plate does not overlap more than 2.5mm from the top of the door.

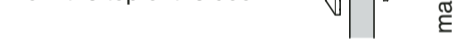

Installation for glass cabinet top

Right hand opening installation shown. Left hand opening installation is symmetrically opposite.

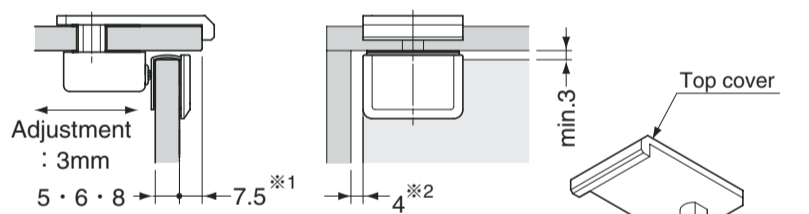

Single door installation

Double door installation

(right hand shown)

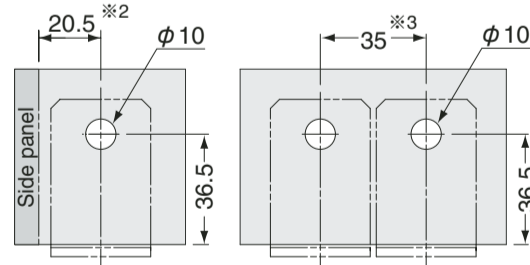

Insert through the center hole and tighten after adjusting the position of the catch body

- ※1 When using an inset hinge other than XL-GC04, ensure that the backset is 7.5mm.
- ※2 Dimension when using XL-GC04 hinge (not included).
- ※3 Dimension when using XL-GC01 lock set (not included).

Installation for wooden cabinet top

Right hand opening installation shown. Left hand opening installation is symmetrically opposite.

※5 Adjust the catch body position depending on the closed door position.

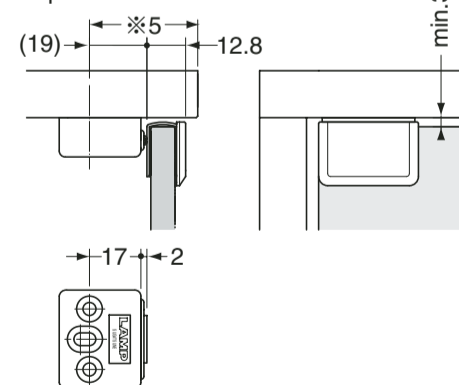

wooden cabinet top

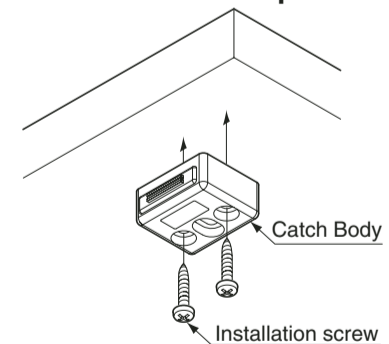

Use both side holes to secure the body catch. Size 4 screws (not included) are necessary

SUGATSUNE KOGYO CO.,LTD.
Phone: +81 3 3866 2260
F a x : +81 3 3866 4447
E-mail: export@sugatsune.co.jp
Website: www.sugatsune-intl.com

SUGATSUNE KOGYO (UK) LTD.
Phone: +44 118 9272 955
F a x : +44 118 9272 871
E-mail: sales@sugatsune.co.uk
Website: www.sugatsune.co.uk

SUGATSUNE AMERICA, INC.
Phone: +1 310 329 6373
F a x : +1 310 329 0819
E-mail: sales@sugatsune.com
Website: www.sugatsune.com

SUGATSUNE SHANGHAI CO., LTD.
Phone: +86 21 3632 1858
F a x : +86 21 3632 1868
E-mail: lamp@sugatsune.com.cn
Website: www.sugatsune.com.cn