

# RECESSED PULL

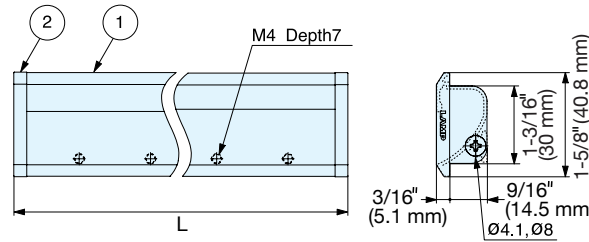

# XLA-HHA

HANDLES, PULLS & KNOBS



- Lightweight design.
- Bracket for sheet metal available. Item No.: XLA-HHA40B (sold separately)

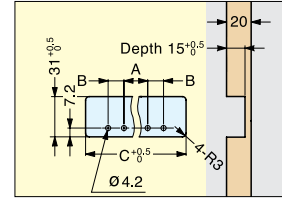

No.	Material	Finish
①	Aluminum	Anodized
②	Zinc Alloy	Chrome

Item No.	L	A	B	C	Weight (g)	Box (pcs)	Carton (pcs)
XLA-HHA300	11-13/16" (300 mm)	3-15/16" (100 mm)	2" (50 mm)	11-5/8" (296 mm)	140	10	100
XLA-HHA600	23-5/8" (600 mm)	7-7/8" (200 mm)	5-15/16" (150 mm)	23-7/16" (596 mm)	247	5	50

# RECESSED PULL (BACK MOUNT)



# HH-PS99



- Designed for back mount.
- Large grip space for heavy Cabinets etc.
- For panel thickness 9/16" (15 mm).

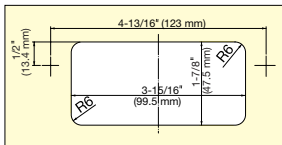

Bore Dimensions

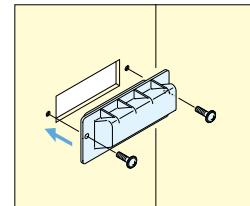
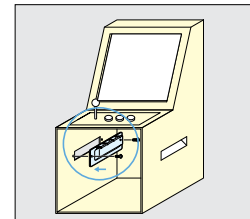
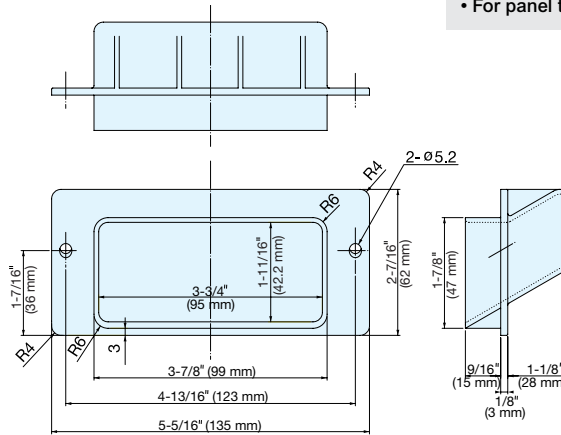

Item No.	Weight (g)	Box (pcs)	Carton (pcs)	Material	Color
HH-PS99	42	50	200	Polypropylene with Glass Fiber	Black

# RECESSED PULL

# UP-600

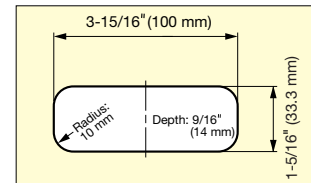
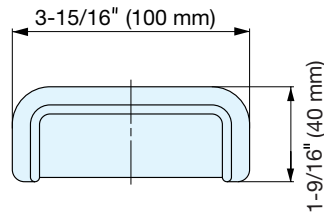

Cut out Dimensions

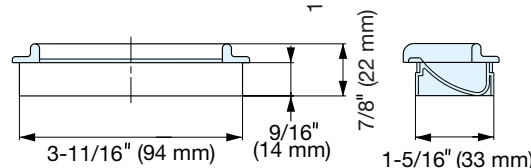

Item No.	Weight (g)	Box	Carton (pcs)	Material	Color
UP-600	25	50	300	ABS	Black, Chrome