

# RECESSED PULL (W/VENTILATOR)



UTA-105

HANDLES, PULLS & KNOBS

RECESSED PULLS (W/VENTILATOR)

- Easy to grip.
- Ventilating area is invisible from the front.
- Excellent chemical resistance.

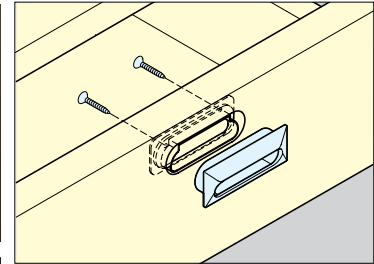

Installation

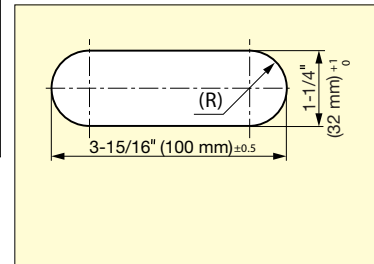

Panel Cut Out Dimensions

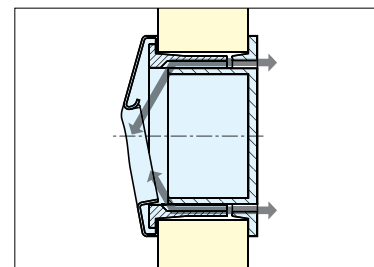
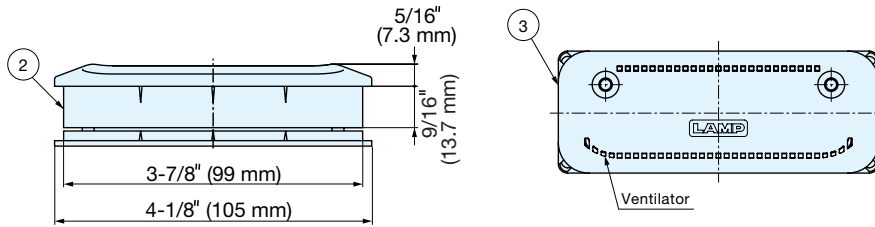
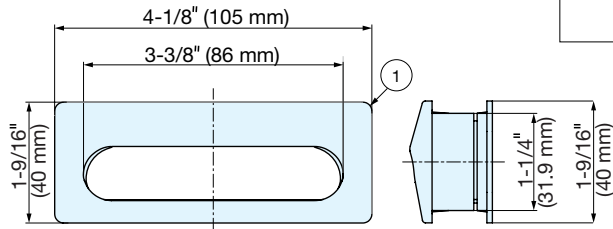

Air Circulation

Item No.	Panel Thickness	Weight (g)	Box (pcs)	Carton (pcs)	No.	Material	Finish
UTA-105BL	11/16" ~ 1" (18 ~ 25 mm)	40	15	150	①	304 Stainless Steel	Satin
UTA-105GR					②	ABS	Black (BL)/Grey (GR)/Ivory (IV)
UTA-105IV					③		

# RECESSED PULL



UT

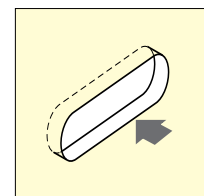
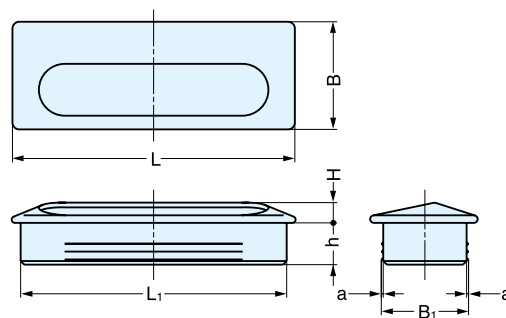

Installation

Item No.	L	L <sub>1</sub>	H	h	B	B <sub>1</sub>	a	Weight (g)	Box (pcs)	Carton (pcs)
UT- 75/S	2-15/16" (75 mm)	2-13/16" (71 mm)	1/4" (7 mm)	5/8" (15.5 mm)	1-7/16" (36 mm)	1-3/16" (30.8 mm)	1/16" (0.4 mm)	15	40	400
UT-105/S-1	4-1/8" (105 mm)	3-7/8" (99 mm)	5/16" (7.5 mm)	5/8" (15.5 mm)	1-9/16" (40 mm)	1-1/4" (32.5 mm)	1/16" (0.5 mm)	30	25	250
UT-140/S	5-1/2" (140 mm)	5-1/4" (134 mm)	5/16" (7.5 mm)	5/8" (15.5 mm)	1-7/8" (47 mm)	1-9/16" (40.5 mm)	1/16" (0.5 mm)	45	15	150

Material	Finish/Color
304 Stainless Steel	Satin (S)
Plastic	Black