

# PUSH KNOB LATCH



## TLP-S

CATCHES & LATCHES

PUSH KNOB LATCHES

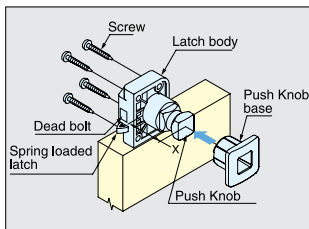

- Knob is stored flush when pushed in and not in use.
- Knob pops out when pressed to open the door.
- Latch securely locks the door with deadbolt.
- Door Thickness: 3/4" ~ 1-3/16" (19 mm ~ 30 mm).
- Holding Force: 44 lbs (20 kg)
- Non-Handed: Can be installed on left or right side.
- Order Latch Body (TLP-LBM/WHT) and Push Knob (TLP-S-BB/XX) for complete set.



TLP-S-BB/CR    TLP-S-BB/G    TLP-S-BB/SN    TLP-LBM/WHT

Threaded Screw	Door Thickness	Dimensions X
L = 24	3/4" (19 mm)	1-19/32" (40.5 mm)
	25/32" (20 mm)	1-5/8" (41.5 mm)
	53/64" (21 mm)	1-43/64" (42.5 mm)
	7/8" (22 mm)	1-23/32" (43.5 mm)
	29/32" (23 mm)	1-3/4" (44.5 mm)
L = 30	15/16" (24 mm)	1-51/64" (45.5 mm)
	63/64" (25 mm)	1-53/64" (46.5 mm)
	1-1/32" (26 mm)	1-7/8" (47.5 mm)
	1-1/16" (27 mm)	1-29/32" (48.5 mm)
	1-3/32" (28 mm)	1-61/64" (49.5 mm)
L = 30	1-9/64" (29 mm)	1-63/64" (50.5 mm)
	1-3/16" (30 mm)	2-1/32" (51.5 mm)

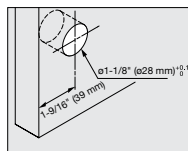

Bore Dimensions

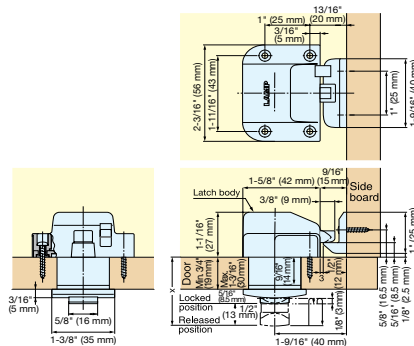

Part Name	Material	Finish	
		Knob	Latch
Latch Body	Polyamide	Chrome (CR)	
Push Button	Brass	Satin Nickel (SN)	White
Push Button Base	Zinc Alloy	Gold (G)	

Item No.	Part Name	Holding Force
TLP-S-BB/CR	Push Knob and Base	44 lbs (20 kg)
TLP-S-BB/SN		
TLP-S-BB/G		
TLP-LBM/WHT		

# PUSH KNOB LATCH



## DPL-RO



DPL-RO-G



DPL-RO-CR



Latch Body

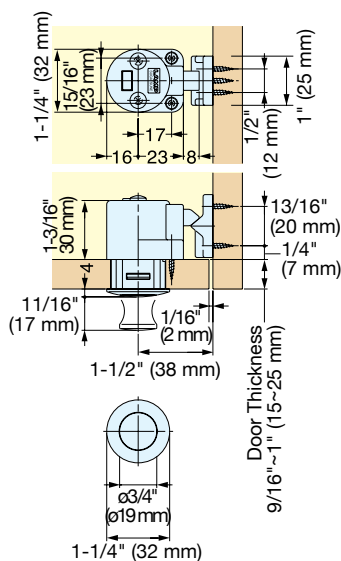

Door Thickness  
9/16" ~ 1" (15~25 mm)

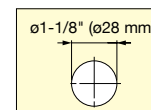
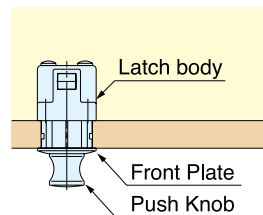

Bore Dimensions

- Knob and latch combined:
  - Knob is flush when pushed in and not in use.
  - Knob pops out when pressed to open the door.
  - Door will be locked when knob is pushed in.
- Door Thickness: 9/16" ~ 1" (15 mm ~ 25 mm).
- Holding Force: 22 lbs (10 kg)
- Non-Handed: Can be installed on left or right side.
- Other ring shape available.
  - Oval: DPL-OV
  - Square: DPL-SQ

Item No.	Finish	Holding Force	Weight (g)	Box (pcs)	Carton (pcs)
DPL-RO-G	Gold	22 lbs (10 kg)	72	10	80
DPL-RO-CR	Chrome				

Part Name	Material
Push Knob	Zinc Alloy
Front Plate	
Latch Body	ABS
Counterplate	