

ANGLE BRACKET

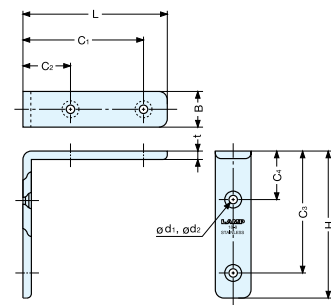

SU



• Stainless steel bracket with soft and sleek design.

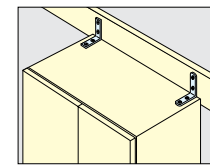

Installation

Material	Finish
304 Stainless Steel	Mirror (M), Satin (S)

Item No.	L	H	C ₁	C ₂	C ₃	C ₄	B	t	d ₁	d ₂	Holes	Load Capacity	Weight (g)	Box (pcs)	Carton (pcs)	Screw
SU-30/M	SU-30/S	1-3/16" (30)	1-3/16" (30)	15/16" (24)	7/16" (11)	15/16" (24)	7/16" (11)	1/2" (12)	1/8" (2.5)	1/4" (6.5)	4	13 lbs (6 kg)	11	60	960	3.1 × 20
SU-45/M	SU-45/S	1-3/4" (45)	1-3/4" (45)	1-7/16" (37)	11/16" (17)	1-7/16" (37)	11/16" (17)	1/2" (13)	1/8" (3)	1/4" (6.5)		11 lbs (5 kg)	23	50	800	
SU-60/M	SU-60/S	2-3/8" (60)	2-3/8" (60)	2" (50)	13/16" (20)	2" (50)	13/16" (20)	9/16" (15)	3/16" (4.0)	5/16" (7.5)		9 lbs (4 kg)	36	40	640	

() units in mm.

ANGLE BRACKET



SU-A

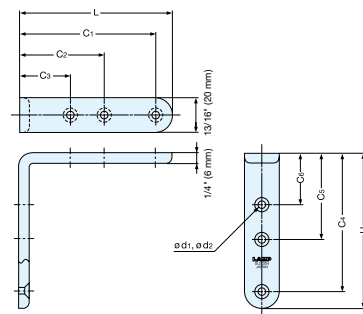

• Stainless steel angle bracket for applications where corrosion is an issue.

Material	Finish
304 Stainless Steel	Mirror

Item No.	L	H	C ₁	C ₂	C ₃	C ₄	C ₅	C ₆	d ₁	d ₂	Holes	Load Capacity	Weight (g)	Box (pcs)	Carton (pcs)
SU-A70/M	2-3/4" (70)	2-3/4" (70)	-	2-3/8" (60)	1-3/16" (30)	-	2-3/8" (60)	1-3/16" (30)	3/16" (4.2)	5/16" (8.2)	4	52 lbs (24 kg)	107	10	100
SU-A90/M	3-9/16" (90)	3-9/16" (90)	3-1/8" (80)	2" (50)		3-1/8" (80)	2" (50)								
SU-A120/M	4-3/4" (120)	4-3/4" (120)	4-5/16" (110)	2-3/8" (60)	4-5/16" (110)	2-3/8" (60)									
SU-A150/M	5-15/16" (150)	5-15/16" (150)	5-1/2" (140)	2-3/8" (60)	5-1/2" (140)	2-3/8" (60)									

() units in mm.

ANGLE BRACKET



SU-B

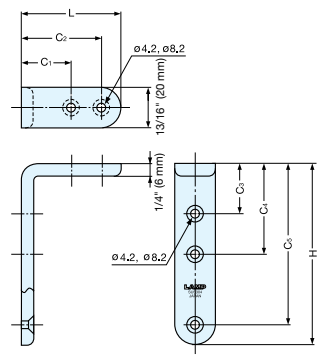

• Stainless steel angle bracket for applications where corrosion is an issue.

Material	Finish
304 Stainless Steel	Mirror

Item No.	L	H	C ₁	C ₂	C ₃	C ₄	C ₅	Holes	Load Capacity	Weight (g)	Box (pcs)	Carton (pcs)
SU-B50/M	2" (50)	3-9/16" (90)	1" (25)	1-9/16" (40)	1" (25)	1-3/4" (45)	3-1/8" (80)	5	28 lbs (13 kg)	106	10	100
SU-B65/M	2-9/16" (65)	4-3/4" (120)	1-3/16" (30)	2-3/16" (55)	1-3/16" (30)	2-3/8" (60)	4-5/16" (110)		145			
SU-B80/M	3-1/8" (80)	5-15/16" (150)	1-3/16" (30)	2-3/4" (70)	1-3/16" (30)	2-3/8" (60)	5-1/2" (140)	5	22 lbs (10 kg)	186	8	80

() units in mm.