

# VERTICAL SWING LIFT UP MECHANISM



SLUL

LID SUPPORTS

SWING LIFT UP MECHANISM



- For taller, heavier upward-opening doors.
- Soft closes to prevent slamming.
- The spring gently lifts the door after pulling it forward 4-3/4" ~ 5-15/16" (120 ~ 150 mm).
- Adjustable lift-assist feature refine's the opening force to best match your door's size and weight.
- Adjustments are easily accessible making maintenance simple.
- 3-Way adjustability:  
Vertical +/- 1/4" (6 mm)  
Horizontal +/- 1/8" (2.5 mm)  
Tilt +/- 5°

Body

Body Cover (Sold separately)



Application Example



Image of Movement

How to Open	Movement Features	Door Material	Door Weight
	<b>OPEN</b> Lift Assist	Wood	11~24.2 lbs (5~11 kg) Per 1 set
	<b>CLOSE</b> Soft-Close		

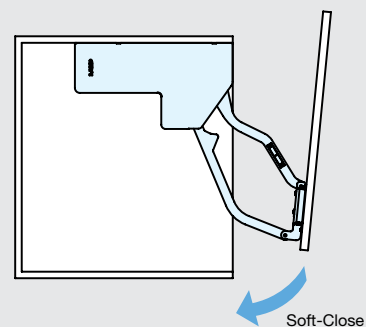
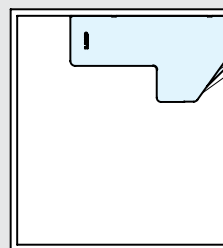
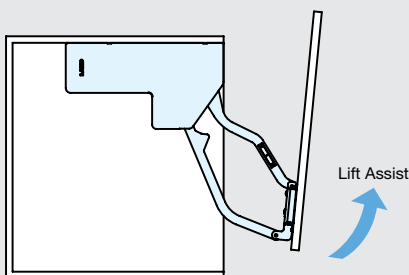

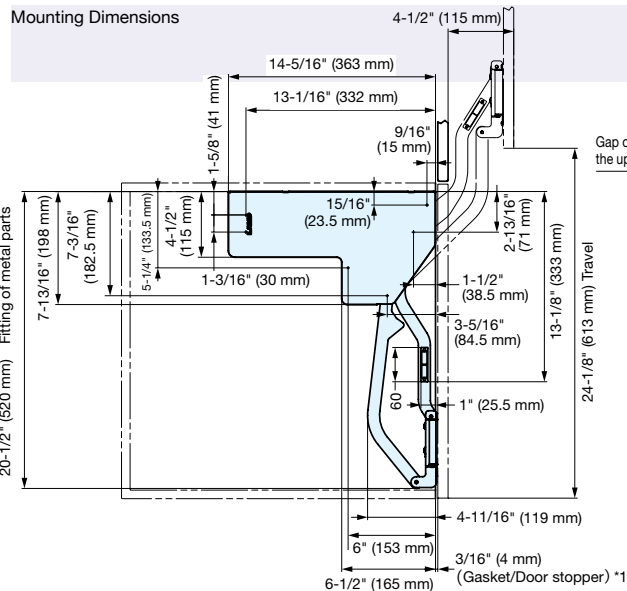

- \*1: If not using a gasket/door stopper, please shift the body 3/16" (4 mm) towards the back panel.
- \*2: The maximum door protrusion when opening and closing is approximately 13-1/2" (343 mm).
- \*3: Total travel of door is 24-1/8" (613 mm).

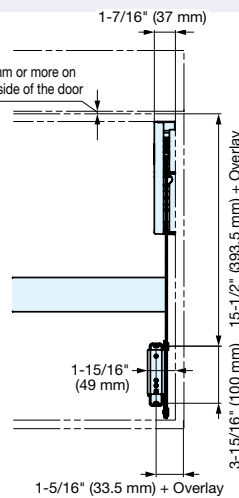

Body Cover (Sold separately)

Maximum Projection

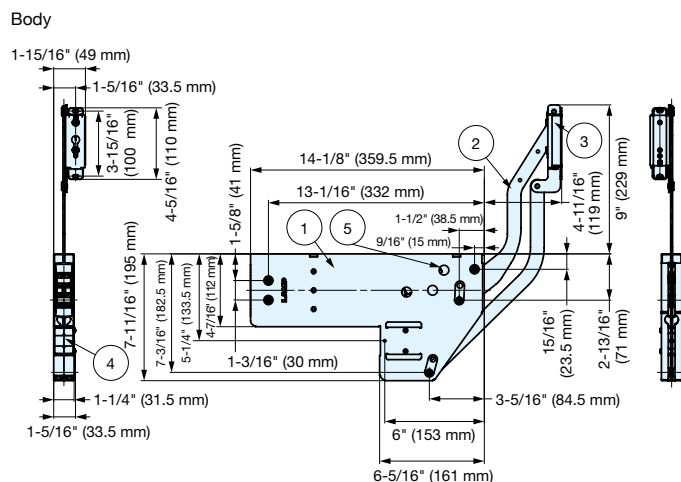
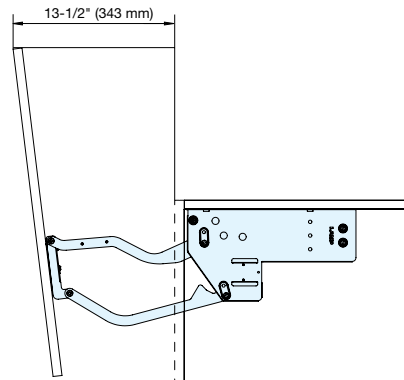

Connecting Bar (Sold separately)

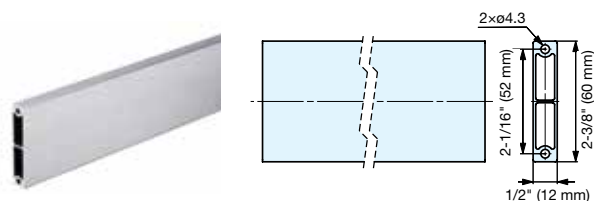

**How to Order**

- 1) Select a body.
- 2) Select a body cover.
- 3) Select a Connecting Bar.

- The Connecting Bar comes in three lengths, for door widths of 23-5/8" (600 mm), 29-1/2" (750 mm), and 35-7/16" (900 mm).
- Use the standard length Connecting Bar when the door overlay on the side panel is 9/16" (15 mm). For door overlays exceeding 9/16" (15 mm), cut the Connecting Bar to length using the calculation formula provided below.

Length of the Connecting Bar = Door width - (Overlay x 2) - 1-3/8" (35 mm)  
 Or, please calculate as follows below.  
 Length of the Connecting Bar = Cabinet internal width - 1-3/8" (35 mm)

Body Cover (Sold Separately)

Item No.	Material	Color
SLUL-C-WT	ABS	White
SLUL-C-DGR		Dark Grey

This product is sold as 1 set. The order quantity is "1", which includes one piece of the left and right.

Body

Item No.	Material	Finish	Door Width	Door Height	Door Weight
SLUL-8	Steel	Nickel	Max. 35-7/16" (900 mm)	21-5/8" ~ 35-7/16" (550 ~ 900 mm)	11 ~ 17.6 lbs (5 ~ 8 kg)
SLUL-11					17.6 ~ 24.2 lbs (8 ~ 11 kg)

This product is sold as 1 set. The order quantity is "1", which includes one piece of the left and right.

Connecting Bar (Sold separately)

Item No.	Door Width	Material	Finish	Bar Length
SLUL-B535	23-5/8" (600 mm)	Aluminum Alloy	Anodized	21-1/16" (535 mm)
SLUL-B685	29-1/2" (750 mm)			27" (685 mm)
SLUL-B835	35-7/16" (900 mm)			32-7/8" (835 mm)