

# PUSH LATCH

TEST 11  
P.697

M3x14  
STEEL

# SL-B

CATCHES & LATCHES

PUSH LATCHES / PUSH KNOB LATCHES



SL-B-211/BRN

SL-B-211/IVY

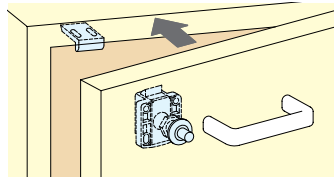

Handles are required to open the door. (Not included)

- Unique push latch
- Pull the handle while pushing the button to open door.
- Handle sold separately.

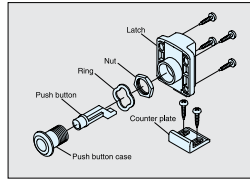
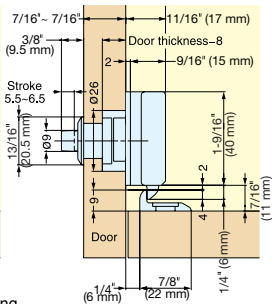
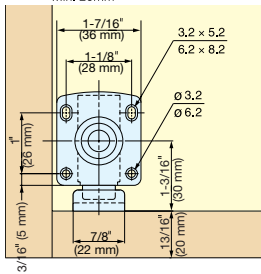
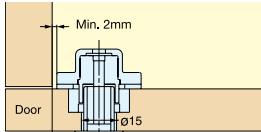

Detailed View

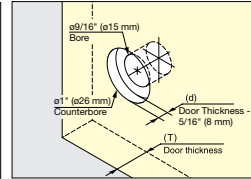

Bore Dimensions

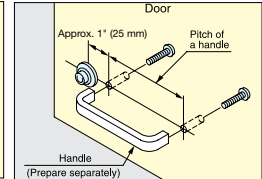

Handle position

Item No.	Spacer Required	(T) Door Thickness	(d) Depth of Recess Hole
SL-B-211	○	45/64" (18 mm)	25/64" (10 mm)
	×	3/4" (19 mm)	7/16" (11 mm)
SL-B-251	○	25/32" (20 mm)	15/32" (12 mm)
	×	53/64" (21 mm)	33/64" (13 mm)
	○	7/8" (22 mm)	35/64" (14 mm)
	○	29/32" (23 mm)	19/32" (15 mm)
	×	15/16" (24 mm)	5/8" (16 mm)
		63/64" (25 mm)	43/64" (17 mm)

Please specify the finish when ordering.

Item No.	Holding Force	Weight (g)	Box (pcs)	Carton (pcs)
SL-B-211	35 lbs (16 kg)	32.5	20	200
SL-B-251				

Part Name	Material	Finish	Application
Body, Latch	Polyamide	Brown(BRN) Ivory(IVY)	RV and marine
Push Button	Polyacetal		
Counterplate	Polyacetal		
Nut, Washer	Steel	-	

# PUSH KNOB LATCH

TEST 11  
P.697

3.1x10  
3.1x28  
STEEL

# PKL-07



PKL-07/WHT  
PKL-S/WHT

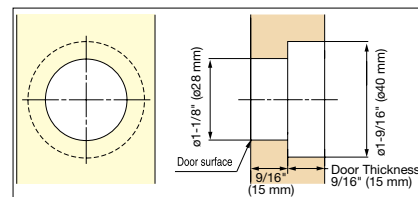
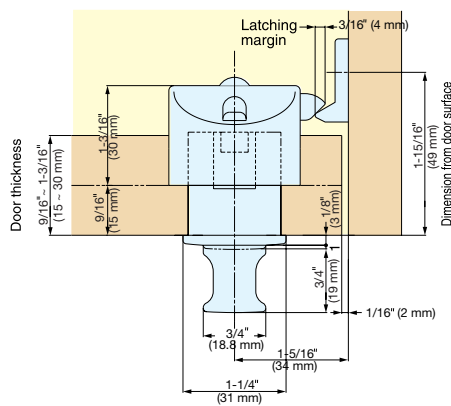

- Knob is stored flush when pushed in and not in use.
- Knob pops out when pressed to open the door.
- Latch securely locks the door with deadbolt.
- Door Thickness: 9/16"~ 1-3/16" (15 mm~30 mm), for doors 1/2" (13 mm) thick, use a 1/16" (2 mm) plastic spacer (sold separately).
- Holding Force: 10 kg (22 lbs)
- Non-Handed: Can be installed on left or right side.
- Note: to avoid damage to the unit, do not activate the latch before closing the door.
- Order latch body (PKL-S/xxx) and push knob (PKL-07/xxx) for a complete set.



PKL-S/BLK

PKL-S/WHT

Please specify latch body color when ordering. Available in white (WHT) or black (BLK). Latch body and push knob sold separately.

Item No.	Part Name	Holding Force	Weight (g)	Box (pcs)	Carton (pcs)
PKL-07/WHT	Push Knob	22 lbs (10 kg)	30	20	200
PKL-S/WHT	Latch Body		2		
PKL-S/BLK					

Material	Color
ABS	White (WHT), Black (BLK)