

COMPRESSION DRAW LATCH

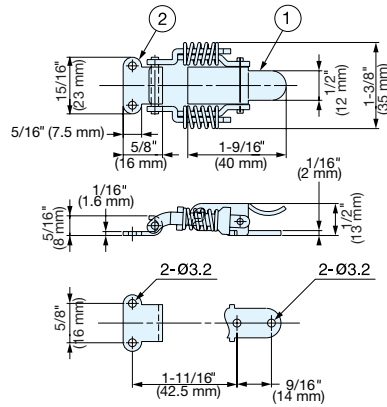

SCCA-40



- Spring loaded design compensates for tolerance and vibrations.
- Provides constant hold tension for secure latching.

*Dimensions shown are for clamping force of "0".

Item No.	Weight (g)	Box (pcs)	Carton (pcs)
SCCA-40	38	100	400

No.	Part Name	Material	Finish
①	Body	Steel	Yellow Zinc Chromate
②	Counterplate		

COMPRESSION DRAW LATCH



SCCA-60

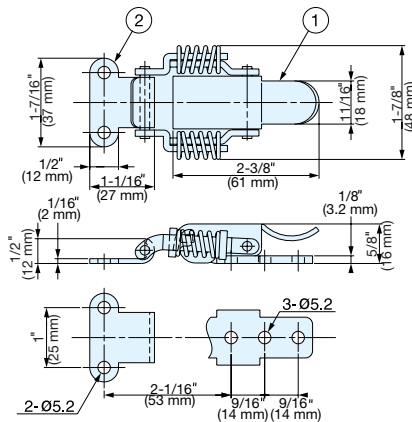

- Spring loaded design compensates for tolerance and vibrations.
- Provides constant hold tension for secure latching.

*Dimensions shown are for clamping force of "0".

Item No.	Weight (g)	Box (pcs)	Carton (pcs)
SCCA-60	102	100	400

No.	Part Name	Material	Finish
①	Body	Steel	Yellow Zinc Chromate
②	Counterplate		

DRAW LATCH



PS



PS30A

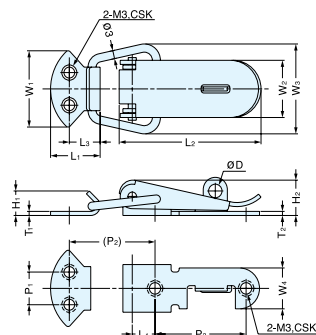

- PS31A and PS30A designed for use with a padlock (not included).

Material	Finish
304 Stainless Steel	Polished

Item No.	øD	Load Capacity	Weight (g)	Box (pcs)	Carton (pcs)
PS31A	5.0	22 lbs (10 kg)	19	100	500
PS30A	5.5	33 lbs (15 kg)	35		400
PS31	-	22 lbs (10 kg)	19		500
PS30	-	33 lbs (15 kg)	38		400

Item No.	Pad Lock Hole	L ₁	L ₂	L ₃	L ₄	W ₁	W ₂	W ₃	W ₄	H ₁	H ₂	T ₁	T ₂	P ₁	(P ₂)	P ₃
PS31A	With Hole	16	1-9/16" (40)	10.0	8.0	15/16" (23)	16	1" (26)	13	9	3/8" (9.5)	1.2	1.0	10	1-3/16" (30)	15/16" (23)
PS30A	With Hole	18	2-1/16" (53)	11.5	8.5	1-1/8" (28)	21	1-1/4" (32)	15	10	1/2" (13.0)	1.5	1.5	12	1-5/16" (33)	1-5/16" (34)
PS31	Without Hole	19	1-1/2" (38)	11.0	7.0	15/16" (24)	16	1" (26)	13	8	3/8" (9.5)	1.2	1.0	10	1-3/16" (30)	15/16" (23)
PS30	Without Hole	18	2-1/16" (53)	11.5	8.5	1-1/8" (28)	21	1-1/4" (32)	15	10	1/2" (13.0)	1.5	1.5	12	1-5/16" (33)	1-5/16" (34)