

VENTILATOR

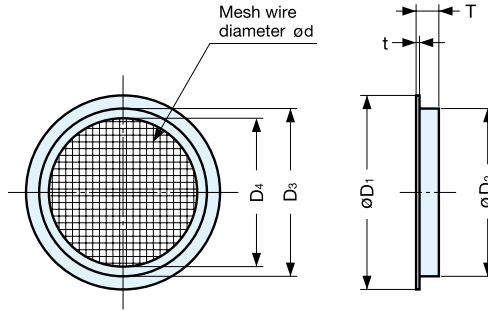

SAM



- 0.4 mm mesh wire diameter.
- Affix with glue.

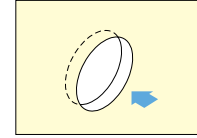

Installation

Material	Finish
304 Stainless Steel	Satin

Item No.	D ₁	D ₂	D ₃	D ₄	T	t	d	Weight (g)	Box (pcs)	Carton (pcs)
SAM-37	1-7/16" (36 mm)	1-1/4" (31.5 mm)	1-3/16" (30 mm)	1" (25 mm)	(5.2)	1/16" (0.3 mm)	1/16" (0.4 mm)	4.5	70	1400
SAM-45	1-13/16" (46 mm)	1-5/8" (41.5 mm)	1-9/16" (40 mm)	1-3/8" (35 mm)	(5.2)			6.0	60	1200
SAM-60	2-3/8" (60 mm)	2-1/8" (53.5 mm)	2-1/16" (52 mm)	1-13/16" (46 mm)	(6.5)			9.5	50	1000
SAM-85	3-3/8" (85 mm)	3-1/16" (77.8 mm)	3" (76.5 mm)	2-11/16" (68 mm)	(7.0)			16.5	30	600
SAM-120	4-3/4" (120 mm)	4-3/8" (110.5 mm)	4-1/4" (108 mm)	3-7/8" (99 mm)	(7.2)			46.5	20	200

() units in mm.

VENTILATOR



SAD

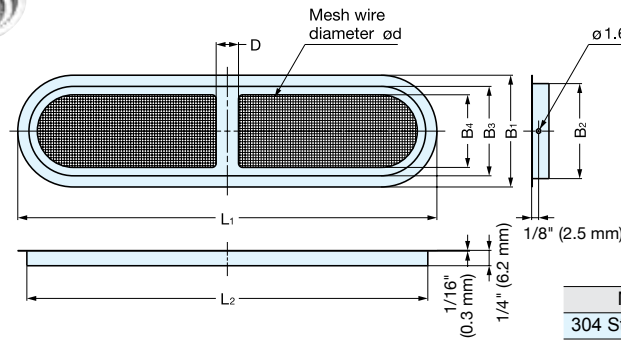

- 0.4 mm mesh wire diameter.
- Affix with glue or tack.

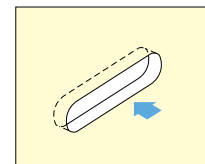

Installation

Material	Finish
304 Stainless Steel	Satin

Item No.	L ₁	B ₁	B ₃	B ₄	L ₂	B ₂	D	d	Weight (g)	Box (pcs)	Carton (pcs)
SAD-150	5-7/16" (150 mm)	1-9/16" (40 mm)	1-1/4" (32 mm)	1" (26 mm)	5-5/8" (143.5 mm)	(34)	(8)	1/32" (0.4)	18.5	30	600
SAD-200	7-7/8" (200.5 mm)	2" (50 mm)	1-5/8" (42 mm)	1-3/8" (35 mm)	7-5/8" (194 mm)	(44)	(10)		30	30	300

() units in mm.

VENTILATOR



ASM

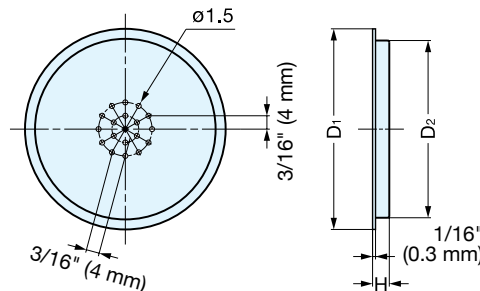

- 1.5 mm (1/16") diameter holes.
- Affix with glue.

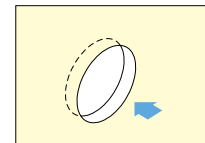

Installation

Material	Finish
304 Stainless Steel	Satin

Item No.	D ₁	D ₂	H	Holes	Weight (g)	Box (pcs)	Carton (pcs)
ASM-37	1-7/16" (36 mm)	1-1/4" (31 mm)	3/16" (4.5 mm)	37	3.0	100	3600
ASM-45	1-13/16" (46 mm)	1-5/8" (41 mm)		59	5.0		
ASM-60	2-3/8" (60 mm)	2-1/16" (53 mm)	3/16" (5 mm)	127	8.0		
ASM-85	3-3/8" (85 mm)	3" (77 mm)		271	13.5	50	1000