

LIFT-OFF HINGE



S-6173-2



- Screw hole is countersunk from both sides.
- Non-handed.
- Door weight: Max. 88 lbs/pair (40 kg/pair)

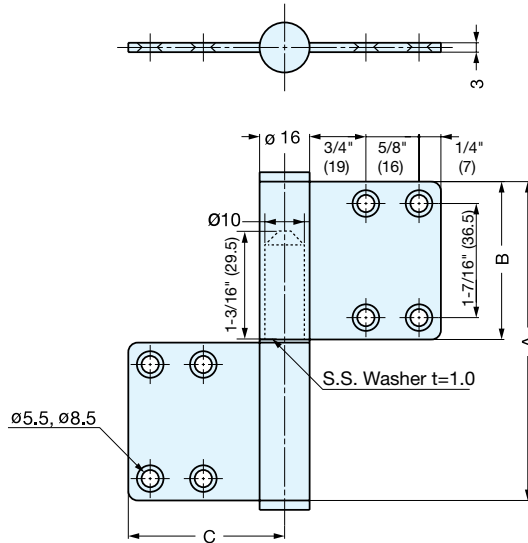

Material	Finish
304 Stainless Steel	Satin

Item No.	A	B	C	Weight (g)	Box (pcs)	Carton (pcs)
S-6173-2	4" (102)	2" (50.5)	2" (50)	240	12	60

LIFT-OFF HINGE



S-6173-5



- Screw hole is countersunk from both sides.
- Non-handed.
- Door weight: Max. 110 lbs/pair (50 kg/pair)

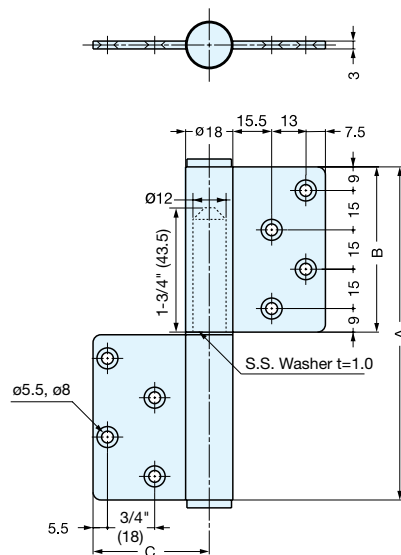

Material	Finish
304 Stainless Steel	Satin

Item No.	A	B	C	Weight (g)	Box (pcs)	Carton (pcs)
S-6173-5	5" (127 mm)	2-1/2" (63 mm)	1-3/4" (45 mm)	330	8	40