

CONCEALED HINGE



R SERIES

HINGES

CONCEALED HINGES

• Max. Door size:
W17-3/4" x H27-9/16" x t13/16"
(W450 x H700 x t21 mm).

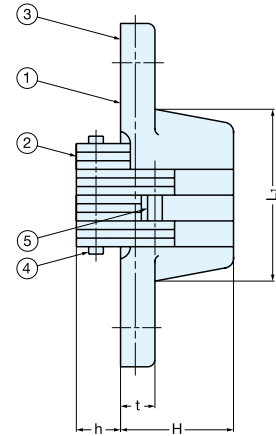
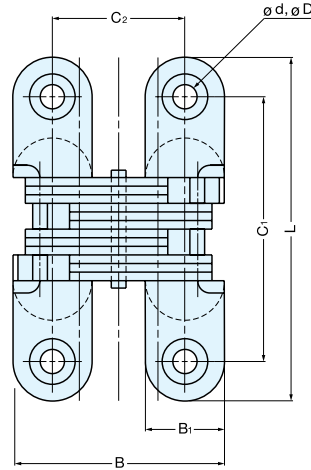

To determine the number of hinges required for each door:

- Using the chart to the right, locate the correct door width (upper scale) and door weight (lower scale). Draw a line connecting these 2 points to the chart below (point "a"). Then draw a vertical line through the lower chart to find the number and type of hinges required.

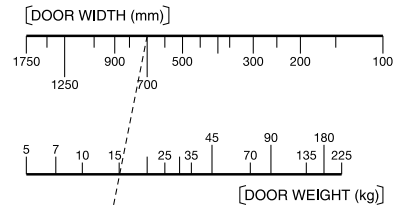

- Check door thickness requirements.

Item No.	No. of Hinges (pcs)
R- 43	3
R- 45	3
R- 60	3
R- 70	2
R-100	2

[In case of door width, 700 mm and door weight, 15 kg]

Item No.	Required Number Of Hinges (pcs)				"a"	Min. Door Thickness
R-43	2	3	4			13 mm
R-45	2	3	4			19 mm
R-60	2	3	4			19 mm
R-70	2	3	4			25 mm
R-100	2	3	4			29 mm

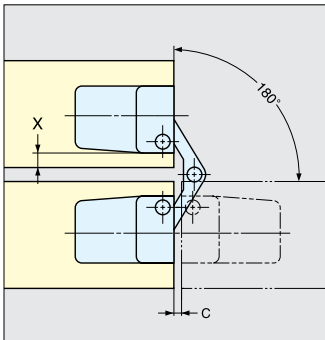

Distance between door edge and hinge must be less than the figures shown in column "X" of the dimension table below.

Item No.	L	L ₁	B	B ₁	C ₁	C ₂	H
R-43	1-11/16" (43 mm)	7/8" (22 mm)	1-1/8" (29 mm)	7/16" (11 mm)	1-1/4" (32 mm)	11/16" (18 mm)	1/2" (13 mm)
R-45	1-25/32" (45 mm)	3/4" (19 mm)	1-7/16" (35.7 mm)	1/2" (13 mm)	1-1/4" (32 mm)	7/8" (22.7 mm)	3/4" (18.5 mm)
R-60	2-3/8" (60 mm)	1-5/16" (33 mm)	1-3/8" (35.2 mm)	1/2" (13 mm)	1-7/8" (47 mm)	7/8" (22.2 mm)	3/4" (18.5 mm)
R-70	2-3/4" (70 mm)	1-3/8" (35 mm)	1-11/16" (42.6 mm)	5/8" (16.1 mm)	2-1/16" (53 mm)	1-1/16" (26.6 mm)	15/16" (23 mm)
R-100	3-15/16" (100 mm)	2-1/16" (52 mm)	2-1/16" (53.2 mm)	13/16" (20 mm)	3-1/8" (80 mm)	1-5/16" (33.2 mm)	1-1/16" (27.5 mm)

No.	Part Name	Material	Finish
①	Body	Zinc Alloy	Satin Chrome
②	Link Arm	304 Stainless Steel	Plain
③	Pin A	R-43~70: 304 Stainless Steel R-100: Steel	
④	Pin B	R-70: 303 Stainless Steel R-43~60, 100: Stainless Steel	
⑤	Pin C	R-43~60: 304 Stainless Steel R-70: 303 Stainless Steel R-100: Steel	
	Roller	R-100: Steel	

h	t	D	d	C	X	Arm (qty)	Weight (g)	Box (pcs)	Carton (pcs)	Screw
3/16" (5 mm)	3/16" (5 mm)	1/4" (6.2 mm)	1/8" (3.5 mm)	1/32" (0.8 mm)	1/16" (2.3 mm)	12	37	30	300	3.1 x 16
1/4" (6 mm)	3/16" (5 mm)	1/4" (7 mm)	1/8" (3.5 mm)	1/32" (0.8 mm)	1/8" (3 mm)	8	56	20	200	3.1 x 20
1/4" (6.5 mm)	1/4" (6.5 mm)	5/16" (8.3 mm)	3/16" (4.3 mm)	1/16" (1 mm)	1/8" (3 mm)	12	94	10	100	3.5 x 20
3/8" (9 mm)	1/4" (7 mm)	3/8" (9.1 mm)	3/16" (4.6 mm)	1/16" (1.2 mm)	1/8" (3.5 mm)	12	157	10	100	4.0 x 25
3/8" (9.5 mm)	3/8" (9.5 mm)	3/8" (10 mm)	3/16" (5.3 mm)	1/16" (1.8 mm)	3/16" (4.8 mm)	16	342	10	60	4.5 x 32