

COAT HOOK



PXB-AB05



Bronze Brown



Bronze Black



- Vintage design with brass casting.

PXB-AB05-101

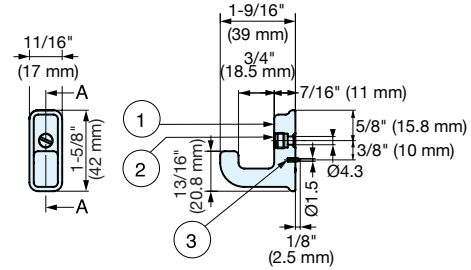

PXB-AB05-111

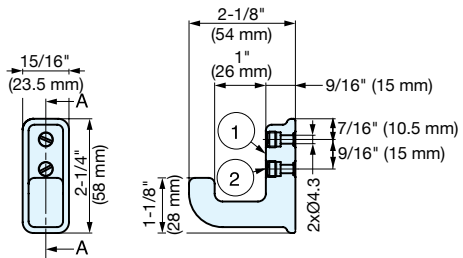

Item No.	Color	Load Capacity	W	H	D	Weight (g)
PXB-AB05-101-BL	Bronze Black	22 lbs (10 kg)	11/16" (17 mm)	1-5/8" (42 mm)	1-9/16" (39 mm)	79
PXB-AB05-101-BR	Bronze Brown					
PXB-AB05-111-BL	Bronze Black	22 lbs (10 kg)	15/16" (23.5 mm)	2-1/4" (58 mm)	2-1/8" (54 mm)	210
PXB-AB05-111-BR	Bronze Brown					

(units in mm)

No.	Part Name	Material	Finish
①	Body	Brass	Bronze Black (BL)
②	Screw		Bronze Brown (BR)
③	Sharp Pin	Stainless Steel	Plain

COAT HOOK (AGED CAST)



PXB-AC05-111

- Vintage design with brass casting.



Bronze Black



Bronze Brown

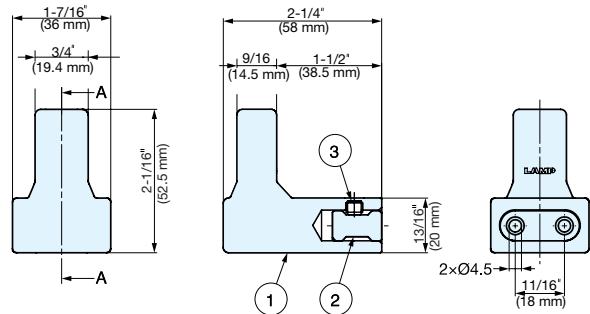

No.	Part Name	Material	Finish
①	Body	Brass	Bronze Black (BL)
②	Insert		Bronze Brown (BR)
③	Screw	Bronze	

Item No.	Color	Load Capacity	W	H	D	Weight (g)
PXB-AC05-111-BL	Bronze Black	44 lbs (20 kgf)	1-7/16" (36)	2-1/16" (52.5)	2-1/4" (58)	400
PXB-AC05-111-BR	Bronze Brown					

(units in mm)