

OVERLAY DOOR PIVOT HINGE



PL-65

- Door Size: Max. W17-3/4" × H27-9/16" × t7/8" (W450 × H700 × t22 mm)
- Door Weight: Max. 8.8 lbs/ pair (4 kg/pair)



Left handed model shown.

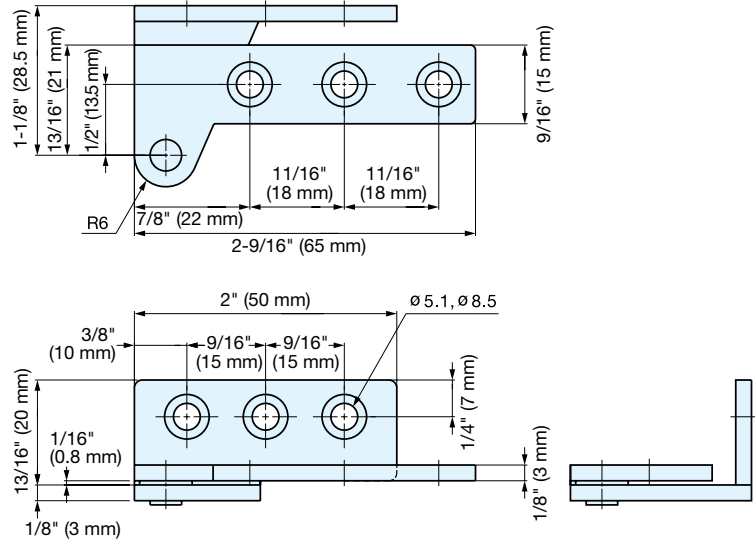

Left handed model shown.

Item No.		Weight (g)	Box (pcs)	Carton (pcs)	Material	Finish
Left	Right					
PL-65L	PL-65R	55	40	400	430 Stainless Steel	Plain

OVERLAY DOOR PIVOT HINGE



PL-100

- Door Size: Max. W23-5/8" × H29-1/2" (W600 × H750 mm)
- Door Weight: Max. 13.2 lbs/pair (6 kg/pair)



Right handed model shown.

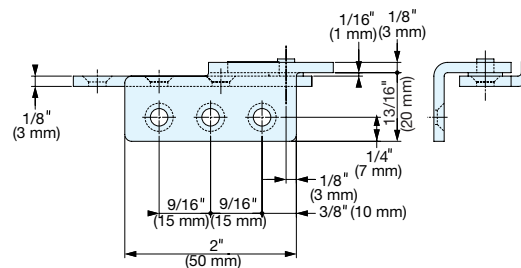
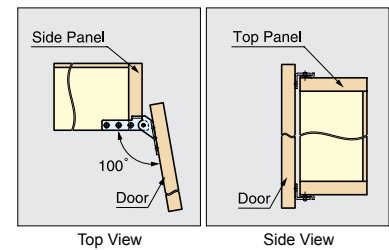
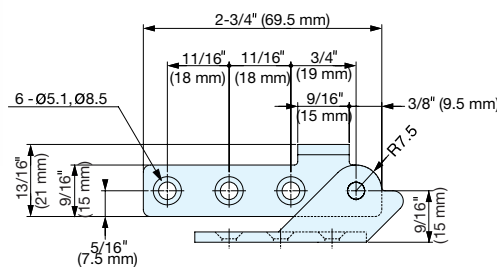

Left handed model shown.

Item No.		Weight (g)	Box (pcs)	Carton (pcs)	Material	Finish
Left	Right					
PL-100L	PL-100R	55	100	1000	304 Stainless Steel	Plain