

# ADJUSTABLE SOFT-DOWN STAY



# NSDX-20

LID SUPPORTS

ADJUSTABLE SOFT-DOWN STAYS



- For TOP-OPENING FLAP DOOR used with piano, butt or concealed hinges.
- Opening angle 70° or 105°.
- NSDX-20 is designed to hold door in fully opened position.
- Speed adjustment screw located on front for easy adjustment.
- Torque Calculation :  
Torque = Door Height × 0.5 × Door Weight  
Per Piece : 19~60 lbs-inch (20~70 kg-cm)  
Per Pair : 38~120 lbs-inch (40~140 kg-cm)

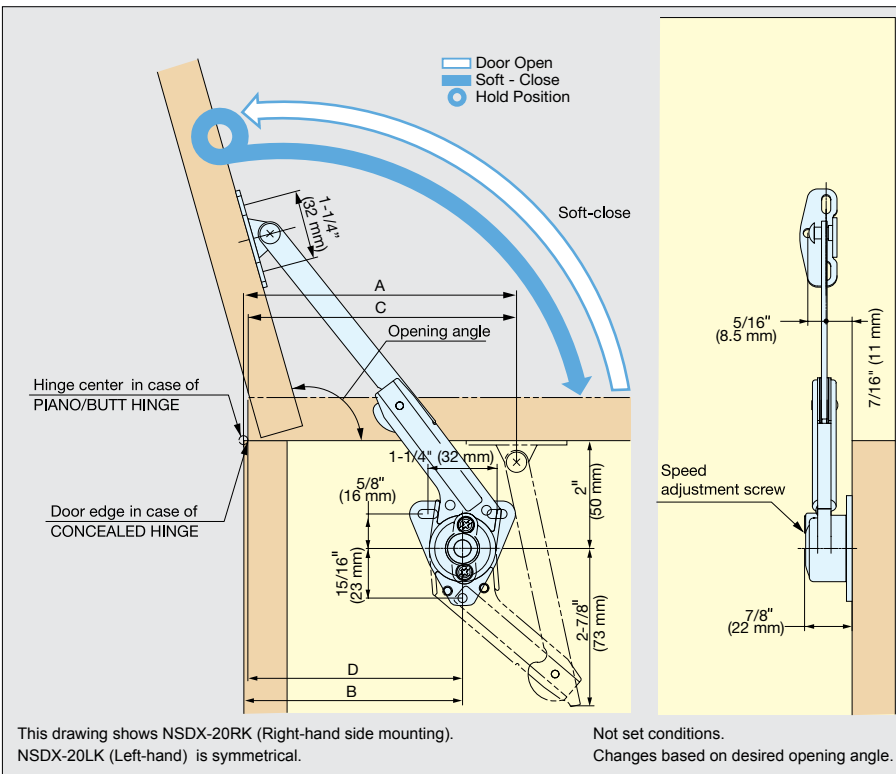

## NSDX-SZ (Included)

Mounting Plate for wooden door, screw-on type.

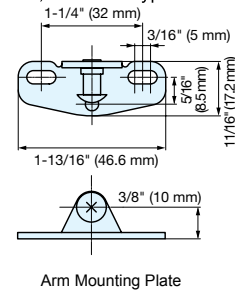

## 70° or 105° Opening

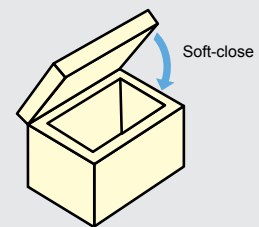

Material	Finish	Item No.		Weight (g)	Box (pcs)	Carton (pcs)
		NSDX-20RK	Right			
Zinc Alloy	Nickel	NSDX-20RK	Right	181	20	80
Steel		NSDX-20LK	Left			

Opening Angle	Hinge Type	A	B	C	D	E
70°	Concealed Hinge	-	-	4-15/16" (126 mm)	4" (101 mm)	7/16" (11 mm)
	Piano/Butt Hinge	4-15/16" (125 mm)	3-15/16" (100 mm)	-	-	
105°	Concealed Hinge	-	-	4-1/16" (103 mm)	3-1/16" (78 mm)	
	Piano/Butt Hinge	3-13/16" (97 mm)	2-13/16" (72 mm)	-	-	