

# GUIDE BLOCK & RAIL



# MRS30, MR-30CS

DRAWER SLIDES

MINI GUIDE BLOCKS & RAILS

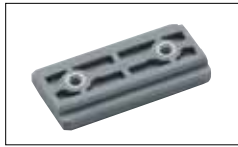

MR-30CS



- Perfect for small stroke application.
- No lubricant (P415,416,417) needed.
- \* Block and Rail sold separately.
- \* MR-30CS formerly MR-50C

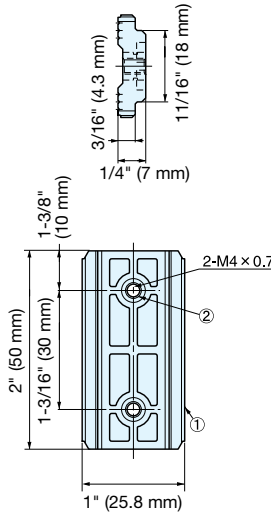

MR-30CS

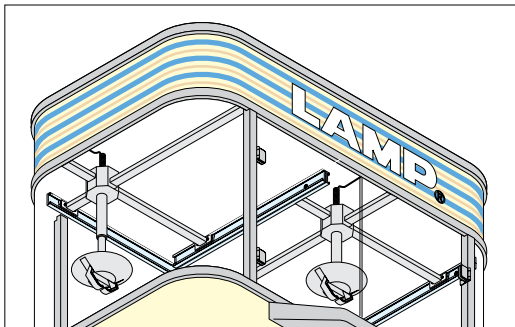
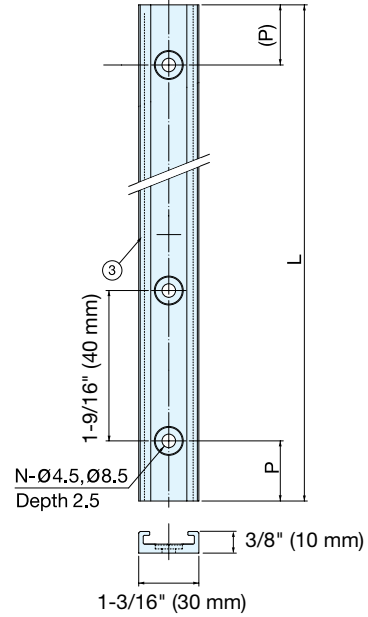

Installation

■ Rail						25.4mm=1"
Item No.	L	P	N	Weight (g)	Box (pcs)	
MRS30-100	3-15/16" (100 mm)	3/8" (10 mm)	3	39	200	
MRS30-200	7-7/8" (200 mm)	25/32" (20 mm)	5	79	100	
MRS30-400	15-3/4" (400 mm)		10	159	50	
MRS30-800	31-1/2" (800 mm)		20	312	40	
MRS30-2000	78-3/4" (2000 mm)		50	790	15	

\*Both ends of rail are not anodized.

No.	Material	Finish
①	Polyethylene (UL 94HB)	Grey
②	304 Stainless Steel	Plain
③	Aluminum	Anodized

■ Block

Item No.	Weight (g)	Box (pcs)	Carton (pcs)
MR-30CS	7	50	1000

### MRS 30, MR-30CS LOAD RATING INFORMATION

Dynamic Friction Coefficient: 1

Maximum PV (Pressure (kgf-mm<sup>2</sup>) × Velocity (m/min.)) = 3.06

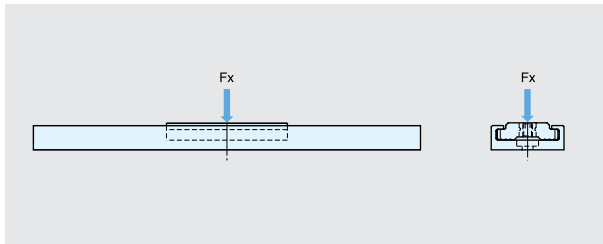

Horizontal Static Load Fx	57.2 lbs (26.0 kg)
Vertical Static Load Fy	33.0 lbs (15.0 kg)
Vertical Dynamic Load Mx	21.6 lbs-in (25.0 kg-cm)
Horizontal Dynamic Load My	10.8 lbs-in (12.5 kg-cm)
Horizontal Dynamic Load Mz	10.8 lbs-in (12.5 kg-cm)

#### ◆ Reduction Factor

Certain reduction needs to be applied depending on application or environment.  
 Low speed/Low operation frequency = 70% to 100% of Load Rating  
 Moderate speed/High operation frequency = 35% to 65% of Load Rating  
 High operation frequency with Vibration & Shocks = 10% to 30% of Load Rating