

# HANDLE



# MH-P



MH-P170

MH-P120

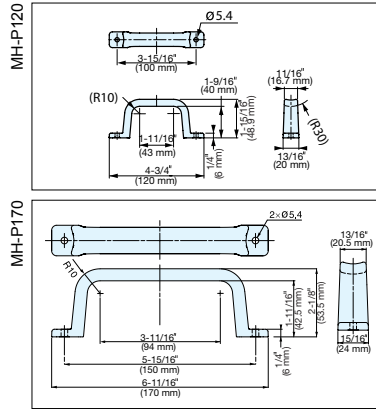

- Made with PVC material:
  - Ideal for semiconductor, manufacturing machinery and transparent applications.
  - Weather proof, chemical proof
- High profile allows for handle to be easily grasped with gloved hands.
- Environmentally friendly PVC, lead-free.
- Compliant with SEMI S8-0308 guideline.
- Requires two 3/16" (5 mm) diameter screws for installation. Screws not included.

High profile makes it easier to use with gloves

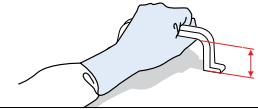

Item No.	Weight (g)	Box (pcs)	Carton
MH-P120	34	64	640
MH-P170	56	48	480

Material	Finish
Polyvinyl Chloride (PVC)	Clear

# HANDLE



# US



US-160/M  
Mirror

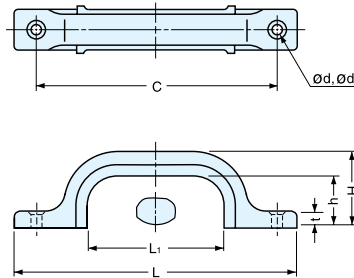

- Rubber grip allows for an easy and comfortable grip.
- Lightweight design.

Material	Finish
304 Stainless Steel	Mirror (M) Satin (S)

\* Grip - Black/Synthetic Rubber

Item No.	L	L <sub>1</sub>	C	B	H	h	t	d	d <sub>1</sub>	Weight (g)	Box (pcs)	Carton (pcs)	Screw
US-120/M US-120/S	4-3/4" (120 mm)	2-1/4" (57 mm)	4" (102 mm)	3/4" (19 mm)	1-1/4" (32 mm)	13/16" (21 mm)	1/4" (6.5 mm)	1/8" (3.8 mm)	5/16" (7.6 mm)	45	20	200	3.5 × 20
US-160/M US-160/S	6-5/16" (160 mm)	3-7/16" (88 mm)	5-1/2" (140 mm)	7/8" (22 mm)	1-1/2" (37.5 mm)	15/16" (23 mm)	5/16" (7.5 mm)	3/16" (4.1 mm)	5/16" (8.1 mm)	70	10	100	4.1 × 25

# HANDLE



# EC-H

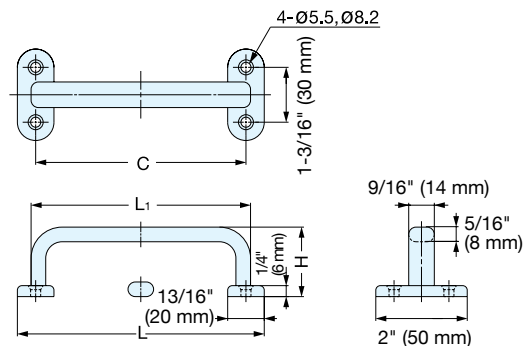

Material	Finish
303 Stainless Steel	Mirror

Item No.	L	L <sub>1</sub>	C	H	Weight (g)	Box (pcs)	Carton (pcs)	Screw
EC-H-135	5-5/16" (135 mm)	4-3/4" (120 mm)	4-1/2" (115 mm)	1-9/16" (40 mm)	191	5	50	3.1 × 16
EC-H-165	6-1/2" (165 mm)	5-15/16" (150 mm)	5-11/16" (145 mm)	1-5/8" (42 mm)	216	3	30	3.5 × 20