

BUTT HINGE



LSA, LSB

HINGES



LAS-75
without holes



LSB-75
with holes

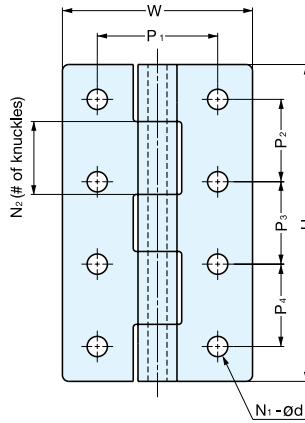

• Available as a weld-on type without holes (LSA) or screw-on type with holes (LSB).
Note: Screw holes for LSB Series are not countersunk.

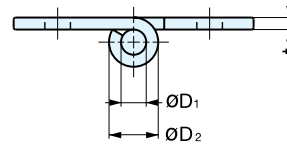

Material	Finish
304 Stainless Steel	Mirror

Item No.	Holes	H	W	P ₁	P ₂	P ₃	P ₄	t	d	D ₁	(D ₂)	N ₁	N ₂	Door Weight (pair)	Weight (g)	Box (pcs)	Carton (pcs)	
LSA-40	Without Holes	1-9/16" (40 mm)	1-3/8" (35 mm)	-	-	-	-	1/16" (1.5 mm)	-	1/8" (3 mm)	1/4" (6.3 mm)	-	1/8" (3 mm)	13 lbs (6 kg)	25	20	500	
LSA-50		2" (50 mm)	-	-	-	-	-	-	-	-	-	-	-	17 lbs (8 kg)	30			
LSA-65		2-9/16" (65 mm)	2"	-	-	-	-	3/32" (2 mm)	-	3/16" (4.5 mm)	3/8" (8.8 mm)	-	3/16" (5 mm)	28 lbs (13 kg)	66			
LSA-75		2-15/16" (75 mm)	(50 mm)	-	-	-	-	-	-	-	-	-		33 lbs (15 kg)	76			
LSA-90		3-9/16" (90 mm)	2-3/8" (60 mm)	-	-	-	-	1/8" (3 mm)	-	1/4" (6 mm)	1/2" (12.3 mm)	-	-	55 lbs (25 kg)	190	10	100	
LSA-100		3-15/16" (100 mm)	-	-	-	-	-	-	-	-	-	-	-	66 lbs (30 kg)	200			
LSB-40		With Holes	1-9/16" (40 mm)	1-3/8" (35 mm)	7/8" (22 mm)	1" (26 mm)	-	-	1/16" (1.5 mm)	1/8" (3.2 mm)	1/8" (3 mm)	1/4" (6.3 mm)	3/16" (4 mm)	1/8" (3 mm)	13 lbs (6 kg)	25	20	500
LSB-50			2" (50 mm)	1-5/16" (34 mm)	-	-	-	-	1/16" (1.5 mm)	3/16" (4.3 mm)	3/16" (4.5 mm)	3/8" (8.8 mm)	1/4" (6 mm)	3/16" (5 mm)	17 lbs (8 kg)	30		
LSB-65			2-9/16" (65 mm)	2"	1-3/16" (30 mm)	15/16" (23 mm)	15/16" (23 mm)	-	1/16" (2 mm)	3/16" (5.3 mm)	3/16" (4.5 mm)	3/8" (8.8 mm)	1/4" (6 mm)	3/16" (5 mm)	28 lbs (13 kg)	64		
LSB-75			2-15/16" (75 mm)	(50 mm)	1-1/16" (27 mm)	1-1/16" (27 mm)	1-1/16" (27 mm)	-	1/16" (2 mm)	3/16" (5.3 mm)	3/16" (4.5 mm)	3/8" (8.8 mm)	1/4" (6 mm)		33 lbs (15 kg)	74		
LSB-90	3-9/16" (90 mm)		2-3/8" (60 mm)	1-1/2" (38 mm)	1-3/8" (35 mm)	1-3/8" (35 mm)	-	1/8" (3 mm)	1/4" (6.4 mm)	1/4" (6 mm)	1/2" (12.3 mm)	5/16" (8 mm)	55 lbs (25 kg)	180	10	100		
LSB-100	3-15/16" (100 mm)		-	1" (26 mm)	1" (26 mm)	1" (26 mm)	-	1/8" (3 mm)	1/4" (6.4 mm)	1/4" (6 mm)	1/2" (12.3 mm)	5/16" (8 mm)	66 lbs (30 kg)	195				

BUTT HINGES / STAINLESS STEEL WELD-ON HINGES

STAINLESS STEEL WELD-ON HINGE



LSK

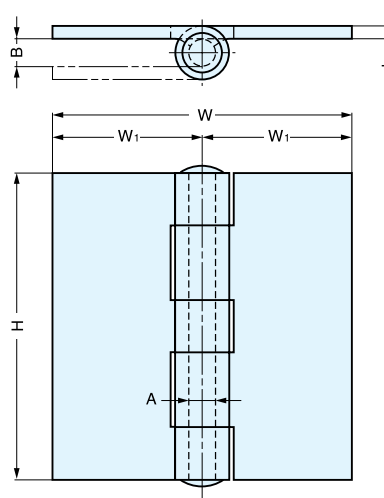

• Available as weld-on type without holes only.
For screw-on type butt hinges, please see 3535 and 4040 Series hinges (P.192).

Material	Finish
304 Stainless Steel	Satin

Item No.	H	W ₁	W	A	B	t	Weight (g)	Box (pcs)	Carton (pcs)	
LSK-1157-1	2" (51 mm)	1" (25 mm)	2" (50 mm)	1/4" (6 mm)	1/4" (6 mm)	1/8" (2.5 mm)	76	10	250	
LSK-1157-2	2-1/2" (64 mm)	1-1/4" (32 mm)	2-1/2" (64 mm)	1/4" (7 mm)	9/32" (7 mm)	3/16" (4 mm)	141		150	
LSK-1157-3	3" (76 mm)	1-7/16" (37 mm)	2-15/16" (74 mm)				257		80	
LSK-1157-4	3-1/2" (89 mm)	1-11/16" (43.5 mm)	3-7/16" (87 mm)	5/16" (8 mm)	5/16" (8 mm)		417		50	
LSK-1157-5	4" (101.6 mm)	1-15/16" (49.5 mm)	3-7/8" (99 mm)	7/16" (11 mm)	7/16" (11 mm)		681		6	30
LSK-1157-6	5" (127 mm)	2-5/16" (59.5 mm)	4-11/16" (119 mm)	1/2" (12 mm)	1/2" (12 mm)		928		4	20
LSK-1157-7	6" (152 mm)	2-13/16" (71.5 mm)	5-5/8" (143 mm)							