

# BUTT HINGE

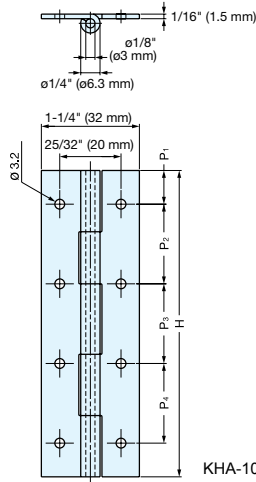

**KHA**



KHA-100C shown

• Screw holes are not countersunk.

Material	Finish
304 Stainless Steel	Polished

Item No.	H	P <sub>1</sub>	P <sub>2</sub>	P <sub>3</sub>	P <sub>4</sub>	Knuckles	Weight (g)	Box (pcs)	Carton (pcs)
KHA-25C	1" (25 mm)	1/4" (6 mm)	1/2" (13 mm)	-	-	3	13	200	800
KHA-30C	1-3/16" (30 mm)	1/4" (7 mm)	5/8" (16 mm)	-	-		16		
KHA-40C	1-9/16" (40 mm)		15/16" (24 mm)	-	-		21	150	600
KHA-50C	2" (50 mm)	1-3/16" (30 mm)	-	-	26				
KHA-60C	2-3/8" (60 mm)	5/16" (8 mm)	7/8" (22 mm)	7/8" (22 mm)	-	5	31	100	400
KHA-65C	2-9/16" (65 mm)	5/16" (8.5 mm)	15/16" (24 mm)	15/16" (24 mm)	-		34		
KHA-75C	2-15/16" (75 mm)	3/8" (9.5 mm)	1-1/8" (28 mm)	1-1/8" (28 mm)	-		39	50	200
KHA-80C	3-1/8" (80 mm)	3/8" (10 mm)	1-3/16" (30 mm)	1-3/16" (30 mm)	-		42		
KHA-90C	3-9/16" (90 mm)		1-3/8" (35 mm)	1-3/8" (35 mm)	-	47			
KHA-100C	3-15/16" (100 mm)	7/16" (11 mm)	1" (26 mm)	1" (26 mm)	1" (26 mm)	52			

# BUTT HINGE (W/BUSHING)



**D-S**

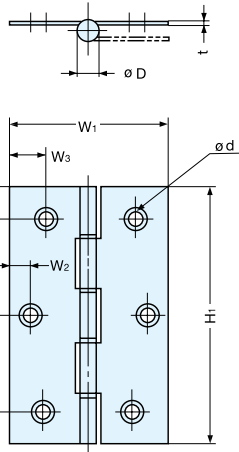

D-S-64-89A

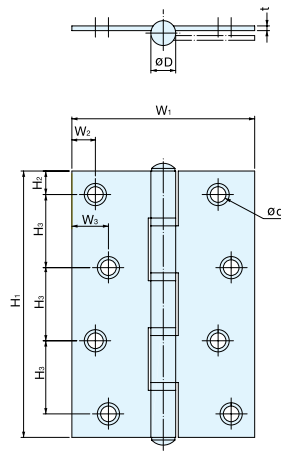

D-S-102A/127A

• Stainless steel hinge with polyacetal bushing.

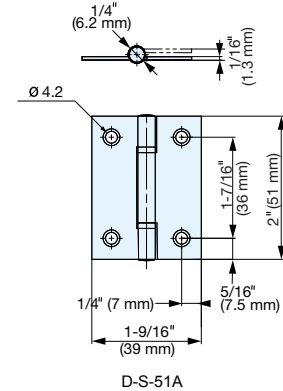

D-S-51A

Part Name	Material	Finish
Body	304 Stainless Steel	Satin
Bushing	Polyacetal	Natural

Item No.	H <sub>1</sub>	H <sub>2</sub>	H <sub>3</sub>	W <sub>1</sub>	W <sub>2</sub>	W <sub>3</sub>	D	t	d	Knuckles	Holes	Weight (g)	Box (pcs)	Carton (pcs)
D-S-51A	2" (51 mm)	5/16" (7.5 mm)	1-13/32" (36 mm)	1-7/16" (39 mm)	-	1/4" (7 mm)	1/4" (6.2 mm)	1/16" (1.3 mm)	3/16" (4.2 mm)	3	4	27.4	20	1000
D-S-64A	2-1/4" (64 mm)	1/4" (7 mm)	31/32" (25 mm)	1-11/16" (42.5 mm)	1/4" (6 mm)	5/16" (8 mm)	1/4" (6.2 mm)	1/16" (1.3 mm)	3/16" (5 mm)	5	6	36.5		
D-S-76A	3" (76 mm)	3/8" (9 mm)	1-1/8" (29 mm)	2" (50 mm)	1/4" (7 mm)	3/8" (9 mm)	5/16" (7.4 mm)	1/16" (1.5 mm)	3/16" (5.2 mm)			5	8	59.5
D-S-89A	3-1/2" (89 mm)	7/16" (10.5 mm)	1-11/32" (34 mm)	2-1/4" (56.5 mm)	5/16" (7.5 mm)	7/16" (10.5 mm)	3/8" (9 mm)	1/16" (1.5 mm)	3/16" (5.4 mm)	5	8			91.6
D-S-102A	4" (102 mm)	3/8" (9 mm)	1-3/32" (28 mm)	2-3/4" (70 mm)	3/8" (9 mm)	9/16" (14 mm)	3/8" (9.5 mm)	1/16" (1.8 mm)	1/4" (6 mm)			5	8	132.5
D-S-127A	5" (127 mm)	7/16" (11 mm)	1-3/8" (35 mm)	3-1/4" (82 mm)	7/16" (10.5 mm)	5/8" (16 mm)	7/16" (11.5 mm)	1/16" (1.8 mm)	1/4" (6 mm)	5	8			231.5