

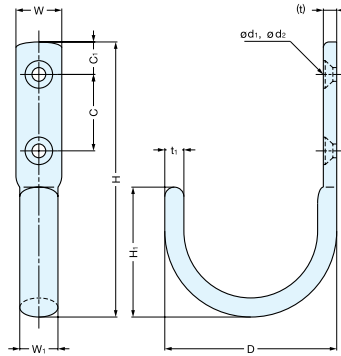

# LARGE UTILITY HOOK



# JF-45, 70, 110



Material	Finish
303 Stainless Steel	Mirror

Item No.	D	W	W <sub>1</sub>	H	H <sub>1</sub>	C	C <sub>1</sub>	t	t <sub>1</sub>	d <sub>1</sub>	d <sub>2</sub>	Load Capacity	Weight (g)	Box (pcs)	Carton (pcs)	Screw
JF-45	1-3/4" (45)	1/2" (12)	3/8" (10)	2-13/16" (72)	1-5/16" (34)	13/16" (20)	5/16" (8.5)	1/8" (3.5)	3/16" (5)	1/8" (3.8)	1/4" (7.2)	22 lbs (10 kg)	40	20	120	3.5 × 16
JF-70	2-11/16" (68)	5/8" (16)	1/2" (13)	4-3/4" (120)	2-3/16" (55)	1-3/8" (35)	9/16" (15.0)	3/16" (4.0)	1/4" (6)	3/16" (4.3)	5/16" (8.6)		95	6	36	4.1 × 20
JF-110	4-5/16" (110)	11/16" (18)	9/16" (14)	7-7/8" (200)	3-9/16" (90)	2-3/4" (70)	11/16" (17.0)	1/4" (5.5)	5/16" (8)	3/16" (5.3)	7/16" (10.6)	26 lbs (12 kg)	270	5	30	5.1 × 32

()units in mm

# LARGE UTILITY HOOK



# JF-50, 80, 120

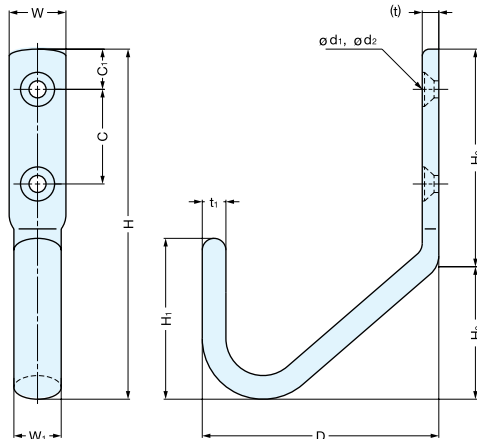

Installation

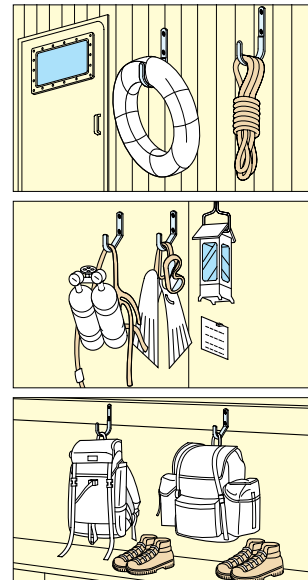

Material	Finish
303 Stainless Steel	Mirror

Item No.	D	W	W <sub>1</sub>	H	H <sub>1</sub>	H <sub>2</sub>	H <sub>3</sub>	C	C <sub>1</sub>	t	t <sub>1</sub>	d <sub>1</sub>	d <sub>2</sub>	Load Capacity	Weight (g)	Box (pcs)	Carton (pcs)	Screw
JF-50	2" (50)	1/2" (12)	3/8" (10)	2-15/16" (74)	1-5/16" (34)	1-13/16" (46)	1-1/8" (28)	13/16" (20)	5/16" (8.5)	1/8" (3.5)	3/16" (5)	1/8" (3.8)	1/4" (7.2)	26 lbs (12 kg)	40	20	120	3.5 × 16
JF-80	3-1/8" (80)	5/8" (16)	1/2" (13)	4-1/2" (115)	2" (50)	2-9/16" (65)	2" (50)	1-3/16" (30)	9/16" (15.0)	3/16" (4.0)	1/4" (6)	3/16" (4.3)	5/16" (8.6)	44 lbs (20 kg)	95	6	36	4.1 × 20
JF-120	4-3/4" (120)	11/16" (18)	9/16" (14)	7-7/8" (200)	3-9/16" (90)	4-7/16" (112)	3-7/16" (88)	2-3/4" (70)	11/16" (17.0)	1/4" (5.5)	5/16" (8)	3/16" (5.3)	7/16" (10.6)	48 lbs (22kg)	260	5	30	5.1 × 32

()units in mm

[www.sugatsune.com](http://www.sugatsune.com)

1-800-562-5267  
(U.S.A. Only)

HOOKS

LARGE UTILITY HOOKS