

# LARGE RECESSED PULL (WITH BAR HANDLE)



## HH-M



- Durable 304 stainless steel construction.
- Designed for industrial applications where use of thick gloves are required.
- Handlebar does not protrude out from the face of the handle.
- 2 sizes available.

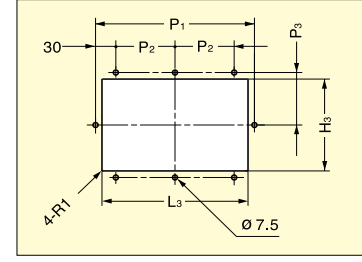
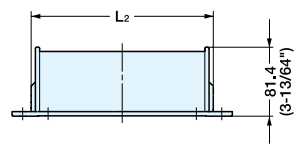
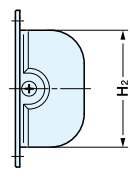
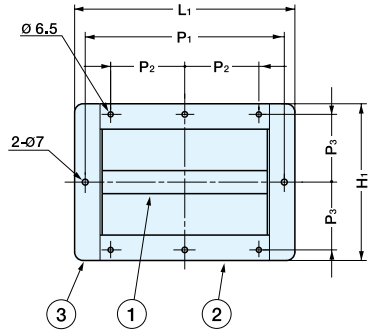
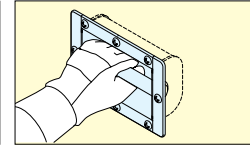
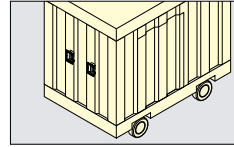

Item No.	Box (pcs)	Carton (pcs)
HH-M200	1	4
HH-M400	1	2

No.	Part Name	Material
①	Bar	304 Stainless Steel
②	Cup	
③	End Cover	

Item No.	L <sub>1</sub>	H <sub>1</sub>	H <sub>2</sub>	L <sub>2</sub>	P <sub>1</sub>	P <sub>2</sub>	P <sub>3</sub>	L <sub>3</sub>	H <sub>3</sub>
HH-M200	10-1/4" (260 mm)	7-5/16" (186.3 mm)	5-7/16" (138.3 mm)	8-9/16" (218 mm)	9-1/4" (235 mm)	3-7/16" (87.5 mm)	3-1/8" (80 mm)	8-1/2" (216 mm)	5-1/2" (140 mm)
HH-M400	18-1/8" (460 mm)	7-5/16" (186.3 mm)	5-7/16" (138.3 mm)	16-7/16" (418 mm)	17-1/8" (435 mm)	4-15/16" (125 mm)		16-3/8" (416 mm)	

# RECESSED PULL



## HH-P



Large opening makes it easier to use with gloves

- Made with PVC material:
- Ideal for semiconductor, manufacturing machinery and transparent applications.
- Weather proof, chemical resistant.
- Large opening allows for easy accessibility with gloved hands.
- Environmentally friendly-Lead free.
- Compliant with SEMI S8-0308 guideline.

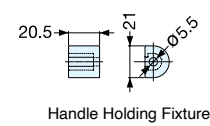
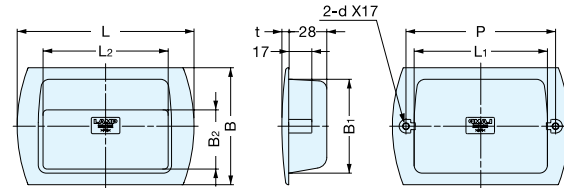

Material	Color
Polyvinyl Chloride (PVC)	Clear

Item No.	Weight (g)	Box (pcs)	Carton (pcs)
HH-P118	43	45	450
HH-P130	100	30	300

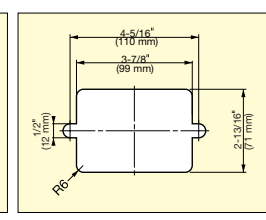
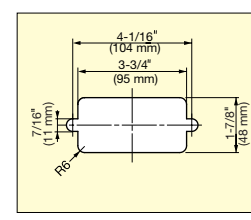

Item No.	L	L <sub>1</sub>	L <sub>2</sub>	B	B <sub>1</sub>	B <sub>2</sub>	H	P	d	t	Door Thickness (mm)
HH-P118	4-5/8" (118 mm)	3-11/16" (93 mm)	3-9/16" (90 mm)	2-1/4" (58 mm)	1-7/8" (47 mm)	1" (25.5 mm)	7/8" (21.5 mm)	4-1/16" (104 mm)	M4	3/16" (4 mm)	1/16" ~ 7/16" (1 ~ 11 mm)
HH-P130	5-1/8" (130 mm)	3-7/8" (98 mm)	3-5/8" (92 mm)	3-3/8" (86 mm)	2-3/4" (69 mm)	1-11/16" (43.5 mm)	1-1/8" (28 mm)	4-5/16" (110 mm)	M5	3/16" (5 mm)	1/16" ~ 7/16" (1 ~ 11 mm)