

HIGH DURABILITY SPRING HINGE



HG-SHL



HG-SHL32

HG-SHL50

HG-SHL60

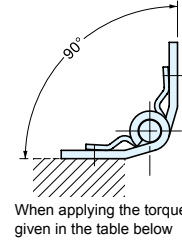
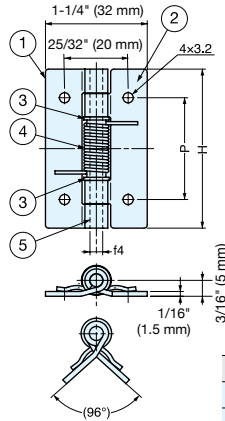

- Spring loaded to keep doors shut.
- Stainless steel suitable for corrosive environments.
- High durability; Passed 1,000,000 open/close private cycle tests.

No.	Part Name	Material	Finish/Color
①	Body	304 Stainless Steel	Polished
②	Body 2		
③	Collar	303 Stainless Steel	-
④	Spring	304 Stainless Steel	
⑤	Shaft	303 Stainless Steel	

Item No.	H	P	Load Capacity	Torque	Weight (g)	Box (pcs)	Carton (pcs)
HG-SHL32	1-1/4" (32 mm)	11/16" (18 mm)	8.8 lbs (4 kg)	0.42 lbs/in (0.48 kgf/cm)	20	50	500
HG-SHL50	2" (50 mm)	1-1/4" (32 mm)	13 lbs (6 kg)	0.79 lbs/in (0.91 kgf/cm)	30		
HG-SHL60	2-3/8" (60 mm)	1-9/16" (40 mm)		1.24 lbs/in (1.43 kgf/cm)	38		

BUTT HINGE (W/SPRING)



HG-SH

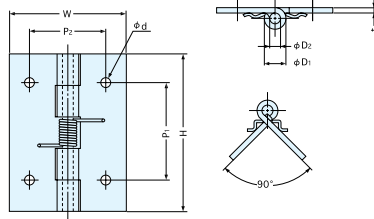

- Designed to close with spring tension when hinge is surface mounted.
- HG-SH20C has no screw holes.

Material	Finish
304 Stainless Steel	Plain

Item No.	H	W	P ₁	P ₂	D ₁	D ₂	d	t	Torsion Spring Force	Weight (g)	Box (pcs)	Carton (pcs)
HG-SH20C	13/16" (20 mm)	9/16" (14 mm)	-	-	1/16" (2.2 mm)	1/16" (1 mm)	-	1/16" (0.5 mm)	0.86 lbs-in (0.99 kg-cm)	11.5	800	3200
HG-SH25C	1" (25 mm)	1-1/4" (32 mm)	9/16" (14 mm)	13/16" (20 mm)	1/4" (5.8 mm)	1/8" (3 mm)	1/8" (3.2 mm)	1/16" (1.2 mm)	0.57 lbs-in (0.66 kg-cm)	10.0	300	1200
HG-SH38C	1-1/2" (38 mm)	1-1/2" (38 mm)	1-1/32" (26 mm)	1/4" (6.5 mm)	1/4" (6.5 mm)			1/16" (1.5 mm)	1.3 lbs-in (1.50 kg-cm)	20.0	200	800
HG-SH51C	2" (51 mm)	1-1/2" (38 mm)	1-1/4" (32 mm)	1" (25 mm)	1/4" (6.5 mm)	-	-	1/16" (1.5 mm)	1.19 lbs-in (1.38 kg-cm)	35.0	130	520

BUTT HINGE (W/SPRING)



SH

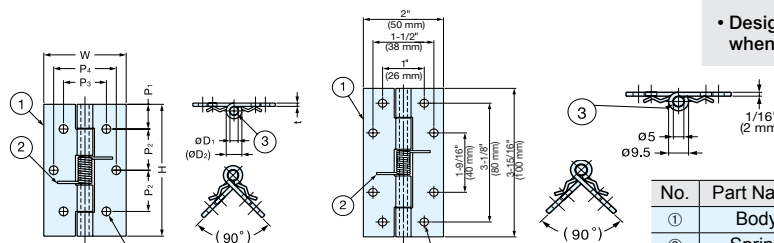

SH-60C, SH-80C

SH-100C

- Designed to close with spring tension when hinge is surface mounted.

No.	Part Name	Material	Finish
①	Body	304 Stainless Steel	Polished
②	Spring		-
③	Hinge Pin		-

Item No.	H	W	t	P ₁	P ₂	P ₃	P ₄	D ₁	(D ₂)	d	Weight (g)	Box (pcs)	Carton (pcs)
SH-60C	2-3/8" (60)	1-9/16" (40)	1/16" (1.5)	3/8" (10)	13/16" (20)	1" (26)	1" (26)	3/16" (5)	5/16" (8.5)	3/16" (4.3)	44	120	1200
SH-80C	3-1/8" (80)	2" (50)	1/16" (2)	9/16" (15)	1" (25)				1-1/2" (38)	3/8" (9.5)	3/16" (5.3)	86	80
SH-100C	3-15/16" (100)	2" (50)	1/16" (2)	-	-	-	-	-	110	100	1000		

() unit in mm.