

HEAVY DUTY SOFT-DOWN STAY



HDS-30

LID SUPPORTS

HEAVY DUTY SOFT-DOWN STAYS



360-26/19T
360-P4W-32T
(Sold separately)

HDS-30KR/WHT

- For UPWARD-OPENING FLAP DOOR used with piano, butt or concealed Hinges.
- Used in pairs.
- HDS-30 is designed to securely latch a flap closed and hold it in the fully opened position.
- Torque Calculation:
Torque = Door Height × 1/2 × Door Weight
- K-Type (Light Duty):
121~173 lbs-in (140~200 kg-cm)/pair
- M-Type (Medium Duty):
173~216 lbs-in (200~250 kg-cm)/pair
- H-Type (Heavy Duty):
216~260 lbs-in (250~300 kg-cm)/pair

With Single Knuckle Hinge

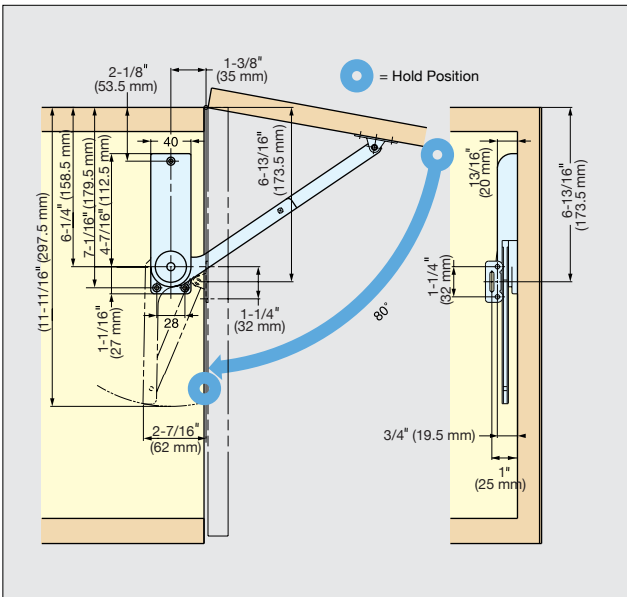

With Concealed Hinge

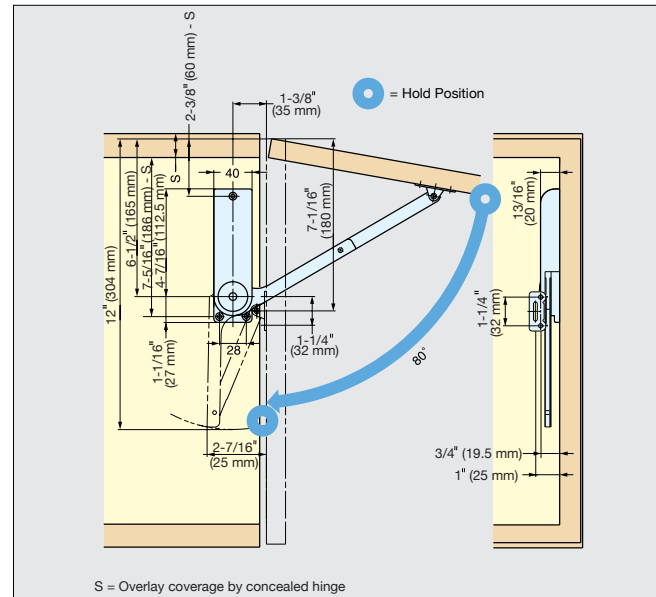

Item No.		Type	Torque /pair	Weight (g)	Box (pcs)	Carton (pcs)
Left	Right					
HDS-30KL	HDS-30KR	Light Duty	121~173 lbs-in (140~200 kg-cm)	270	40	200
HDS-30ML	HDS-30MR	Medium Duty	173~216 lbs-in (200~250 kg-cm)	290		
HDS-30HL	HDS-30HR	Heavy Duty	216~260 lbs-in (250~300 kg-cm)	300		

Material	Finish/Color
Steel	Nickel
Plastic	Black, White