

HEAVY DUTY SOFT-DOWN STAY



HDS-20

LID SUPPORTS

HEAVY DUTY SOFT-DOWN STAYS



- For TOP-OPENING FLAP DOOR used with piano, butt or concealed hinges.
- Used in pairs.
- HDS-20 is designed to hold door in fully opened position.
- Torque Calculation:
Torque = Door Height × 0.5 × Door Weight
- K-Type (Light Duty):
121~173 lbs-in (140~200 kg-cm)/pair
- M-Type (Medium Duty):
173~216 lbs-in (200~250 kg-cm)/pair
- H-Type (Heavy Duty):
216~260 lbs-in (250~300 kg-cm)/pair



Overlay Use

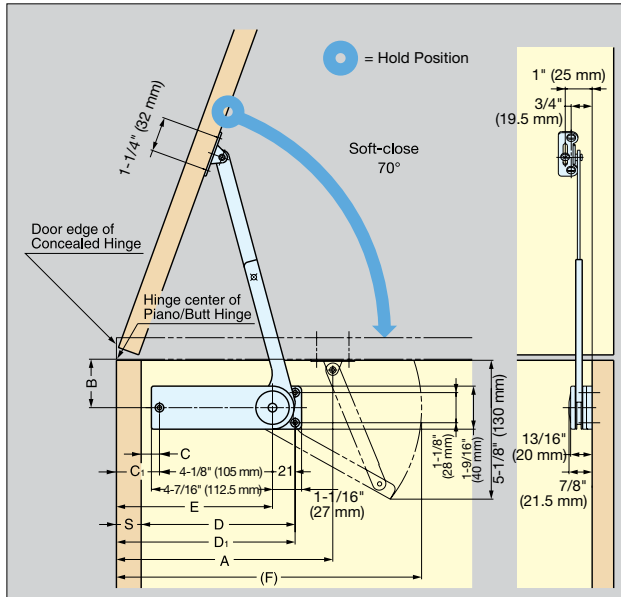

Inset Use

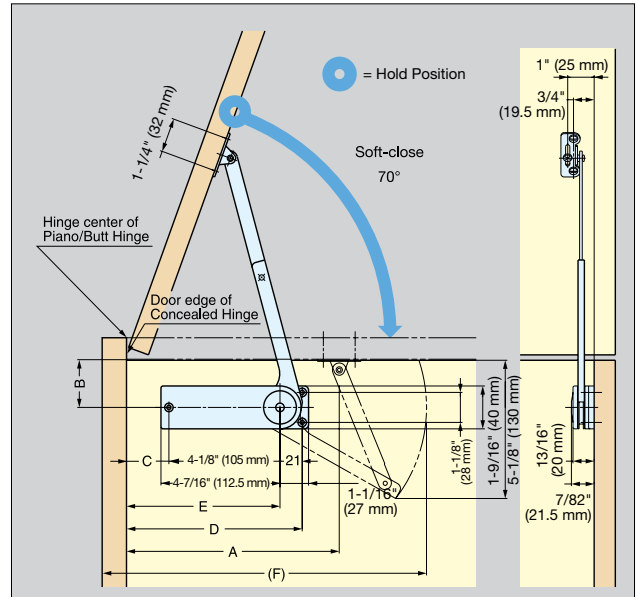

Overlay Use

Hinge Type	A	B	C	D	C ₁	D ₁	E	F
Concealed Hinge	(198.5)	(45)	(42-S)	(168-S)	-	-	(145)	(283.5)
Piano/Butt Hinge	-	-	-	-	(41)	(167)	(142.5)	(281)

S=Overlay coverage in case of concealed hinge. () units in mm.

Inset Use

Hinge Type	A	B	C	D	E	F
Concealed Hinge	(203)	(45)	(46)	(172)	(151)	(286)
Piano/Butt Hinge	(190)		(33)	(159)	(138)	(273)

() units in mm.

Item No.		Type	Torque (kg-cm/pair)	Weight (g)	Box (pcs)	Carton (pcs)
Left	Right					
HDS-20KL	HDS-20KR	Light Duty	121~173 lbs-in (140~200 kg-cm)	280	40	200
HDS-20ML	HDS-20MR	Medium Duty	173~216 lbs-in (200~250 kg-cm)	290		
HDS-20HL	HDS-20HR	Heavy Duty	216~260 lbs-in (250~300 kg-cm)	300		

Material	Finish/Color
Steel	Nickel
Plastic	Black, White