

WIRE PULL

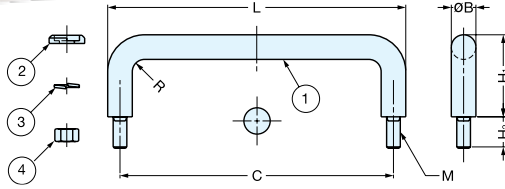

H-42-B



No.	Part Name	Material	Finish
①	Handle	304 Stainless Steel	Mirror
②	Washer		Polished
③	Spring Washer		Plain
④	Nut		

Item No.	L	H ₁	H ₂	B	C	R	M	Weight (g)	Box (pcs)	Carton (pcs)
H-42-B-9	1-13/16" (46 mm)	7/8"	11/32" (8.5 mm)	1/4" (6 mm)	1-9/16" (40 mm)	-	M4 × 0.70	15	50	500
H-42-B-8	2-5/8" (66 mm)	(22 mm)	9/32" (7 mm)		2-3/8" (60 mm)	1/8" (3 mm)		20	100	
H-42-B-14	3-3/8" (86 mm)	1-3/16" (30 mm)	3/8" (10 mm)	7/16" (11 mm)	3-1/8" (80 mm)	1/8" (3.5 mm)	M5 × 0.80	27	50	250
H-42-B-1	2-15/16" (75 mm)		1/4" (7 mm)		2-11/16" (68 mm)			3/16" (4.5 mm)		
H-42-B-2	4-5/16" (109 mm)		3/8" (9 mm)		3-15/16" (100 mm)	3/16" (4.5 mm)	80			
H-42-B-3	4-3/4" (120 mm)		1-9/16" (40 mm)		4-5/16" (110 mm)	3/16" (5 mm)	M6 × 1.00	120		
H-42-B-4	5-1/8" (130 mm)	3/8" (10 mm)	4-3/4" (120 mm)	125						
H-42-B-15	6-3/8" (162 mm)	2" (50 mm)	13/16" (20 mm)	1/2" (12 mm)	5-15/16" (150 mm)	1/4" (6 mm)	M8 × 1.25	235	30	60
H-42-B-5	7-7/8" (200 mm)				7-3/8" (188 mm)			270		
H-42-B-6	9-13/16" (250 mm)				9-3/8" (238 mm)			320		
H-42-B-7	11-13/16" (300 mm)				11-5/16" (288 mm)			365	20	40

WIRE PULL



H-42-C

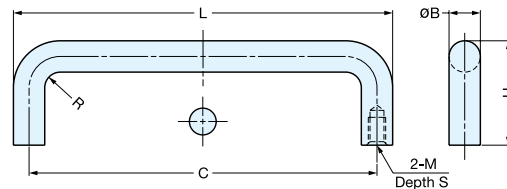

Material	Finish
304 Stainless Steel	Mirror

Item No.	L	H	B	C	S	M	R	Weight (g)	Box (pcs)	Carton (pcs)
H-42-C-8	2-5/8" (66 mm)	7/8" (22 mm)	1/4" (6 mm)	2-3/8" (60 mm)	9/32" (7 mm)	M4 × 0.70	1/8" (3 mm)	18	100	500
H-42-C-14	3-3/8" (86 mm)	1-3/16" (30 mm)		3-1/8" (80 mm)	5/16" (8 mm)		M5 × 0.80	3/16" (4.5 mm)		
H-42-C-1	2-15/16" (75 mm)		9/32" (7 mm)	2-11/16" (68 mm)		M6 × 1.00			3/16" (5 mm)	30
H-42-C-2	4-5/16" (109 mm)		3/8" (9 mm)	3-15/16" (100 mm)	65					
H-42-C-3	4-3/4" (120 mm)		1-9/16" (40 mm)	4-5/16" (110 mm)	100					
H-42-C-4	5-1/8" (130 mm)	2" (50 mm)	1/2" (12 mm)	4-3/4" (120 mm)	3/8" (10 mm)	M8 × 1.25	1/4" (6 mm)	105	30	60
H-42-C-15	6-3/8" (162 mm)			5-15/16" (150 mm)				185		
H-42-C-5	7-7/8" (200 mm)			7-3/8" (188 mm)				220		
H-42-C-6	9-13/16" (250 mm)			9-3/8" (238 mm)				265		
H-42-C-7	11-13/16" (300 mm)	11-5/16" (288 mm)	300	20	40					

WIRE PULL



H-42-F14

• Ideal for high corrosive environments.

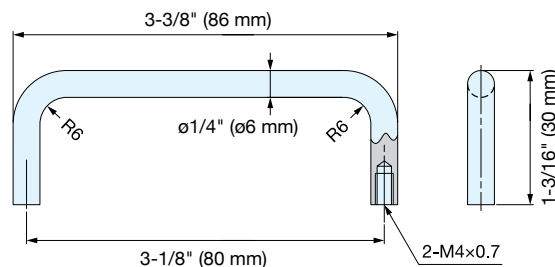

Item No.	Weight (g)	Box (pcs)	Carton (pcs)	Material	Finish
H-42-F14	25	50	250	316 Stainless Steel	Mirror