

GLASS HINGE (INSET)

GS-GH5



Chrome (CR)

24K Gold Plated (GP)



Black (BL)

Parts Included

- Hinge for inset glass door for glass showcase.
- Can be used together with glass bracket GS-GB5 (below) and lock GS-GL5.
- Temporary holding feature allows for easy installation of the door by one person.
- Sideways adjustment 1/8" (±2.5 mm) possible after installation of the door.
- Gap below door is adjustable from 1/8" (3 mm) to 3/16" (5 mm) with washers.
- Sold in pairs.

Installation drawings

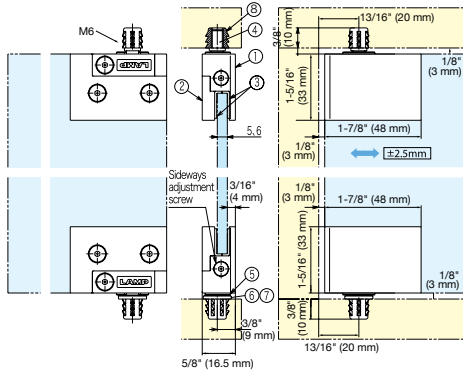
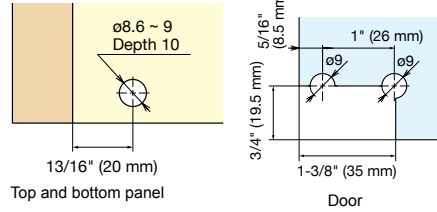

No.	Part Name	Material	Finish
①	Body	Zinc Alloy	Chrome, Black, 24K Gold Plated
②	Back Plate		
③	Gasket	Chloroprene Rubber	Black
④	Axis	Stainless Steel	Plain
⑤	Plastic Washer	Polyamide	Black
⑥	Washer (t: 1.5)	304 Stainless Steel	Plain
⑦	Washer (t: 3.5)	Brass	Nickel
⑧	Insert	Zinc Alloy	-

Item Name	Door Width	Door Height	Door Weight	Glass Thickness	Finish
GS-GH5-CR	Max. 17-3/4" (450 mm)	Max. 23-5/8" (600 mm)	11 lbs/2 pcs (5 kg/2 pcs)	Min. 3/16, 1/4" (5, 6 mm)	Chrome
GS-GH5-GP					Gold Plated
GS-GH5-BL					Black

GLASS BRACKET

GS-GB5



- Can be used together with glass hinge GS-GH5 (above) and lock GS-GL5.

Installation drawings

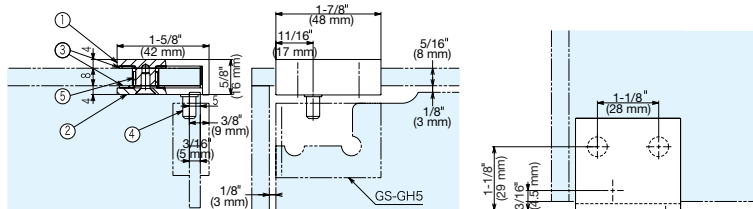
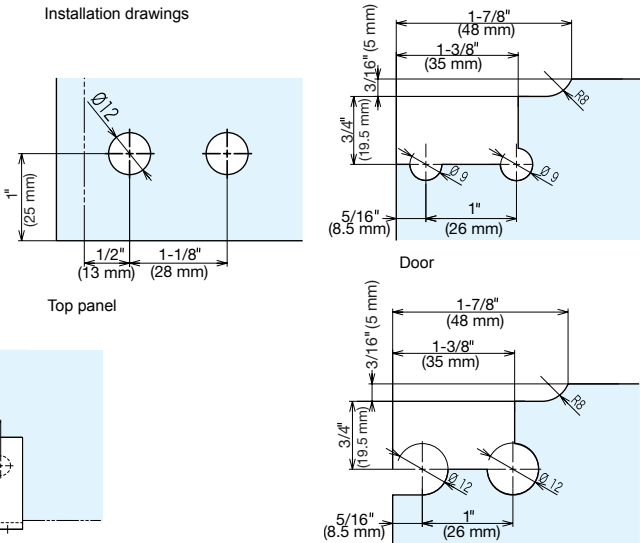

Drawing shows left side installation

Item Name	Type	Glass Thickness	Finish
GS-GB5-R-CR	Right	15/16" (8 mm)	Chrome
GS-GB5-L-CR	Left		
GS-GB5-R-GP	Right		24K Gold Plated
GS-GB5-L-GP	Left		
GS-GB5-R-BL	Right		Black
GS-GB5-L-BL	Left		

No.	Part Name	Material	Finish
①	Body	Zinc Alloy	Chrome, Black, 24K Gold Plated
②	Back Plate	304 Stainless Steel	
③	Washer	Chloroprene Rubber	Black
④	Axis	Stainless Steel	Plain
⑤	Tube	Polyvinyl Chloride	Clear