

HOOK

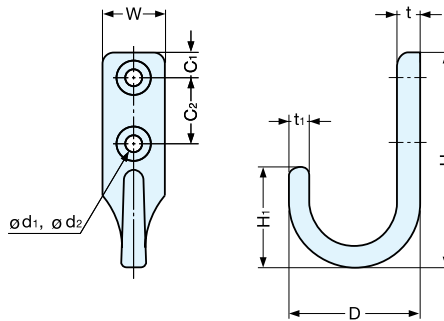

EL-25, 30



Material	Finish
304 Stainless Steel	Mirror

Item No.	D	H	H ₁	t	t ₁	W	C ₁	C ₂	d ₁	d ₂	Load Capacity	Weight (g)	Box (pcs)	Carton (pcs)	Screw
EL-25	1" (26)	1-9/16" (40)	3/4" (19)	1/4" (5.5)	3/16" (4)	1/2" (12)	3/16" (5)	1/2" (12)	1/8" (3)	1/4" (6)	44 lbs (20 kg)	19	30	300	2.7 × 16
EL-30	1-1/4" (32)	2-1/8" (54.5)	1" (25)	1/4" (6.0)	3/16" (5)	9/16" (15)	1/4" (6)	5/8" (16)	3/16" (4)	5/16" (8)					

(units in mm)

HOOK



EP-25, 40

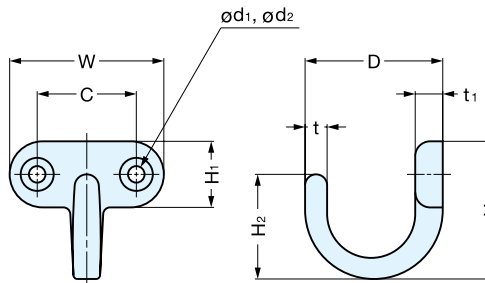

Material	Finish
304 Stainless Steel	Mirror

Item No.	D	W	H	H ₁	H ₂	t	t ₁	C	d ₁	d ₂	Load Capacity	Weight (g)	Box (pcs)	Carton (pcs)	Screw
EP-25	1" (25)	1-1/8" (28)	1" (25)	1/2" (12)	3/4" (19)	3/16" (4)	3/16" (5)	11/16" (18)	1/8" (3)	1/4" (6)	44 lbs (20 kg)	16	30	300	2.7 × 16
EP-40	1-1/4" (32)	1-7/16" (36)	1-5/16" (33)	5/8" (16)	1" (25)	3/16" (5)	1/4" (6)	15/16" (23)	3/16" (4)	5/16" (8)					

(units in mm)

HOOK



FC-50, 65

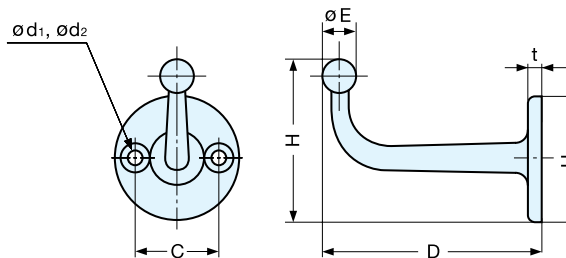

Material	Finish
304 Stainless Steel	Mirror

Item No.	D	H	H ₁	t	C	d ₁	d ₂	E	Load Capacity	Weight (g)	Box (pcs)	Carton (pcs)	Screw
FC-50	1-7/8" (47)	1-7/16" (37)	1-1/8" (28)	1/8" (3)	3/4" (18.5)	1/8" (3.3)	1/4" (6.5)	1/4" (6.5)	22 lbs (10 kg)	25.0	40	480	3.1 × 16
FC-65	2-9/16" (65)	1-3/4" (44)	1-3/8" (35)	3/16" (4)	7/8" (22.5)	3/16" (4.2)	5/16" (8.0)	5/16" (8.0)	26 lbs (12 kg)	54.5	20	240	3.8 × 20

(units in mm)