

DOOR HANDLE

STAINLESS
304
STEEL

DSI-4400

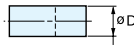
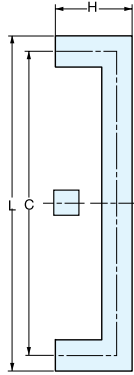

- For use with DSI mounting kits (sold separately, See P.10).
- Please specify Interior/Exterior type when ordering:
 - Posts for Exterior handles are threaded to accept screws.
 - Posts for Interior handles have set screws for DSI mounting kits.
- Similar style to KPH series cabinet handles. (P.45)

Material	Finish
304 Stainless Steel	Satin

Item No.		D	L	C	H	Weight		Box (pcs)	Carton (pcs)
Interior	Exterior					Interior	Exterior		
DSI-4400-15-15I	DSI-4400-15-15E	9/16" (15)	6-1/2" (165)	5-15/16" (150)	2-3/16" (55)	0.9 lbs (0.41 kg)	0.9 lbs (0.42 mm)	1	10
DSI-4400-15-20I	DSI-4400-15-20E		8-7/16" (215)	7-7/8" (200)		1.1 lbs (0.48 kg)	1.1 lbs (0.50 mm)		
DSI-4400-15-30I	DSI-4400-15-30E		12-3/8" (315)	11-13/16" (300)		1.5 lbs (0.67 kg)	1.5 lbs (0.68 mm)		
DSI-4400-20-20I	DSI-4400-20-20E	13/16" (20)	8-11/16" (220)	7-7/8" (200)	2-9/16" (65)	0.4 lbs (0.18 kg)	0.5 lbs (0.23 mm)		
DSI-4400-20-25I	DSI-4400-20-25E		10-5/8" (270)	9-13/16" (250)		0.5 lbs (0.22 kg)	0.5 lbs (0.24 mm)		
DSI-4400-20-30I	DSI-4400-20-30E		12-5/8" (320)	11-13/16" (300)		0.6 lbs (0.26 kg)	0.6 lbs (0.26 mm)		
DSI-4400-30-25I	DSI-4400-30-25E	1-3/16" (30)	11" (280)	9-13/16" (250)	3-9/16" (90)	1.2 lbs (0.56 kg)	1.3 lbs (0.59 mm)		
DSI-4400-30-30I	DSI-4400-30-30E		13" (330)	11-13/16" (300)		1.1 lbs (0.51 kg)	1.1 lbs (0.50 mm)		
DSI-4400-30-35I	DSI-4400-30-35E		14-15/16" (380)	13-3/4" (350)		1.6 lbs (0.71 kg)	1.3 lbs (0.57 mm)		
DSI-4400-30-60I	DSI-4400-30-60E		24-13/16" (630)	23-5/8" (600)		2.4 lbs (1.09 kg)	2.4 lbs (1.09 mm)		

(Units in mm)

DOOR HANDLE

STAINLESS
304
STEEL

DSI-1630

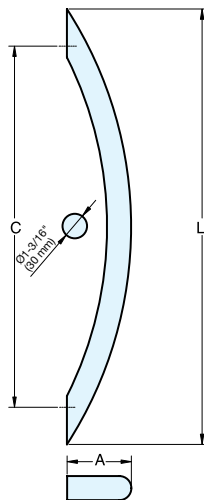

- For use with DSI mounting kits (sold separately, See P.10).
- Please specify Interior/Exterior type when ordering:
 - Posts for Exterior handles are threaded to accept screws.
 - Posts for Interior handles have set screws for DSI mounting kits.
- Similar style to 30 series cabinet handles. (P.38)



Material	Finish
304 Stainless Steel	Satin

Item No.		L	C	A	Weight (kg)	Box (pcs)	Carton (pcs)
Interior	Exterior						
DSI-1630-30-25I	DSI-1630-30-25E	12-3/8" (314)	9-13/16" (250)	2-5/8" (66)	1.8 lbs (0.8 kg)	1	10
DSI-1630-30-35I	DSI-1630-30-35E	16-15/16" (430)	13-3/4" (350)	2-15/16" (74)	2.7 lbs (1.2 kg)		
DSI-1630-30-45I	DSI-1630-30-45E	21-5/16" (542)	17-3/4" (450)	3-1/8" (80)	3.3 lbs (1.5 kg)		
DSI-1630-30-60I	DSI-1630-30-60E	28-3/8" (721)	23-5/8" (600)	3-1/8" (79)	4.0 lbs (1.8 kg)		

(Units in mm)