

# MINI MAGNETIC CATCH (SNAP-IN TYPE)

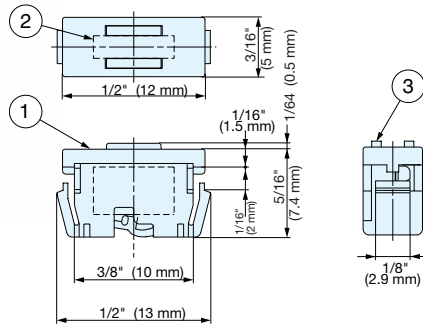

## CM-2B



- Snap-in installation.
- Small size for light weight applications.

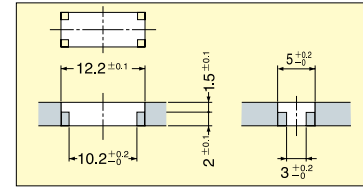

Cut Out Dimensions in mm.

Item No.	Magnetic Force	Weight (g)	Box (pcs)
CM-2B	0.9 lbs (0.4 kg)	1	200

No.	Part Name	Material	Finish/Color
①	Housing	Polyamide	Black
②	Magnet	Ferrite	-
③	Yoke	Steel	Black Zinc

# MAGNETIC CATCH



## MC-111, 112, 113

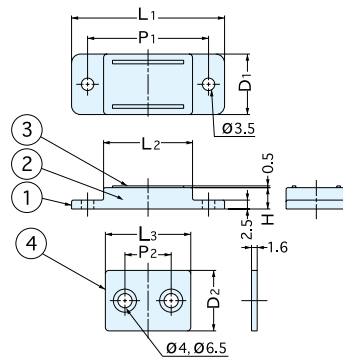

- Low profile design is ideal for tight spaces.

Item No.		Magnetic Force	L <sub>1</sub>	L <sub>2</sub>	L <sub>3</sub>	D <sub>1</sub>	D <sub>2</sub>	P <sub>1</sub>	P <sub>2</sub>	H	Wt (g)	Box (pcs)	Carton (pcs)
Black	Ivory												
MC-111/BLK	MC-111/IVY	11 lbs (5 kg)	2-1/2" (64)	1-13/16" (46)	1-3/4" (45)	31/32" (24.5)	15/16" (24)	2-3/16" (55)	1-3/16" (30)	7.0	48	50	500
MC-112/BLK	MC-112/IVY	6.6 lbs (3 kg)	2-1/16" (53)	1-3/8" (35)	1-5/16" (34)	59/64" (23.5)	29/32" (23)	1-3/4" (44)	13/16" (20)	6.2	32	100	1000
MC-113/BLK	-	2.2 lbs (1 kg)	1-11/16" (43)	1" (25)	15/16" (24)	43/64" (17.0)	43/64" (17)	1-5/16" (34)	1/2" (13)	6.0	14	100	1000

No.	Part Name	Material	Finish/Color
①	Housing	ABS	Black (BLK), Ivory (IVY)
②	Magnet	Ferrite	-
③	Yoke	Steel	Yellow Zinc Chromate
④	Counterplate		Nickel

# GLASS MAGNETIC CATCH



## XL-GC09-CR

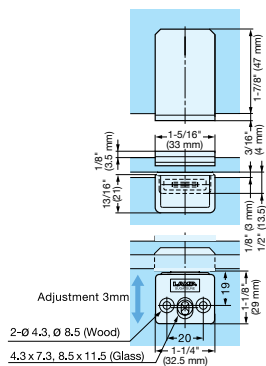
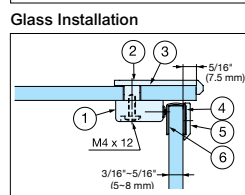
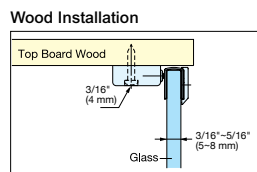

### Cut Out Dimensions

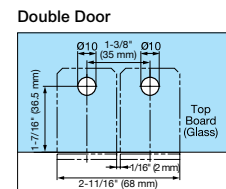
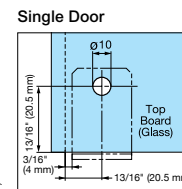

No.	Part Name	Material	Finish/Color
①	Housing	Zinc Alloy	Chrome
②	Plate		
③	Spacer	Rubber	Black
④	Counterplate	Steel	Chrome
⑤	Face Plate	Zinc Alloy	
⑥	Pad	Rubber	Black

Item No.	Magnetic Force (kg)	Glass Thickness	Weight (g)	Box (pcs)	Carton (pcs)
XL-GC09-CR	3.3lbs (1.5 kg)	3/16"~5/16" (5~8 mm)	110	1	24