

TENSION CATCH

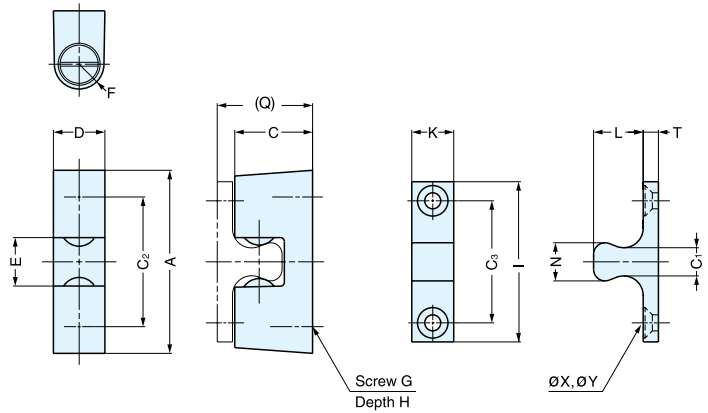

BCU

• Tension force is not adjustable.

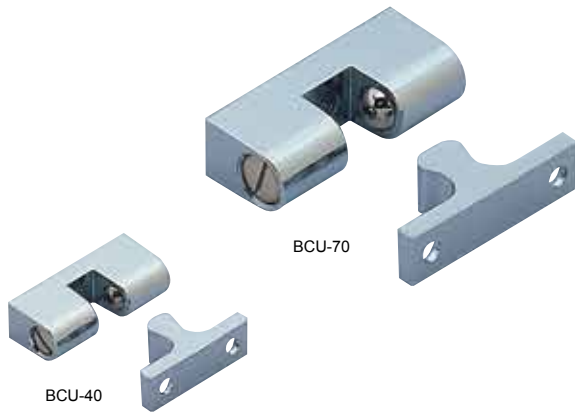

Item No.	A	C	C ₁	C ₂	C ₃	D	E	F	G	H	I	K	L	N	(Q)	T	X	Y
BCU-40	1-1/8" (3.9 mm)	1/2" (12.5)	1/8" (3.0)	13/16" (20)	5/8" (16)	5/16" (8.3 mm)	1/4" (6.5)	R4.0	M3	3/16" (5)	15/16" (24 mm)	5/16" (8)	3/8" (9)	3/16" (5)	5/8" (15.7)	1/8" (3)	1/8" (3.2)	1/4" (6.2)
BCU-70	1-7/8" (48 mm)	13/16" (20.5)	5/16" (7.3)	1-5/16" (34)	1-1/4" (32)	1/2" (13.5 mm)	1/2" (12.7)	R6.5	M5	1/4" (6)	1-42/64" (42 mm)	7/16" (11)	1/2" (13)	3/8" (10)	1" (24.9)	3/16" (4)	3/16" (4.2)	5/16" (8.2)

Item No.	Push in Force	Pulling Force	Weight (g)	Box (pcs)	Carton (pcs)
BCU-40	7.9 lbs (3.6 kg)	5.3 lbs (2.4 kg)	18	100	400
BCU-70	9.0 lbs (4.1 kg)	8.6 lbs (3.9 kg)	75	50	200

Material	Finish
Zinc Alloy	Chrome

