

# ALUMINUM MINI GUIDE

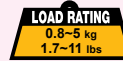

# ARL2-16



- Thin profile for various applications.
- Light-weight aluminum body.
- Sold by each.

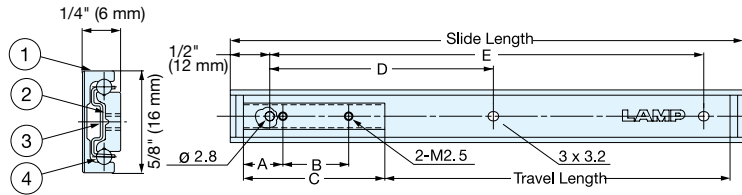

No.	Part Name	Material	Finish
①	Outer Rail	Aluminum	Anodized
②	Inner Rail		
③	Retainer	Steel	Plain
④	Balls		-

Item No.	Slide Length	Travel Length	A	B	C	D	E	Load Rating /pair		Weight (g)	Box (pcs)
ARL2-16-70	2-3/4" (70 mm)	1-3/16" (30 mm)	3/16" (5 mm)	(18)	(28)	-	(46)	4.4 lbs (2 kg)	1.7 lbs (0.8 kg)	13.5	100
ARL2-16-100	3-15/16" (100 mm)	2-1/16" (52 mm)	3/8" (10 mm)	(19)	(39)	(38)	(76)	11.0 lbs (5 kg)	4.0 lbs (1.8 kg)	18.0	
ARL2-16-150	5-15/16" (150 mm)	3-7/8" (99 mm)								(63)	

( ) units in mm.

# ALUMINUM MINI SLIDE (2-WAY)

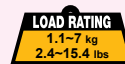

# ARW2-16



- Two-way travel.
- Thin profile for various applications.
- Light-weight aluminum body.
- Designed without positive stop for ease of assembly.
- Please add secondary stopper if necessary.
- Sold by each.

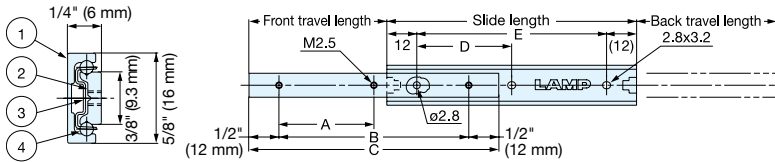

No.	Part Name	Material	Finish
①	Outer Rail	Aluminum	Anodized
②	Inner Rail		
③	Retainer	Steel	Plain
④	Balls		-

Item No.	Slide Length	Front Travel Length	Back Travel Length	A	B	C	D	E	Load Rating /pair		Weight (g)	Box (pcs)
ARW2-16-70	2-3/4" (70 mm)	1-1/4" (32 mm)	1-1/4" (32 mm)	-	(46)	(70)	-	(46)	6.6 lbs (3 kg)	2.4 lbs (1.1 kg)	15.5	100
ARW2-16-100	3-15/16" (100 mm)	1-9/16" (40 mm)	1-9/16" (40 mm)	(38)	(76)	(100)	(38)	(76)	11 lbs (5 kg)	4.4 lbs (2 kg)	21.5	
ARW2-16-150	5-15/16" (150 mm)	3-1/8" (79 mm)	3-1/8" (79 mm)	(63)	(129)	(150)	(63)	(126)	15.4 lbs (7 kg)	6.8 lbs (3.1 kg)	29.5	

( ) units in mm.

# ALUMINUM MINI SLIDE



# AR3-16



- Full extension.
- Positive stop.
- Thin profile for various applications.
- Light-weight aluminum body.
- Sold by each.

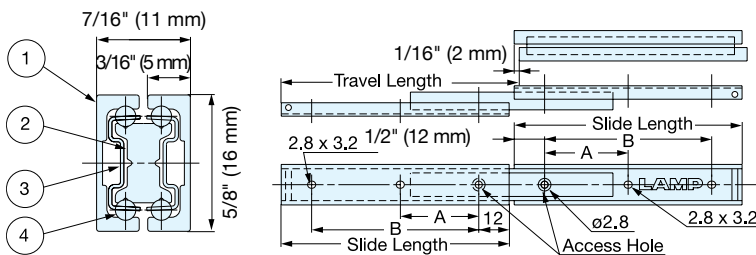

No.	Part Name	Material	Finish
①	Outer Rail	Aluminum	Anodized
②	Inner Rail		
③	Retainer	Steel	Plain
④	Balls		-

Item No.	Slide Length	Travel Length	A	B	Load Rating /pair	Weight (g)	Box (pcs)
AR3-16-100	3-15/16" (100 mm)	4-5/8" (117 mm)	1-1/2" (38 mm)	3" (76 mm)	6.6 lbs (3 kg)	36.0	
AR3-16-150	5-15/16" (150 mm)	5-15/16" (151 mm)	2-1/2" (63 mm)	4-15/16" (126 mm)	8.8 lbs (4 kg)	55.0	